

CERTIFIED LAND CORNER RESTORATION

Index No. **M-25**

State of Wisconsin }
 County of Uneda } ss.

I Phillip T. Hansen, do hereby certify that on the 3rd day of August, 1976, I found evidence of the S 1/16 corner of section 13 and 18 Township 37 North, Range 11 & 12 East, Fourth Principal Meridian, as described hereon; and that from this evidence I established a new monument and accessories as described hereon to perpetuate the original location of this corner.

Resident witnesses:
Glen Barker
Jim Claflin
Herb Wagoner

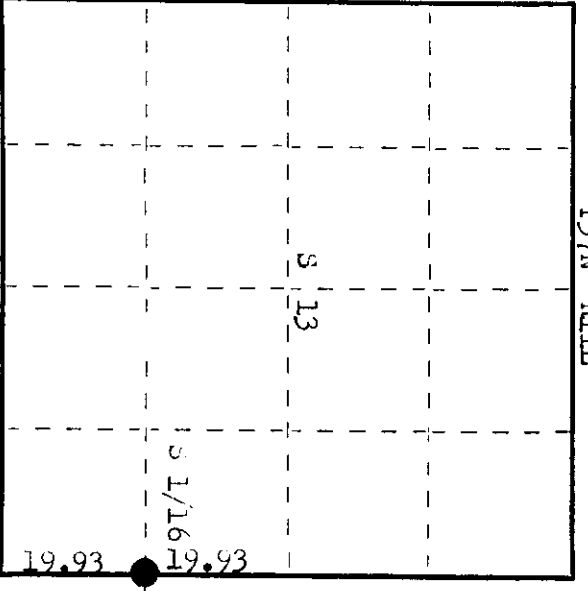
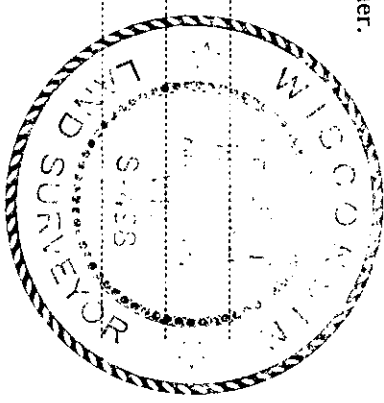

○ = Corner monument restored.

History of original corner establishment:

Original Corner established by V. W. Payne, Uneda County Surveyor, in 1955. Van Random line North from SW section Corner 39.86 chains to close out 15 links west of recovered 1/4 corner identified by stump of original BT's. Set 3 1/16 corner at 19.93 chains, equidistant 6 1/2 links east of random line. Marked BT's - rock 1m 0" N 82° E 30 links, sugar 20" N 15° E 29 links. Corner recovered by H. C. Lawrence, registered land surveyor, while cruising this area.

Description of corner evidence found:
 Recovered mine's 0" squared and scribed cedar post, scribed 1/80 - 1/80, broken off at ground level. Found old joint, still intact.
 No evidence of BT's recovered.

Description of monument and accessories I established to perpetuate the original location of this corner.
 Replaced joint of cedar post with 1 1/2" SW iron pipe with grass cap, stamped.
 Monument projects 24" above ground.
BT's - sugar 8" S 58° W 47 links, scribed 1/16 BT.
sugar 7" S 25° E 21.7 links, scribed 1/16 BT.
 Placed rock cairn around base of monument.
 Monument and BT's painted blue.

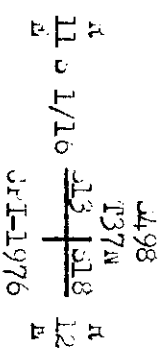

Dated at Rhineland, Wis., this 30th day of August, 1976.

Signature Phillip T. Hansen Title Registered Land Surveyor Registration No. 5498
 (County Surveyor, Registered Land Surveyor, or other duly authorized official)

Office of Register of Deeds, County of Uneda
 Instrument was filed in this office for record on the 22nd day of September, 1976
 at 1:00 o'clock P. M.

Dorcas Veninger Fischer
 (Register of Deeds)

By: _____ Deputy

3711131000