

CERTIFIED LAND CORNER RESTORATION

Index No. **K-25**

State of Wisconsin

County of Oneida } ss.

I Philip T. Hansen, do hereby certify that on the 2nd day of August, 1976, I found evidence of the N 1/16 corner of section 13 & 18 Township 27, North, Range 11 & 12, Fourth Principal Meridian, as described hereon; and that from this evidence I established a new monument and accessories as described hereon to perpetuate the original location of this corner.

Resident witnesses:

Glen Barker

Jim Marlin

Herb Anderson

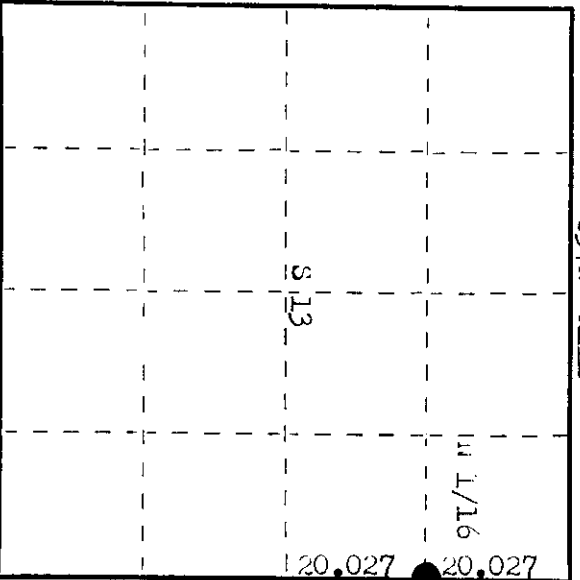
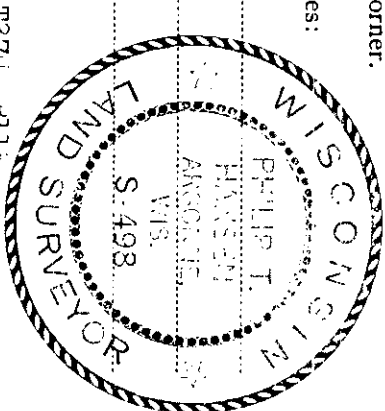

○ = Corner monument restored.

CERTIFIED LAND CORNER RESTORATION

History of original corner establishment:

Corner established by V.L. Thine, Oneida County Surveyor, in 1935. ran random line north from last 1/4 corner 40.052 chains var. 2° 12' E, fell 29 1/2 links west of section corner. set N 1/16 at 20.027 chains 14-3/4 links east. Corrected bearing 1° 50' marked 51's - Hemlock 14" at 78° & 24 1/2 links, Cedar 4" at 70° & 20 1/2 links.

Corner recovered by H.C. Lawrence, registered land surveyor. set new post.

Description of corner evidence found:

recovered 0" cedar post, squared and scribed 213, N 1/16, 218, N 1/16 in poor condition. recovered 217's - Hemlock 20" at 11° & 25.8 links. Top scribed N 1/16 215. Bottom grown over.

Description of monument and accessories I established to perpetuate the original location of this corner. replaced 0" cedar post with 1 1/2" iron pipe with 2" brass cap staked.

monument projects 24" above ground. 217 - sugar 8" at 15° & 35.1 links, scribed 1/16 217. monument and 217's painted blue.

2498
E37M
N 1/16 11 13 18 12
CPI-1976 B

Dated at Phineland, Wis. this 31st day of August, 1976.

Signature Philip T. Hansen Title Registered Land Surveyor Registration No. 498
(County Surveyor, Registered Land Surveyor, or other duly authorized official)

Office of Register of Deeds, County of Oneida. I hereby certify that the within instrument was filed in this office for record on the 28th day of September, 1976 at 10 o'clock P. M.

Dorcas Verage Kuehn
(Register of Deeds)

By _____ Deputy