

CERTIFIED LAND CORNER RESTORATION

Index No. **K-22**

State of Wisconsin }  
 County of Oneida } ss.

I Philip W. Hansen, do hereby certify that on the 12th day of August, 1976, I found evidence of the NW 1/16 corner of section 13 Township 37 North, Range 11 East, Fourth Principal Meridian, as described hereon; and that from this evidence I established a new monument and accessories as described hereon to perpetuate the original location of this corner.

Resident witnesses:

Glen Barker  
 Jim Claflin  
 Herb Sawyer

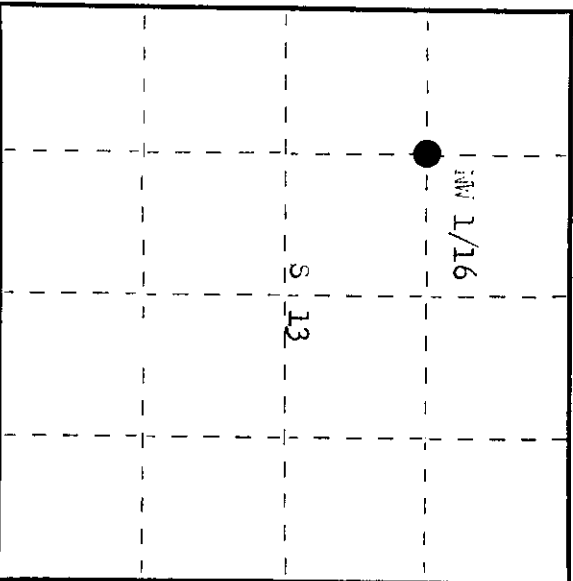
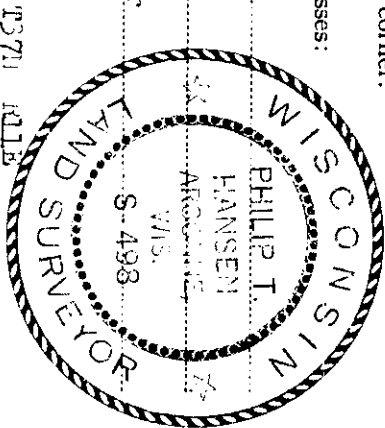

History of original corner establishment:

Corner established by J.D. Jelenky, Jagen Lumber and Cedar Company surveyor, in 1916. Set cedar post and marked it - Cedar 12" x 8" x 11 links.

Description of corner evidence found:

Recovered old post, about 4" of base and mark. Found remains of old post, which showed nails to cedar. Found scribbles 1/16 on piece of old post. Recovered OP - Cedar 12" x 8" x 11 links, section 1/16 BT.

Description of monument and accessories I established to perpetuate the original location of this corner.

Replaced joint of old cedar post with 1" OD iron pipe with 2" brass cap stamped: Placed large rock cairn around base of pipe. NBT - Cedar 7" x 30" x 15.4 links, scribed 1/16 BT. Cedar 8" x 78" x 15.3 links, scribed 1/16 BT. Monument and OP's painted blue.

CP1-1976

Dated at Oneida, Wis., this 2nd day of September, 1976.

Signature *Philip W. Hansen* Title Registered Land Surveyor Registration No. S-498  
 (County Surveyor, Registered Land Surveyor, or other duly authorized official)

Office of Register of Deeds, County of Oneida  
 Instrument was filed in this office for record on the 29th day of September, 1976 at 2:30 o'clock P.M.

*Debra LePage Fisher*  
 (Register of Deeds)

By \_\_\_\_\_ Deputy

371113 3030