

CERTIFIED LAND CORNER RESTORATION

Index No. N-8

State of Wisconsin

County of Oneida } ss.

I, Phillip T. Hansen, do hereby certify that on the 13th day of June, 1977, I found evidence of the E 1/16 corner of Sec. 17 & 20 Township 37, North, Range 11 East, Fourth Principal Meridian, as described hereon; and that from this evidence I established a new monument and accessories as described hereon to perpetuate the original location of this corner.

Resident witnesses:

Glen Barker

Jim Claflin

Herb Wagoner

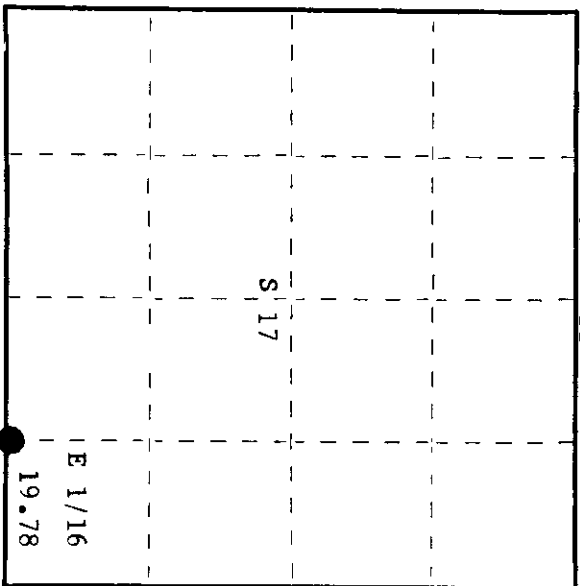
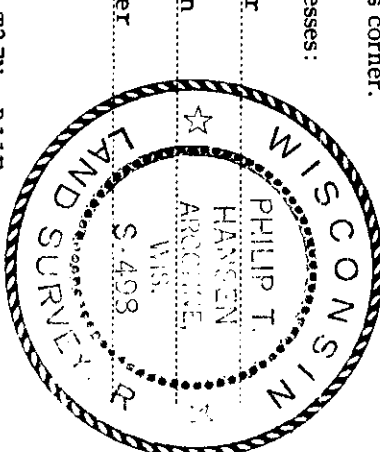

○ = Corner monument restored.

History of original corner establishment:

Corner recovered by H.C. Lawrence, Registered Land Surveyor, in 1948. Ran a random line west from Section Corner 16, 17, 20, 21 a distance of 19.78 chains to close out 77 links north of an old squared 1/16 corner. Set a new post. No mention of any BTs marked. Corner sets in alders near a creek.

Description of corner evidence found:

Recovered point of old post, the top half of which was recovered under marsh grass. Post scribed E 1/16 S17, E 1/16 S20. Corner sets in old fence line 66 links east of Ginty Creek. There is also a 3" squared cedar post which bears S38°E, 14.7 links from Lawrence's post.

Description of monument and accessories I established to perpetuate the original location of this corner.

Replaced point of old post (H.C. Lawrence's) with 1 1/2" iron pipe with 2" brass cap, stamped: Monument projects 18" above ground. Marked NBTs - White Spruce 16" N55°E, 25.8 links, scribed 1/16 Spruce 5" N84°E, 58.2 links, scribed 1/16

S498
T37N R11E
E 1/16 S17
S120
CPI-1977

Dated at Rhinelander, Wis., this 21st day of June, 1977.

Signature: Phillip T. Hansen Title: Registered Land Surveyor Registration No. S-498
(County Surveyor, Registered Land Surveyor, or other duly authorized official)

Office of Register of Deeds, County of Oneida, I hereby certify that the within instrument was filed in this office for record on the 30th day of June, 1977 at 9:20 o'clock A. M.

Debra Veroye Kuehl
(Register of Deeds)

By Joseph M. Borman Deputy