

CERTIFIED LAND CORNER RESTORATION

Index No. 1-6

State of Wisconsin }
County of Oneida } ss.

I Phillip T. Hansen, do hereby certify that on the 13th day of June, 1977, I found evidence of the WC 1/16 corner of Section 17 Township 37, North, Range 11 East, Fourth Principal Meridian, as described hereon; and that from this evidence I established a new monument and accessories as described hereon to perpetuate the original location of this corner.

Resident witnesses:

- Glen Barker
- Jim Clafin
- Herb Wagoner

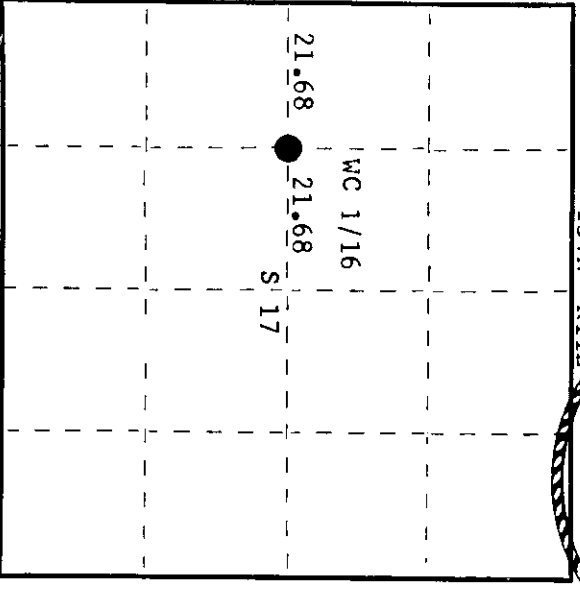
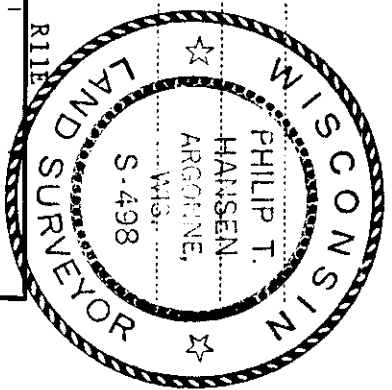

○ = Corner monument restored.

History of original corner establishment:

Corner established by H.C. Lawrence, Registered Land Surveyor, in 1948. From previously established 1/4 corners, ran N-S and E-W 1/4 lines to establish C 1/4 corner at 43.36 chains east of W 1/4 corner. Set wood post at 21.68 chains intermediate for WC 1/16 corner.
Marked NBTs - Sugar 5" N54°E, 27 links
Basswood 6" S8°E, 7 links.

Description of corner evidence found:

Recovered 5" tamarack post, squared and scribed WC 1/16 S17, WC 1/16 S17 in very poor condition.
Recovered OBTs - Sugar 5" (8") N54°E, 27 links, scribing grown over.
Basswood 6" (10") S8°E, 7 links, scribing grown over.

Description of monument and accessories I established to perpetuate the original location of this corner.

Replaced tamarack post with 1 1/2" iron pipe with 2" brass cap, stamped: S498
Monument projects 24" above ground. T37N R11E
Marked NBT - Sugar 8" N64°W, 22.8 links, scribed 1/16 BT. WC 1/16 S17
CPI-1977

Dated at Rhineland, Wis., this 21st day of June, 1977.

Signature Phillip T. Hansen Title Registered Land Surveyor Registration No. S-498
(County Surveyor, Registered Land Surveyor, or other duly authorized official)
Office of Register of Deeds, County of Oneida
Instrument was filed in this office for record on the 30th day of June, 1977
at 9:20 o'clock A. M. I hereby certify that the within

By Dawn Savage Kuehn (Register of Deeds)
Joseph M. Boorn Deputy

3711172030