

CERTIFIED LAND CORNER RESTORATION

Index No. **R-2**

State of Wisconsin

County of Oneida } ss.

I, Phillip T. Hansen, do hereby certify that on the 3rd day of August, 1977, I found evidence of the W 1/16 corner of Section 19 & 30 Township 37, North, Range 11 East, Fourth Principal Meridian,

as described hereon; and that from this evidence I established a new monument and accessories as described hereon to perpetuate the original location of this corner.

Resident witnesses:

Jim Claflin

Herb Wagner

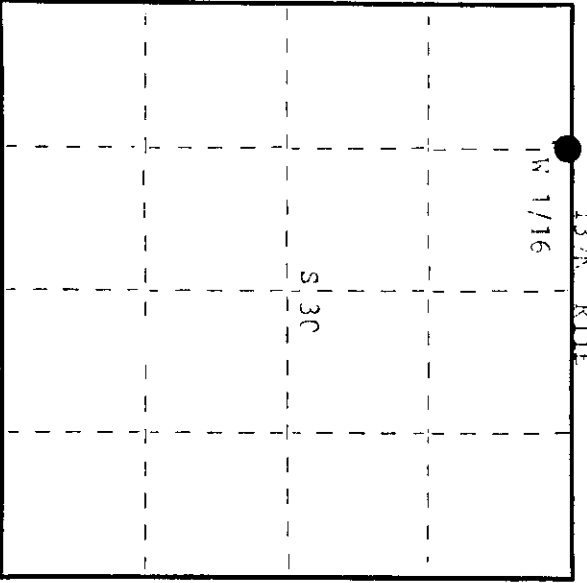
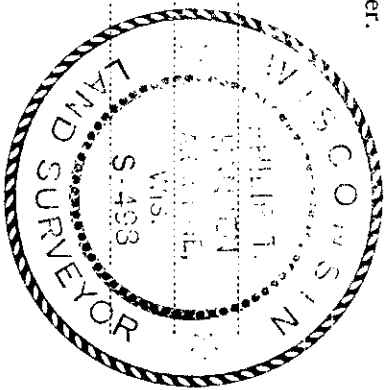

○ = Corner monument restored.

CERTIFIED LAND CORNER RESTORATION

History of original corner establishment:

Corner established by H.C. Lawrence, Registered Land Surveyor, in 1949. Ran random line west from Section Corner 19, 20, 20, 30 95.50 chains to close out 2.95 chains south of Section Corner.

Set W. 1/16 at 64.02 chains and 192 links north. Set 4" tamarack post. No suitable trees for PTs. Lawrence states in his notes that V.N. Paine's W 1/16 corner bears S 12° E 2.63 chains. This corner is in error.

Description of corner evidence found:

Recovered H.C. Lawrence's 4" tamarack post, squared and scribed W 1/16 S12°, S. 1/16 S30 in fair condition. No PTs were recovered. Could not locate V.N. Paine's corner because of high water.

Description of monument and accessories I established to perpetuate the original location of this corner.

Set a 1" iron pipe with 2" brass cap in place of Lawrence's post. Monument projects 1" above ground. Cap stamped: S492

Marked NBTs - Black Spruce 6" S43°E, 21.7 links, scribed 1/16 BT. T37N R11E
Black Spruce 6" S14°E, 41.3 links, scribed 1/16 BT. W 1/16 S19
W 1/16 S19
CPI-1077

Dated at Rhineland, Wis., this 10th day of August, 1977.

Signature Phillip T. Hansen Title Registered Land Surveyor Registration No. S-498
(County Surveyor, Registered Land Surveyor, or other duly authorized official)

Office of Register of Deeds, County of Oneida
Instrument was filed in this office for record on the 3rd day of August, 1977
at 11:50 o'clock A. M.

Paul J. Tamm Paul A.
(Register of Deeds)

By _____ Deputy

3711190030