

CERTIFIED LAND CORNER RESTORATION

Index No. R-8

State of Wisconsin

County of Oneida } ss.

I, Phillip T. Hansen, do hereby certify that on the 31st day of March, 1979, I ~~found~~ relocated the E 1/16 corner of Sections 20 & 29

Township 37, North, Range 11 East, Fourth Principal Meridian,

as described hereon; and that from this evidence I established a new monument and accessories as described hereon to perpetuate the original location of this corner.

Resident witnesses:

Glen Barker

Jim Clafflin

Herb Wagoner

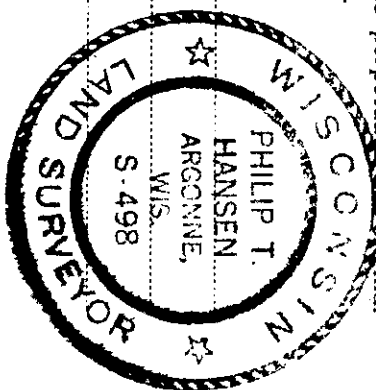

History of original corner establishment:
H.C. Lawrence, Registered Land Surveyor, ran this line from section corner 20, 21, 28 & 29, to 1/4 corner. Found an old post in fence line to north 50 links north of line and old woods road to south.
There is no longer any evidence of the fence line to north and the woods road to the south has been relocated.

Description of corner evidence found:

No evidence of any corner recovered. Ran traverse west from section corner 20, 21, 28 & 29, a distance of 2763.164' to 1/4 corner between section 20 and 29, bearing N 87° 40' 50" W. Set E 1/16 corner at 1381.582' intermediate.

Description of monument and accessories I established to perpetuate the original location of this corner.

Set a 1 1/2" iron pipe for N 1/16 corner with 2" brass cap, stamped:
Monument projects 18" above ground.

Marked NBT's -

Tamarack 4" N66°W 38.61 feet
W. Pine 14" N12°W, 91.30 ft., scribed 1/16 BT

S498
T37N R11E
E 1/16 S 20
S 29
CFI-1979

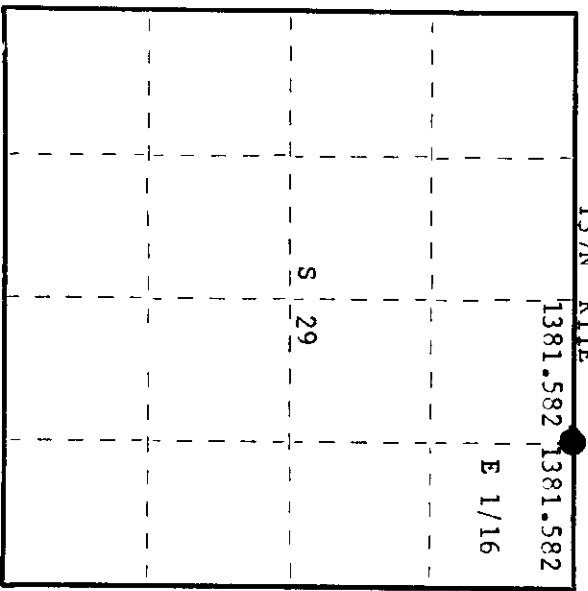

○ = Corner monument restored.

Dated at Rhineland, Wis., this 24th day of April, 1979.

Signature Phillip T. Hansen Title Registered Land Surveyor Registration No. S-498
(County Surveyor, Registered Land Surveyor, or other duly authorized official)

Office of Register of Deeds, County of Oneida
Instrument was filed in this office for record on the 14th day of May, 1979 at 3:30 o'clock P. M.

Doris Terage Kuehn
(Register of Deeds)

By Doris Terage Kuehn Deputy

3711200010