

OK
2/11/83

CERTIFIED LAND CORNER RESTORATION

Index No. Q - 6

History of original corner establishment:

No evidence of any previous corner.

State of Wisconsin }
County of Oneida } ss.

I, Glen Barker, do hereby certify that on the 31st day of August, 1983, I found established the corner of Section 20, Township 37, North, Range 11, East, Fourth Principal Meridian, as described hereon; and that from this evidence I established a new monument and accessories as described hereon to perpetuate the original location of this corner.

Resident witnesses:

J. Clafflin, Reg.
H. Wagoner

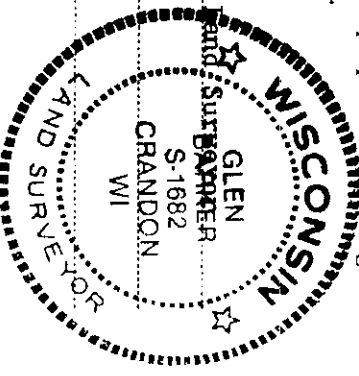

Description of corner evidence found:

Corner established by subdivision of the SW 1/4.
Location of the SW 1/16 is 1376.21 feet of SC 1/16 and 1331.86 feet of W 1/16 between sections 20 & 29.

Description of monument and accessories I established to perpetuate the original location of this corner.

Set a 1" iron pipe with 2" diameter alloy cap, stamped:
Monument projects 18" above ground.
Marked NBT's:
Black Spruce 3" N53W 17.36 feet
Black Spruce 3" N 40W
scribed B.T.
S-1682
T37N R11E
SW 1/16 S 1 20
CPI - 1983

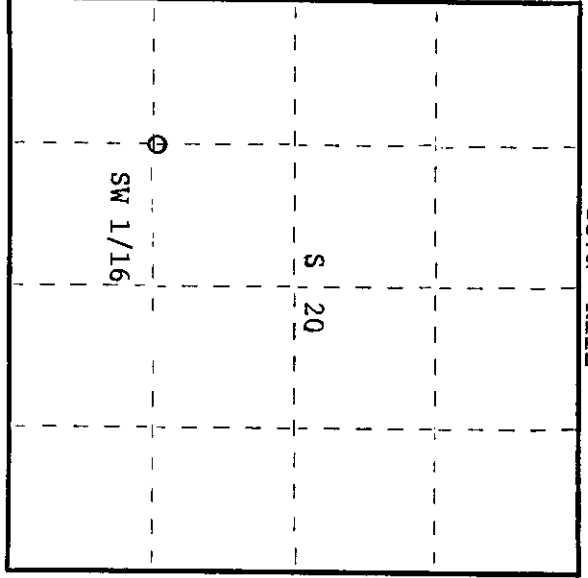

○ = Corner monument restored.

Dated at Rhineclander, Wis., this 29th day of September, 1983.

Signature: *Glen Barker* Title: Registered Land Surveyor Registration No. S-1682
(County Surveyor, Registered Land Surveyor, or other duly authorized official)
Office of Register of Deeds, County of Oneida
Instrument was filed in this office for record on the 3rd day of November, 1983 at 1:05 o'clock P.M.

Donna George Kuehn
(Register of Deeds)

By: Deputy

3711201030