

CERTIFIED LAND CORNER RESTORATION

Index No. 21-21

U 21

State of Wisconsin }  
County of Oneida } ss.

I, Philip T. Hansen, do hereby certify that on the 28th day of May, 1975, I found evidence of the S-1/16 corner of Sections 25 and 26 Township 37, North, Range 11, East, Fourth Principal Meridian, as described hereon; and that from this evidence I established a new monument and accessories as described hereon to perpetuate the original location of this corner.

Resident witnesses:  
.....  
.....  
.....

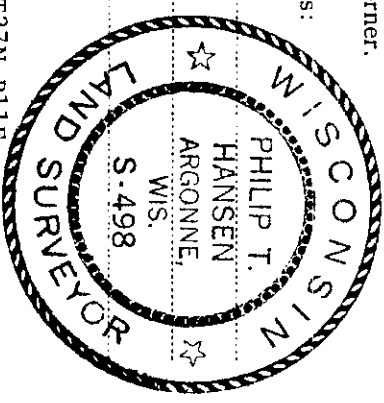

T37N R11E

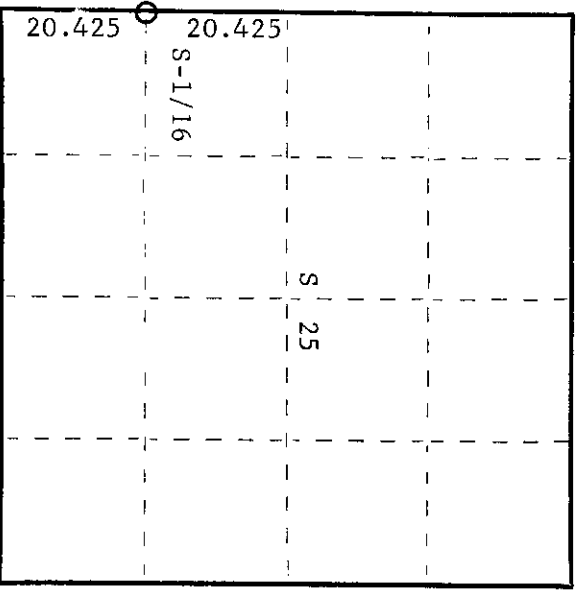

O = Corner monument restored.

History of original corner establishment:  
Corner established by J.A. Melendy in 1916. Made BT's - maple N46 $\frac{1}{2}$ °W 16 links and maple S66°W 31 links.

Corner restored by H.C. Lawrence, Registered Land Surveyor, in 1948, during his retrace-ment survey. Recovered Melendy's post broken off, but found old point in ground. Also found stump of Melendy's sugar maple, and maple S66°W31 standing. Set new cedar post in old hole. No mention of NBT's established.

Description of corner evidence found:

- Recovered H.C. Lawrence's 3" cedar post, squared and scribed S-1/16 S25, S-1/16 S26. The post had rotted off and was lying on the ground. Point of old post found intact in the ground.
- Recovered OBT - hemlock 10" 15' stub S51°E 57 links, scribed S-1/16 S25 NBT.
- Sugar 12" S66°W 31 links, top scribing cut out.
- Sugar 8" N46°30'W 16 links, now decayed stump.

Description of monument and accessories I established to perpetuate the original location of this corner.  
Replaced point of old stake with 1 $\frac{1}{2}$ " O.D. iron pipe with 2" brass cap stamped -

Established NBT - sugar 8" N17°E 63.7 links, scribed 1/16 BT. S498 T37N R11E

S-1/16 S26 S25

CPI-1975

Dated at Rhinelander, Wis., this 12th day of June, 1975.

Signature *Philip T. Hansen* Title Registered Land Surveyor Registration No. S-498  
(County Surveyor, Registered Land Surveyor, or other duly authorized official)

Office of Register of Deeds, County of Oneida  
Instrument was filed in this office for record on the 1st day of October, 1975 at 3:00 o'clock P.M.

*Doris George Tuelka*  
(Register of Deeds)

By: \_\_\_\_\_ Deputy

3711261000