

CERTIFIED LAND CORNER RESTORATION

Index No. S-17

State of Wisconsin

County of Oneida } ss.

I Phillip T. Hansen, do hereby certify that on the 30th day of October, 1975, I found evidence of the N 1/16 corner of Section 26, 27, Township 37 North, Range 11 East, Fourth Principal Meridian, as described hereon; and that from this evidence I established a new monument and accessories as described hereon to perpetuate the original location of this corner.

Resident witnesses:  
Glen Barker  
Jim Clafflin

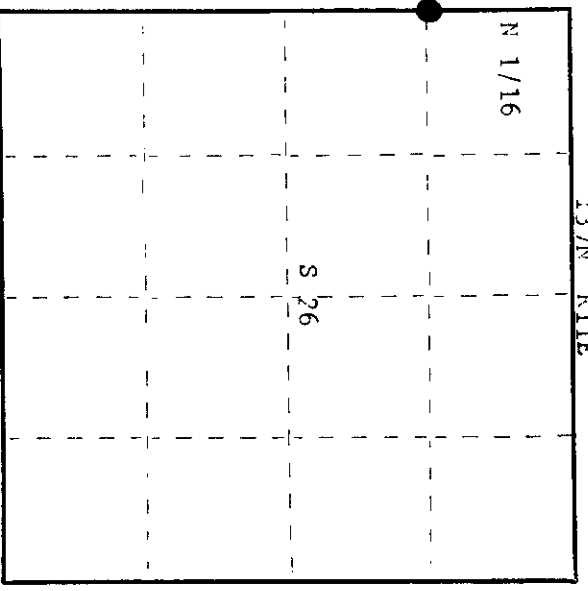

O = Corner monument restored.

History of original corner establishment:

Corner established by V.M. Paine, County Surveyor, in 1916.  
H.C. Lawrence, Registered Land Surveyor, recovered this corner in 1940.  
No record of any RT's established.  
Set new post beside Paine's old post.

Description of corner evidence found:

Recovered 5" squared cedar post, scribed N 1/16 S26 N 1/16 S27, in fair condition.  
Also recovered Paine's old post beside it, scribed 1/9S-1/8S in poor condition.

Description of monument and accessories I established to perpetuate the original location of this corner.

Replaced 5" cedar post with 1-1/2" iron pipe with 2" brass cap, stamped:  
Marked NRT - Cedar on W70° 58 links, scribed 1/16 RT.  
Cedar on N13° E 64.3 links.

T37N R11E  
S27  
N 1/16 S26  
S498

Dated at Rhinelander, Wis., this 26th day of November, 1970

Signature: Phillip T. Hansen, Title: Registered Land Surveyor, Registration No. S-498  
(County Surveyor, Registered Land Surveyor, or other duly authorized official)

Office of Register of Deeds, County of Oneida  
Instrument was filed in this office for record on the 17th day of December, 1979  
at 1:30 o'clock P.M.

Debra George Fuchs  
(Register of Deeds)

By: Deputy

3711273000

CERTIFIED LAND CORNER RESTORATION

Index No. **S-17**

State of Wisconsin

County of Oneida } ss.

I Phillip T. Hansen do hereby certify that on the 30th day of October, 1975, I found evidence of the N-1/16 corner of Sections 26 and 27 Township 37 North, Range 11 East, Fourth Principal Meridian, as described hereon; and that from this evidence I established a new monument and accessories as described hereon to perpetuate the original location of this corner.

Resident witnesses:

Glen Barker

Jim Claflin

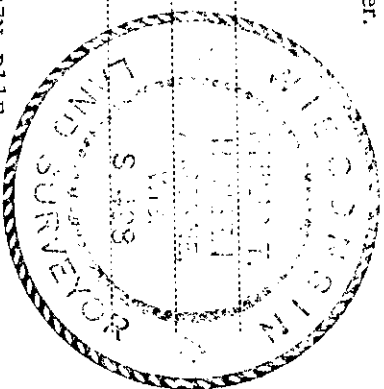

History of original corner establishment:  
 Corner established by V.M. Maine, County Surveyor. Set corner at 20.46 chains north of 1,4 Section Corner, from which cedar 9" bears N90°W, 21 links and cedar 7" bears S38°E, 10-1/2 links. Corner recovered by H.C. Lawrence, Registered Land Surveyor, in 1948 during his retracement survey. Found V.M. Maine's cedar stake, also another older (very old) stake, N81°E, 98 links, of unknown origin. Lawrence's calls checked Maine's. No OBT's were recovered. Set new cedar post. No record of BT's marked.

Description of corner evidence found:  
 Recovered Lawrence's 5" cedar post, squared and scribed N-1/16 S26, N-1/16 S27, in fair condition. Also Maine's 4" cedar post, squared and scribed 1/8S, 1/8S, in poor condition. No traces of OBT's found.

Description of monument and accessories I established to perpetuate the original location of this corner.  
 Replaced Lawrence's cedar post with 1" iron pipe with brass cap stamped - S498  
 Corner projects 18" above ground. T37N R11E  
 NBT's: Cedar 8" N76°W 58 links - scribed 1/16 BT, N-1/16 S27 S26  
 Cedar 8" N13°E 64.3 links - scribed 1/16 BT. CPT-1975

Dated at Rhinelanders, Wis., this 5th day of November, 1975.

Signature *Phillip T. Hansen* Title Registered Land Surveyor Registration No. S-498  
 (County Surveyor, Registered Land Surveyor, or other duly authorized official)

Office of Register of Deeds, County of Oneida  
 Instrument was filed in this office for record on the 31st day of November, 1975 at 10:10 o'clock A.M.

*James Jerome Kuehn*  
 (Register of Deeds)

By Deputy

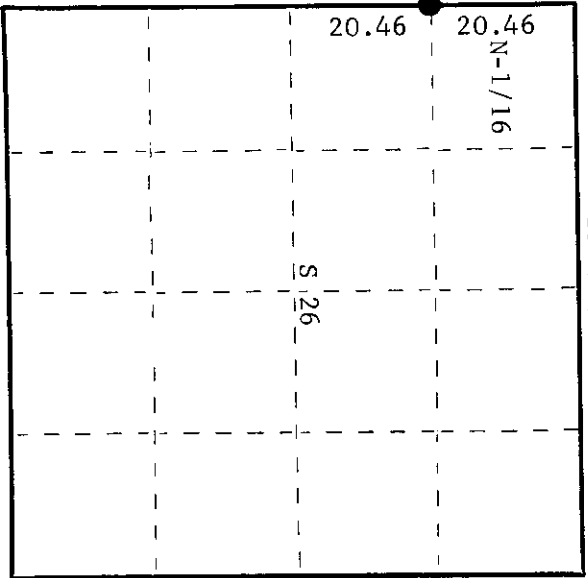

○ = Corner monument restored.

2711273000