

CERTIFIED LAND CORNER RESTORATION

Index No. **S-16**

State of Wisconsin

County of Oneida } ss.

I, Phillip T. Hansen, do hereby certify that on the 4th day of December, 1975, I found evidence of the NE-1/16 corner of Section 27 Township 37 North, Range 11 East, Fourth Principal Meridian, as described hereon; and that from this evidence I established a new monument and accessories as described hereon to perpetuate the original location of this corner.

Resident witnesses:

Glen Barker
Jim Claflin

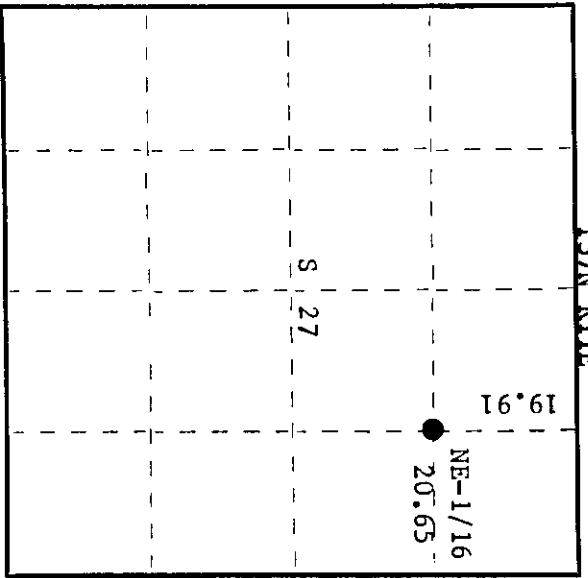
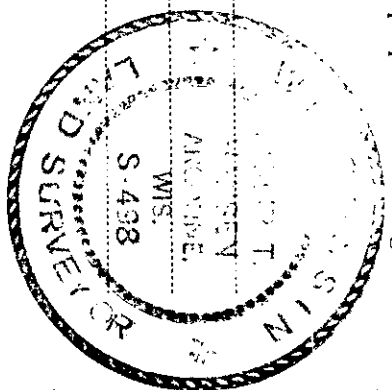

○ = Corner monument restored.

History of original corner establishment: Corner established by H.C. Lawrence, Registered Land Surveyor, in 1949. From established N-1/16 between S26 and S27, he ran West (var. 0°20'W) 41.22 chains to intersect true N-S-1/4 line 36 links North of NC-1/16. Corrected bearing of line S89°50'W. Ran random line South from E-1/16 between S22 and S27 at 19.91 chains. Intersected corrected E-W-1/4 line. Intersected true E-W-1/4 line at 39.88, 11 links West of EC-1/16 post. Set 5" cedar post at 19.91 chains South of E-1/16 and 20.65 chains West of N-1/16 corner. Marked white birch 9", S20°E, 61 links and white birch 8", N50°E, 44 links

Description of corner evidence found: Recovered 5" cedar post, squared and scribed NE-1/16 S27, NE-1/16, in fair condition.

Recovered OBT - White birch 9" S20°E 61 links Now a 12' stub, scribed E-1/16 BT.
White birch 8" N50°E 44 links Now a decayed stump.

Description of monument and accessories I established to perpetuate the original location of this corner.
Replaced 5" cedar post with 1" O.D. iron pipe with 2" brass cap stamped -
Pipe projects 18" above ground.

NBT's - Maple 7"	N50E	36.5 links	scribed 1/16 BT	
Maple 8"	S26°W	41.4 links	scribed 1/16 BT	
				NE-1/16 S 22
				T37N R11E
				S498
				CPI-1975

Dated at Rhinelander, Wis., this 10th day of December, 1975.

Signature: Phillip T. Hansen Title: Registered Land Surveyor Registration No. S-498
(County Surveyor, Registered Land Surveyor, or other duly authorized official)

Office of Register of Deeds, County of Oneida, I hereby certify that the within instrument was filed in this office for record on the 4th day of December, 1975 at 1:00 o'clock P. M.

James George Kiehn
(Register of Deeds)

By: _____ Deputy

3711273010