

CERTIFIED LAND CORNER RESTORATION

Index No. 1-10

State of Wisconsin }
 County of Oneida } ss.

History of original corner establishment:
 No record of any previous survey.

I Phillip T. Hansen, do hereby certify that on the 24th day of June, 1980, I ~~restored~~ established the W 1/16 corner of Sections 28 and 33 Township 37, North, Range 11 East, Fourth Principal Meridian.

as described hereon; and that from this evidence I established a new monument and accessories as described hereon to perpetuate the original location of this corner.

Resident witnesses:

Glen Barker
Jim Claflin
Herb Wagoner

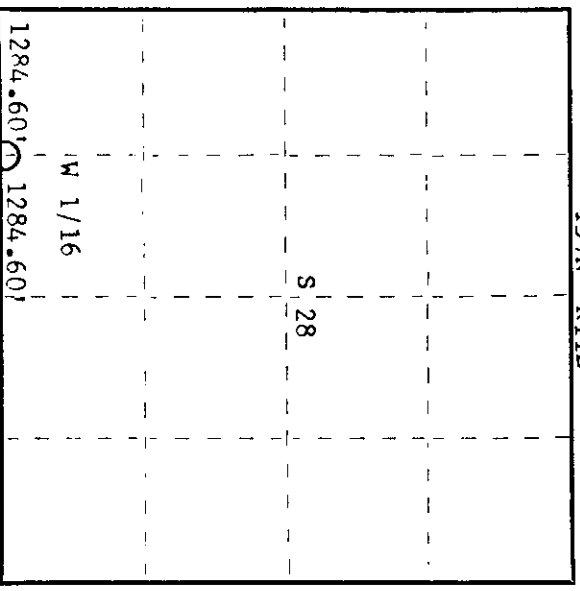
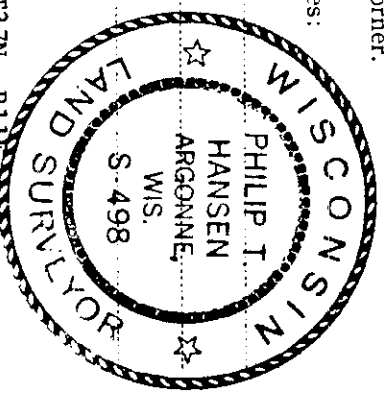

○ = Corner monument restored.

Description of corner evidence found:

No evidence of any corner recovered.
 Corner established by proportion.
 Ran traverse from previously established section corner 28, 29, 32, 33 to 1/4 corner between sections 28 and 33 for a distance of 2569.20 feet at bearing S 86° 02' 30" E.
 Set W 1/16 1284.60 ft. intermediate.

Description of monument and accessories I established to perpetuate the original location of this corner.
 Set a 1-1/2" iron pipe with 2" brass cap, stamped:
 Monument projects 24" above ground.

Marked NBT's -
 Sugar 6" N65°W 19.26 feet S498
 Sugar 6" N9°E 25.48 feet T37N R11E
 scribed 1/16 B.T. W 1/16 S+28
 CPI-1980 S+33

Dated at Rhineland, Wis., this 23rd day of July, 1980

Signature Phillip T. Hansen Title Registered Land Surveyor Registration No. S-498
(County Surveyor, Registered Land Surveyor, or other duly authorized official)

Office of Register of Deeds, County of Oneida I hereby certify that the within instrument was filed in this office for record on the 30th day of July, 1980 at 1015 o'clock A. M.

Doris Lange Fuchs
(Register Deeds)

By: _____ Deputy