

CERTIFIED LAND CORNER RESTORATION

Index No.

7-9
79

State of Wisconsin

County of Oneida } ss.

I Philip T. Hansen, do hereby certify that on the 1st day of April, 1975, I found evidence of the Quarter corner of Sections 28 & 29

Township 37, North, Range 11 East, Fourth Principal Meridian,

as described hereon; and that from this evidence I established a new monument and accessories as described hereon to perpetuate the original location of this corner.

Resident witnesses:

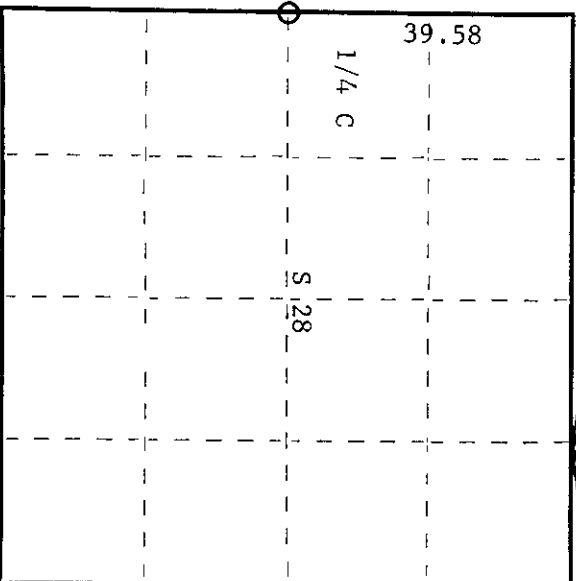
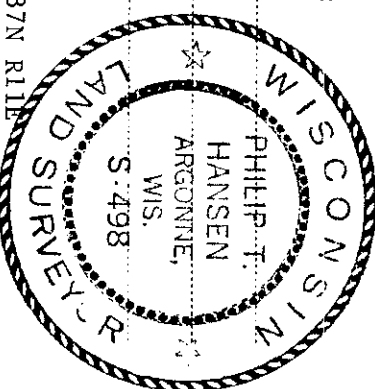

○ = Corner monument restored.

CERTIFIED LAND CORNER RESTORATION

History of original corner establishment:

Original corner established by Wm. E. Dougherty, Gov. Deputy Surveyor, in 1859. Set tamarack 6" N40°W 30 links; tamarack 7" N65°E 18 links.
 Corner restored by V.M. Maine, County Surveyor, from which white pine stump 38" bears N3°W 9 1/2 links; white pine stump 26" bears S60W 39 links.
 Corner restored by H.C. Lawrence, Registered Land Surveyor. Recovered Maine's 1/4 post. Set new post beside it. Established NBT's - tamarack 9" N79°E 108 links; tamarack 9" S74°W 85 links.

Description of corner evidence found:

Corner recovered. Maine's old 4" cedar post, squared and scribed 1/5 S28, 1/5 S29, in poor condition; Lawrence's 4" cedar post, squared and scribed 1/5 S28, 1/5 S29, in fair condition. Also recovered a 2 1/2" iron pipe with brass cap stamped -
 Origin unknown.

Recovered BT's - tamarack 9" N84°E(N79°E) 108 links, scribed S28 NBT.
 Tamarack 9" - now 13" S80°W(S74°W) 85 links; scribing
 Grown over.

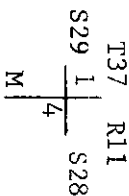

Description of monument and accessories I established to perpetuate the original location of this corner.

No additional accessories established.

Dated at Rhineland, Wis., this 19th day of August, 1975.

Signature Philip T. Hansen Title Registered Land Surveyor Registration No. S-498
 County Surveyor, Registered Land Surveyor, or other duly authorized official

Office of Register of Deeds, County of Oneida
 Instrument was filed in this office for record on the 1st day of October, 1975
 at 3:00 o'clock P. M.

Doris Terese Tuelin
 (Register of Deeds)

By: _____ Deputy

3711292000