

CERTIFIED LAND CORNER RESTORATION

Index No. **S-6**

State of Wisconsin

County of Oneida } ss.

I Phillip P. Hansen, do hereby certify that on the 3rd day of September, 1976, I found evidence of the 1/16 corner of Section 29, Township 27, North, Range 11 East, Fourth Principal Meridian, as described hereon; and that from this evidence I established a new monument and accessories as described hereon to perpetuate the original location of this corner.

Resident witnesses:

Don Barker

Jim Martin

Herb Macomber

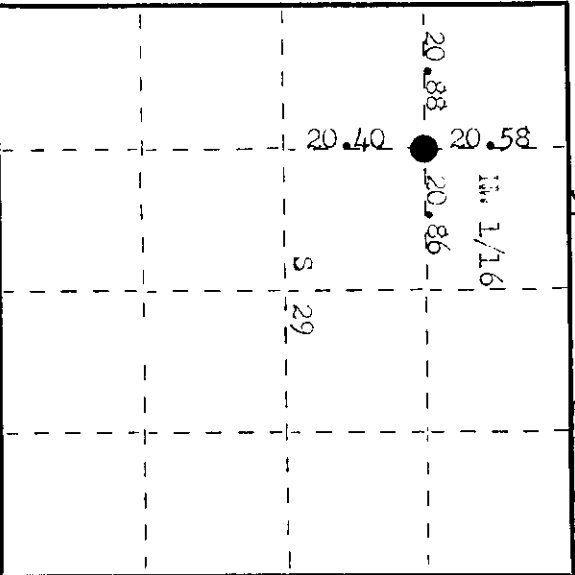
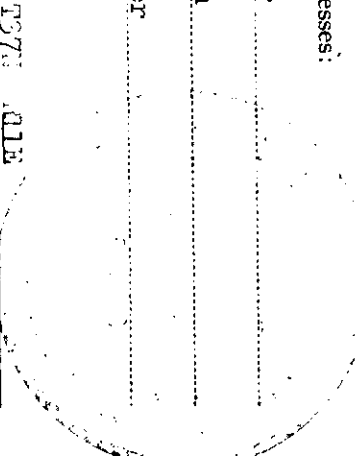

○ = Corner monument restored.

History of original corner establishment:

Corner established by H.C. Lawrence, registered land surveyor, in 1921. ran the NW 1/4 line of SW 1/4 and NW 1/4 line of NW 1/4. Set 5" cedar post at intersection of corrected lines. Marked WPT - burnt, sound, white pine stump in 42° 30 links and hollow cedar stump with post in center, in 07° 45 links.

Description of corner evidence found:

Recovered 5" cedar post, squared and scribed in 1/16 227, in 1/16 in fair condition.

Recovered WPT - Pine stump in 42° 30 links, scribed 30

cedar stump in 37° 45 links (45.5) links, scribed WPT with 4" squared cedar post driven in center of stump. scribed WPT.

Description of monument and accessories I established to perpetuate the original location of this corner.

replaced 5" cedar post with 1 1/2" OD iron pipe with brass cap stamped: Monument projects 18" above ground.

WPT's - Black spruce 3" N 50° W 33.2 links, scribed 1/16 WPT. Black spruce 3" S 34° W 31.3 links, scribed 1/16 WPT.

Monument and WPT's painted blue. In 1/16 249 CPI-1976

Dated at Orineland, Wis. this 7th day of September, 1976

Signature Phillip P. Hansen Title Registered Land Surveyor Registration No. 2-473  
(County Surveyor, Registered Land Surveyor, or other duly authorized official)

Office of Register of Deeds, County of Oneida 9th day of November, 1976  
at 10:30 o'clock A.M. I hereby certify that the within instrument was filed in this office for record on the

Terre Lorange Kuehn  
(Register of Deeds)

By Terre Lorange Kuehn Deputy

3711293030