

CERTIFIED LAND CORNER RESTORATION

Index No. Y-13

State of Wisconsin

County of Oneida

} ss.

I, Phillip T. Hansen, do hereby certify that on the 17th day of March, 19 78, I found evidence of the S. 1/16 corner of Sections 33 & 34 Township 37 North, Range 11 East, Fourth Principal Meridian.

I established a new monument and accessories as described hereon; and that from this evidence as described hereon to perpetuate the original location of this corner.

Resident witnesses:

Glen Barker

Jim Claffin

Herb Wagoner

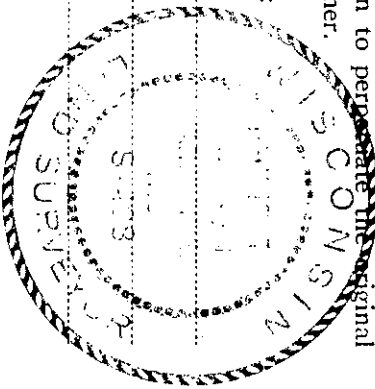

History of original corner establishment:  
Corner established by H.C. Lawrence, Registered Land Surveyor, in 1952. From section corner 33, 34 - 37-11 3,4 - 36-11 ran N 1° E 38.04 chains, closed out 37 links east of 1/4 corner between 33 & 34. Set S 1/16 18 1/2 links west of 19.02 chains. Set 4" cedar post, nothing for BT's.

Description of corner evidence found:  
Recovered N 1° S 4" cedar post laying under snow rotted, S 1/16 marks still visible.  
Recovered post point.  
OBT's - None

Description of monument and accessories I established to perpetuate the original location of this corner.  
Replaced post point with a 1 1/2" iron pipe with brass cap, stamped:  
Projects 24" above ground.  
Corner sets in an aspen slash, no BT's near.  
Set two iron pipes for witness corners:  
#1 - 3/4" iron pipe bears north 20 links, T37N R11E S498 18" above ground  
#2 - 1 1/2" iron pipe bears west 25 links, S 1/16 33 1/2 18" above ground CPI-1978

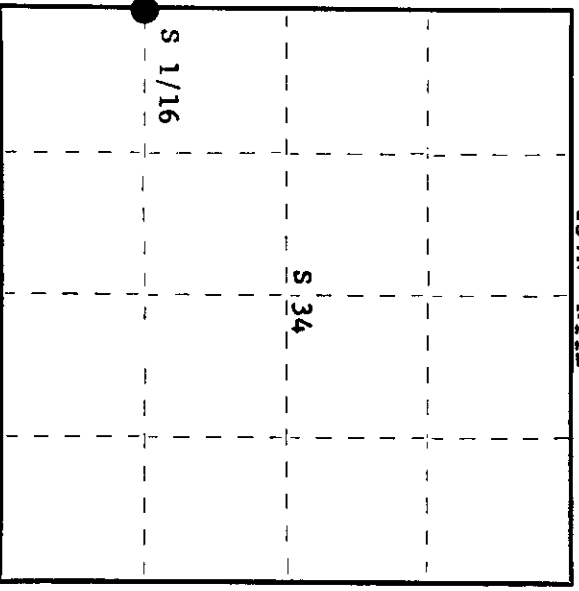

○ = Corner monument restored.

Dated at Rhineland Wis., this 4th day of April, 19 78

Signature Phillip T. Hansen Title Registered Land Surveyor Registration No. S-498  
(County Surveyor, Registered Land Surveyor, or other duly authorized official)

Office of Register of Deeds, County of Oneida  
at 10:30 o'clock AM on the 16th day of April, 19 78  
I hereby certify that the within instrument was filed in this office for record on the

Doris Wagoner  
(Register of Deeds)

By \_\_\_\_\_ Deputy

3711331000