

CERTIFIED LAND CORNER RESTORATION

Index No. **A-16**

State of Wisconsin }
 County of Oneida } ss.

I Philip T. Hansen, do hereby certify that on the 10th day of January, 1975, I found evidence of the E-1/16 corner of Section 34-3 Township 37-36, North, Range 11 East, Fourth Principal Meridian, as described hereon; and that from this evidence I established a new monument and accessories as described hereon to perpetuate the original location of this corner.

Resident witnesses:

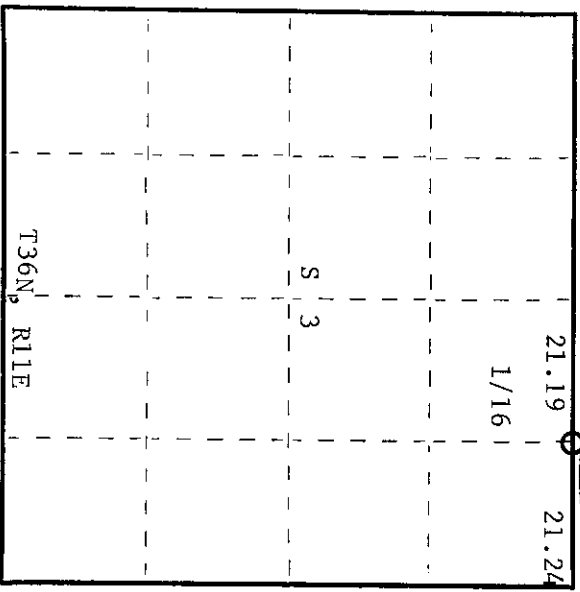
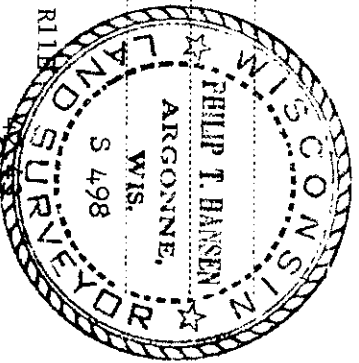

O = Corner monument restored.

History of original corner establishment:
 Original corner established by V.M. Maine, County Surveyor.

Corner recovered by H.C. Lawrence on his retracement survey of 1952. He reran the line from corner of Sec. 2-3-35 and 34, intersected Maine's 1/16 Corner, 2.47 chains North of 21.38 chains on bearing of N85°00'W. Corrected bearing to 1°36' var. and reran the line, intercepted Maine's 1/16 at 21.24 chains. Recovered Maine's BT. Cedar 10" N39W 34 1/2 lks.; Cedar 8" S80E 53 lks. set.

Description of corner evidence found:

- Recovered V.M. Maine's cedar post fallen down and rotten, also found 1" iron pipe.
- Recovered Maine's BT Cedar 10" N39W 33-1/2 lks.; Cedar 8" S80°E 54 lks.
- Scribed S- BT only stump remains.

Description of monument and accessories I established to perpetuate the original location of this corner.

- Set new 1-1/4" O.D. iron pipe with 2" brass cap stamped - S498
- Set NBT. Black ash 7" S86W 25-1/2 lks. Scribed 1/16 BT T37N

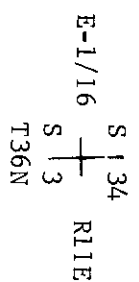

Dated at Rhinelander, Wis., this 10th day of June, 1975. CPI-1975

Signature *Philip T. Hansen* Title Registered Land Surveyor Registration No. S-498
 (County Surveyor, Registered Land Surveyor, or other duly authorized official)

Office of Register of Deeds, County of Oneida. I hereby certify that the within instrument was filed in his office for record on the 1st day of October, 1975 at 3:00 o'clock P.M.

Doris Searge Tucker
 (Register of Deeds)

By: _____ Deputy

3711340010