

CERTIFIED LAND CORNER RESTORATION

Index No. Y-117

State of Wisconsin }
County of Oneida } ss.

I Phillip T. Hansen, do hereby certify that on the 6th day of January, 1975, I found evidence of the S-1/16 corner of the 34-35 Township 37 North, Range 11 East, Fourth Principal Meridian, as described hereon; and that from this evidence I established a new monument and accessories as described hereon to perpetuate the original location of this corner.

Resident witnesses:

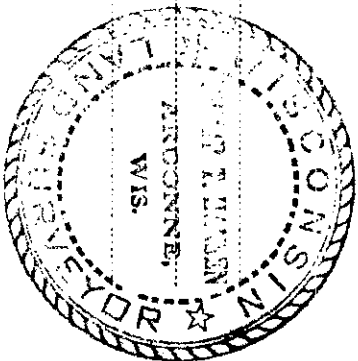

History of original corner establishment:
Original corner established by V.M. Maine, County Surveyor in 1935.

Reestablished by H.C. Lawrence, Reg. Land Surveyor during his retracement survey of 1952. He states that from the recovered 1/4 corner between Sec. 34 and 35 he ran S2°30'E 19.60 chains, Maine's S-1/16 Corner was 18 lks. West of line. Continued S2°30'E to 39.20 at which point corner of Sec. 34-35-3-2 was 36 lks. West at rt. angles. Corrected true line was S1°58'E. Set new S-1/16 Corner 18 lks. West, where Maine's post had been. Re-scribed Maine's BT's which were recovered in good condition.

Description of corner evidence found:

Recovered 4" cedar post, squared and scribed S34 S-1/16; S35 S-1/16 in poor condition. Rock cairn placed around this post. No old BT's visible.

Description of monument and accessories I established to perpetuate the original location of this corner.
Set a 1" x 5" iron pipe with 2" brass cap stamped as follows -

New BT's	Sugar maple 7"	N24°W	34 lks.	scribed 1/16 BT	T37N, R11E
	Sugar maple 7"	S35E	12 lks.	scribed 1/16 BT	S498
	Sugar maple 7"	N74E	28 lks.	scribed 1/16 BT	S34/S35

S-1/16
CPI-1975

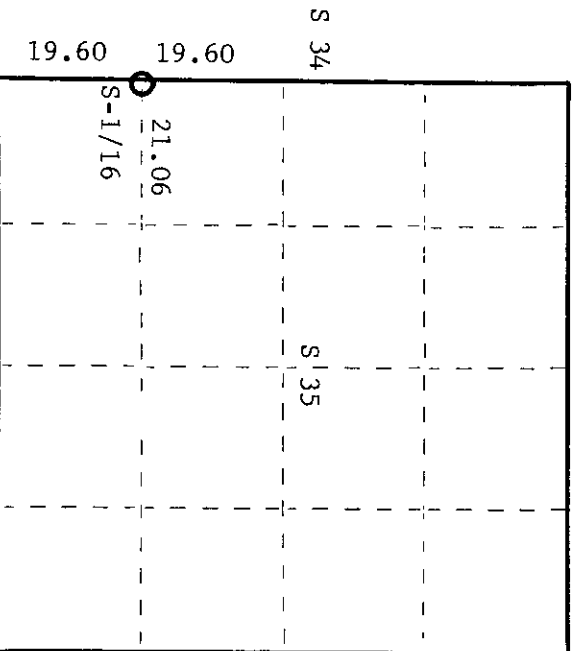

○ = Corner monument restored.

Dated at Rhineland, Wis., this 19th day of 1975.

Signature: Phillip T. Hansen Title: Registered Land Surveyor Registration No. S-498
(County Surveyor, Registered Land Surveyor, or other duly authorized official)

Office of Register of Deeds, County of Oneida, I hereby certify that the within instrument was filed in this office for record on the 12th day of October, 1975 at 3:00 o'clock P.M.

Doris Verge Fuchs
(Register of Deeds)

By _____ Deputy

271134 1000