

CERTIFIED LAND CORNER RESTORATION

Index No. **Y 16**

State of Wisconsin }  
 County of Oneida } ss.

I Philip T. Hansen, do hereby certify that on the 4th day of September 1975, I found evidence of the SE-1/16 corner of Section 34, Township 37, North, Range 11 East, Fourth Principal Meridian, as described hereon; and that from this evidence I established a new monument and accessories as described hereon to perpetuate the original location of this corner.

Resident witnesses:

Glen Barker  
Jim Clafflin

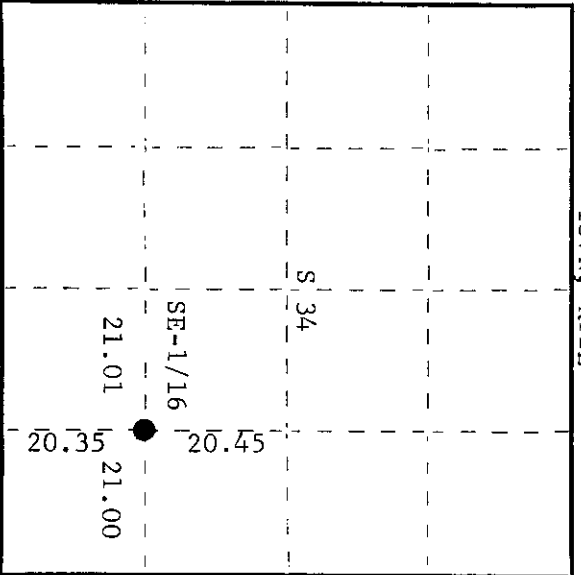
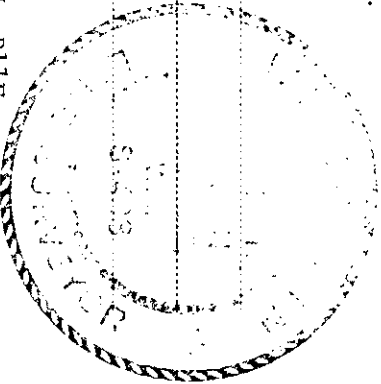

History of original corner establishment:  
 Corner established by H.C. Lawrence, Registered Land Surveyor, in 1952. Established corner at intersection of true lines North-South and East-West through this 1/4 section. It is 21.01 chains East of SC-1/16, 21.00 chains West of S-1/16 corner, 20.45 1/2 chains South of EC-1/16 corner, and 20.35 chains North of E-1/16 corner. Set cedar post and marked NBT's yellow birch 18", S30 1/2 W, 40 1/2 links and cedar stub 16", N87 E, 44 1/2 links.

Description of corner evidence found:

Recovered 4" cedar post, squared and scribed SE-1/16 S34, SE-1/16 S34, in fair condition.  
 Recovered OBT's yellow birch 18" (20"), S30 1/2 W (S33 W), 40.5 links, scribed SE-1/16 BT and cedar stub N87 E, 44.5 links, scribed S34 BT.

Description of monument and accessories I established to perpetuate the original location of this corner.  
 Replaced cedar post with 1 1/2" OD iron pipe with 2" brass cap stamped -

NBT - White birch 8" N18 W 39.5 links scribed 1/16 BT SE-1/16 S 34

CPL-1975

Dated at Rhineland, Wis., this 18th day of September, 1975.

Signature Philip T. Hansen Title Registered Land Surveyor Registration No. S-498  
 (County Surveyor, Registered Land Surveyor, or other duly authorized official)

Office of Register of Deeds, County of Oneida  
 Instrument was filed in this office for record on the 17th day of November 1975  
 at 10:08 o'clock A. M. I hereby certify that the within

Doris Tenage Fuchs  
 (Register of Deeds)

By Doris Tenage Fuchs Deputy

CERTIFIED LAND CORNER RESTORATION

Index No. Y-16

State of Wisconsin

County of Oneida } ss.

I, Phillip T. Hansen, do hereby certify that on the 4th day of September, 1975, I found evidence of the SE 1/16 corner of Section 34 Township 37, North, Range 11 East, Fourth Principal Meridian, as described hereon; and that from this evidence I established a new monument and accessories as described hereon to perpetuate the original location of this corner.

Resident witnesses:

Glen Barker

Jim Claflin

History of original corner establishment:

Corner established by H.C. Lawrence, Registered Land Surveyor, in 1952. Ran random line from SC 1/16 to S 1/16 and from E 1/16 to EC 1/16. Set SE 1/16 at point 5 links south of E-W random line and 17 links east of N-S random line. Set 4" cedar post and marked NPT's - Y. Birch 18" S30-1/2°W 40-1/2 links and cedar stub 16" N87°E 44-1/2 links.

Description of corner evidence found:

Recovered 4" squared cedar post, scribed SE 1/16 S34 in fair condition.  
 Recovered Y. Birch 18" (20") S30-1/2°W (S33°W) 40.5 links, scribed SE 1/16 BT.  
 Cedar stub - N87°E 44.5 links scribed S34 BT.

Description of monument and accessories I established to perpetuate the original location of this corner.

Replaced 4" cedar post with 1-1/2" iron pipe with 2" brass cap, stamped:  
 Monument projects 18".  
 Dropped old post beside new monument.  
 Marked NBT - W. Birch 8" N18°W 39.5 links, scribed 1/16 BT.

T37N R11E  
 SE 1/16 S 34  
 CTI-S498

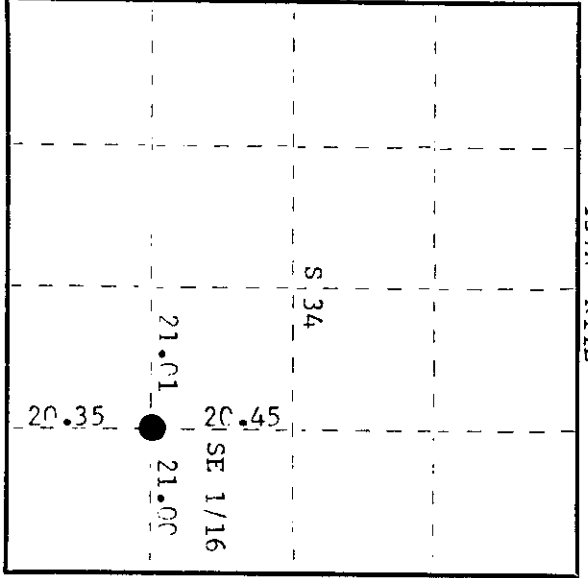

○ = Corner monument restored.

Dated at Rhineland, Wis., this 26th day of November, 1979.

Signature: [Signature] Title Registered Land Surveyor Registration No. 5-498  
 (County Surveyor, Registered Land Surveyor, or other duly authorized official)  
 Office of Register of Deeds, County of Oneida  
 at 11:30 o'clock P. M. 3rd day of December, 1979

[Signature]  
 (Register of Deeds)

By: [Signature] Deputy

3711341010