

CERTIFIED LAND CORNER RESTORATION

Index No.

X-21
121

State of Wisconsin } ss.
County of Oneida

I Philip T. Hansen, do hereby certify that on the 27th day of May, 1975, I found evidence of the Quarter corner of Section 35-36 Township 37N, North, Range 11, East, Fourth Principal Meridian, as described hereon, and that from this evidence I established a new monument and accessories as described hereon to perpetuate the original location of this corner.

Resident witnesses:

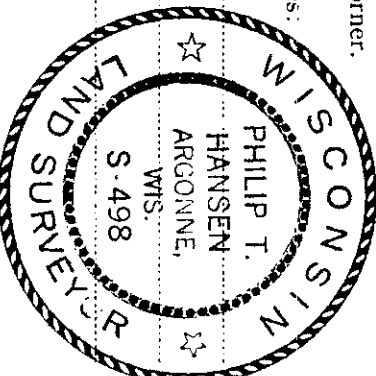

T37N, R11E

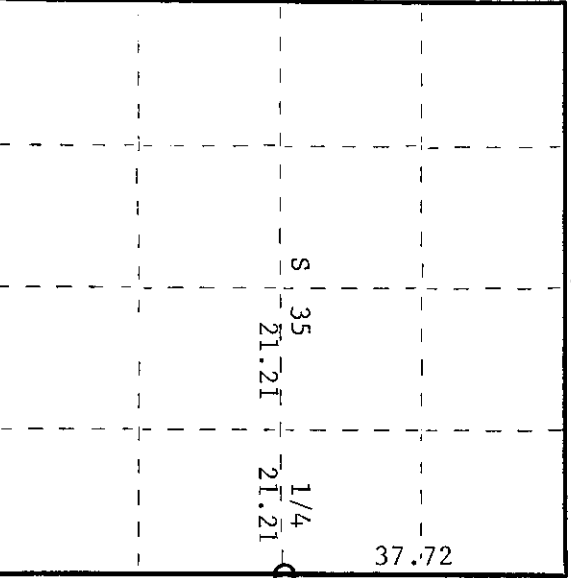

○ = Corner monument restored.

CERTIFIED LAND CORNER RESTORATION

Index No.

X-21
121

History of original corner establishment: Original corner established by Wm. E. Dougherty, Gov. Deputy Surveyor, in 1859, from which tamarack 7" bears N61°E 17 links, and spruce 5" bears S54°W 9 links. Corner re-established by J.A. Melendy, Gagen Lumber Co. Surveyor, in 1916. He was unable to find this quarter corner when he ran from the NE corner to SE corner, a distance of 75.92 chains. Set corner at 37.9 chains, from which he made BT's - balsam 9" N54-3/4°W 16-7/8 links, birch 14" S7-3/4°W 13-5/8 links, cedar 7" N31°E 46-7/8 links, and pine 18" S85°W 62-1/4 links. H.C. Lawrence, Registered Land Surveyor, during his retracement survey in 1949, found all of the above except the birch. He dug up the point of Melendy's post and set new 5" cedar post in old hole. Made NBT's - cedar 7" N72°W 28 1/2 links, cedar 10" N43°E 43 links, hemlock 12" S71°E 23 1/2 links.

Description of corner evidence found:
Recovered 5" cedar post, squared and scribed 1/8 S35, 1/8 S35, in poor condition but standing. Also recovered part of old scribed post lying beside it. A 2 1/2" pipe with brass cap scribed 1/4 T37 R11E S35-36 M, set by Maine, bears S30°E 5 links from H.C. Lawrence's post.

Recovered OBT's - cedar	7" (8)	N72°W (N70°W)	28.5 links, scribed 1/4 S35.
Cedar	10" (12)	N43°E	43 links, scribed 1/4 S36.
Hemlock	12" (16)	S71°E (S64°E)	23.5 links, scribing grown over.

Description of monument and accessories I established to perpetuate the original location of this corner.
Replaced wooden post with 2 1/2" iron pipe with brass cap stamped -

No NBT's established.

Removed Maine's 2 1/2" iron pipe as Lawrence's corner coincided with Melendy's corner, as verified in his notes.

S498
T37N R11E
1/4 S35 | S36
CPL-1975

Dated at Rhinelander, Wis., this 12th day of June, 1975.

Signature: *Philip T. Hansen*
(County Surveyor, Registered Land Surveyor, or other duly authorized official)
Title: Registered Land Surveyor
Office of Register of Deeds, County of Oneida
Instrument was filed in this office for record on the 1st day of October, 1975 at 3:00 o'clock P.M.

Doris George Fuchs
(Register of Deeds)

By: Deputy