

CERTIFIED LAND CORNER RESTORATION

Index No. 24-20

10 20

State of Wisconsin }
County of Oneida } ss.

I Philip T. Hansen, do hereby certify that on the 28th day of May, 1975, I found evidence of the NE-1/16 corner of Section 35 Township 37, North, Range 11 East, Fourth Principal Meridian, as described hereon; and that from this evidence I established a new monument and accessories as described hereon to perpetuate the original location of this corner.

Resident witnesses:

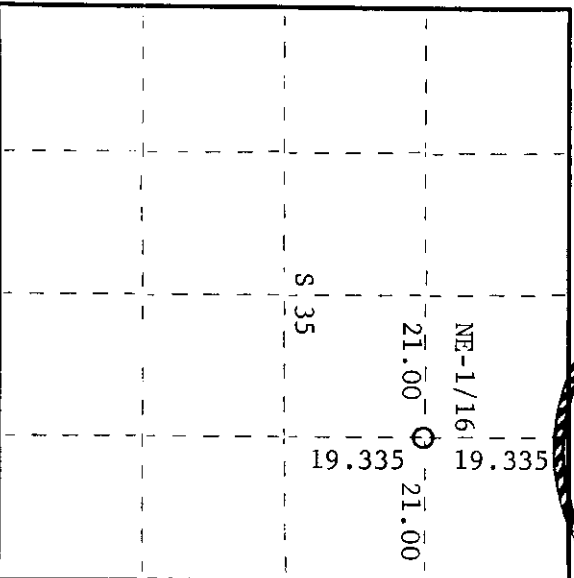
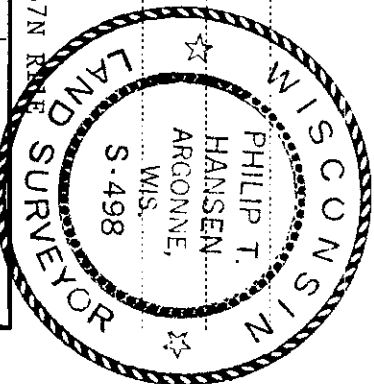

○ = Corner monument restored.

CERTIFIED LAND CORNER RESTORATION

History of original corner establishment:

Corner established by H.C. Lawrence, Registered Land Surveyor, during his retracement and subdivision survey in 1949. From established E-1/16 corner between Sections 26 and 35, ran S20°35'E a distance of 38.67 chains to intersect E-W ¼ line 35 links east of EC-1/16 corner. Corrected true bearing S20°04'E. Set NE-1/16 corner on corrected line equidistant at 19.335 chains. Did not record BT's established.

Description of corner evidence found:

Recovered 4" cedar post, squared and scribed NE-1/16, S35, NE-1/16 S35, in fair condition.
Recovered 0BT - elm 14" S52°E 24.4 links, scribed NE-1/16 S35 BT.

Description of monument and accessories I established to perpetuate the original location of this corner.

Replaced the 4" cedar post with 1½" O.D. iron pipe with 2" brass cap stamped - S498
NBT - sugar 10" S9°E 38.8 links, scribed 1/16 BT. T37N R11E

NE-1/16 S 35

CPI-1975

Dated at Rhinelander, Wis., this 12th day of June, 1975.

Signature Philip T. Hansen Title Registered Land Surveyor Registration No. S-498
(County Surveyor, Registered Land Surveyor, or other duly authorized official)

Office of Register of Deeds, County of Oneida
Instrument was filed in this office for record on the 1st day of October, 1975
at 3:00 o'clock P. M.

Dorrie Leverage Kunkel
(Register of Deeds)

By: _____ Deputy

371135 30 10