

CERTIFIED LAND CORNER RESTORATION

Index No.

24-18  
W 18

State of Wisconsin

County of Oneida } ss.

I, Philip T. Hansen, do hereby certify that on the 27th day of May, 1975, I found evidence of the NW-1/16 corner of Section 35 Township 37 North, Range 1 East, Fourth Principal Meridian, as described hereon; and that from this evidence I established a new monument and accessories as described hereon to perpetuate the original location of this corner.

Resident witnesses:

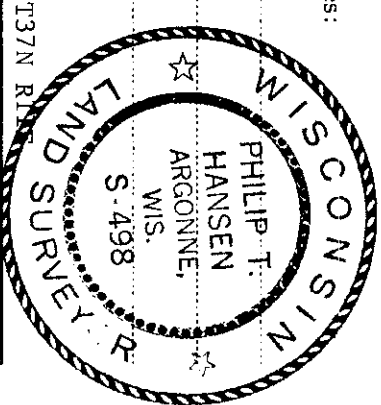

T37N R1E

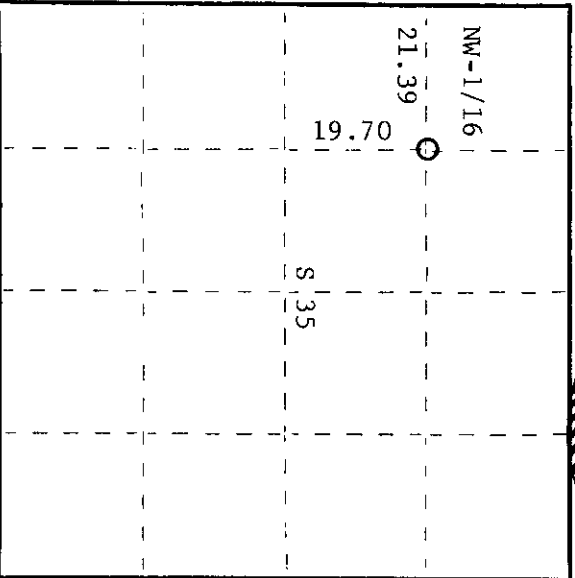

○ = Corner monument restored.

CERTIFIED LAND CORNER RESTORATION

History of original corner establishment:

Corner established by H.C. Lawrence, Registered Land Surveyor, during his retracement and subdivision survey in 1949. He ran a random line N3900'W from established WC-1/16 and subdivision survey line between Sections 25 and 35 50 links west of W-1/16. Corrected bearing of line N20°17'W. From the established N-1/16 between Sections 34 and 35, he ran N87°00'E 42.45 chains to intersect the N-S random quarter-quarter line at 19.20 north of WC-1/16 and intersected N-S true ¼ line of Section 35 at 1.00 chain south of NC-1/16. Corrected bearing N85°40'E. Set 3" cedar post for NW-1/16 at 19.70 north of WC-1/16 and 21.39 east of N-1/16, from which black ash 8" bears N70W 44 links, and white ash 5" bears N37°E 30 links.

Description of corner evidence found:

Recovered 3" cedar post, squared and scribed NW-1/16 S35; NW-1/16 S35, in fair condition.  
Recovered OBT's - black ash 8"(10") N70°W(N74°W) 44 links, scribing grown over.  
White ash 5"(6") N37°E 30 links, scribed NW-1/16 BT.

Description of monument and accessories I established to perpetuate the original location of this corner.

Replaced 3" cedar post with 1½" O.D. iron pipe with 2" brass cap stamped -

No NBT's established.

S498  
T37N R1E

CPI-1975

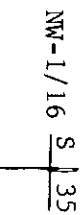

Dated at Rhinelander, Wis., this 11th day of June, 1975

Signature *Philip T. Hansen* Title Registered Land Surveyor Registration No. S-498  
(County Surveyor, Registered Land Surveyor, or other duly authorized official)

Office of Register of Deeds, County of Oneida  
Instrument was filed in this office for record on the 1st day of October, 1975  
at 3:00 o'clock P.M.

*Doris Verage Tuelke*  
(Register of Deeds)

By: Deputy