

Stock No. 26273

ONEIDA COUNTY, WIS.

Received for Record the 16th day of July A.D. 1905 at 9:00 o'clock P.M. and Recorded in Range 11 Restoration Vol. of RECORDS on page

Dois Verage Kuehn

REGISTER OF DEEDS

Sheet 1 of 4

# CERTIFIED LAND CORNER RESTORATION AND BOUNDARY ESTABLISHMENT

Being the Corners on the Range Line to Sections 19-30-24-25, 31-6-36-1 and 5-6, 31-32 and Quarter Corners to Sections 36-31 and 6-31, and Meander Corners 1, 2 and 3 Townships 36-37 North, Ranges 11-12 East, Fourth Principal Meridian FOREST - ONEIDA COUNTIES, WISCONSIN

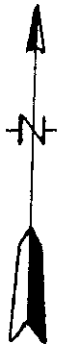
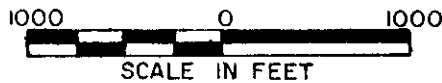

3711240000  
3711252800  
3711250002  
3711363700  
3711362000  
3711361000  
3711360000

### LEGEND

- Forest County Monument, Aluminum Cap
- Oneida County Monument With 2" Brass Cap on Iron Pipe
- 2" x 30" Berntsen Aluminum Monument
- 2" x 120" Berntsen Aluminum Monument
- 2" x 60" Forest Service Monument 3" Brass Cap on Iron Pipe
- Marked Boundary Line of U.S. Government Land

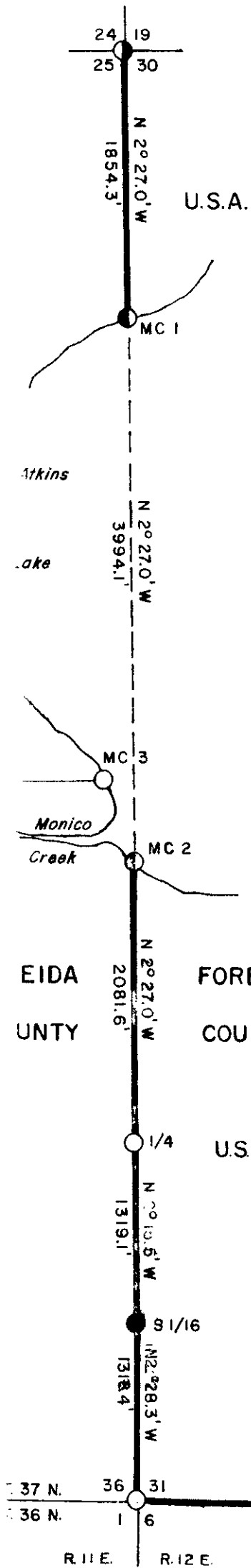

Conversion Factors:  
Feet to Meters - 0.30480  
Meters to Feet - 1.09361

R-25

Stock No. 26273

Sheet 2 of 4

SURVEY NOTES

This survey was made by the U. S. Department of Agriculture, Forest Service, for the purpose of restoring and establishing corners on the perimeter of Sections 30 and 31, for establishing subdivisional corners, and for locating and marking the boundaries of U. S. Government lands on their perimeter for Sections 30 and 31, Township 36-37 North, Range 11-12 East, Fourth Principal Meridian, Forest County, Wisconsin.

The U. S. Government lands in these sections were acquired in 1932, 1939, and 1978.

The original Government survey of this township was made in 1858 and 1859.

The corner positions recovered, restored, and established by this survey are marked by the monument described in the map legend.

The corner positions established were located to an accuracy of one part in 3000.

The bearings between corner positions are true bearings as determined by solar observations.

The field notes of this survey and a copy of this plat are on file in the Forest Supervisor's Office at Rhinelander, Wisconsin.

CORNERS RECOVERED OR RESTORED1. Township Corner to T.36-37N., R.11-12E.

Corner position found marked by Oneida County brass cap stamped to identify corner set by Vernon Maine in 1935.

Corner References:

Hemlock	18"	N.50°E.	33.65 feet
Sugar Maple	8"	S.69°E.	13.84 feet
Yellow Birch	10"	S.81°W.	17.19 feet
Sugar Maple	7"	N.20°W.	51.40 feet
Steel Sign Post		East	3.40 feet

2. Section Corner to Sections 31, 32, 5, and 6, T.36-37N., R.12E.

Corner position found marked by a Forest County Monument stamped by R.L.S. 498, Phillip Hansen.

Corner References:

Sugar Maple	5"	N.28°E.	29.56 feet
Sugar Maple	12"	S.51°E.	10.96 feet
Sugar Maple	14"	S.48°W.	14.67 feet
Sugar Maple	5"	N.34°W.	5.71 feet
Steel Sign Post		West	1.70 feet

3. Section Corner to Sections 19, 24, 25, and 30, T.37N., R.11-12E.

Corner position found marked by Forest Service brass cap stamped to identify corner. Certificate on file, dated February 13, 1968.

Corner References:

Spruce	3"	N.56°E.	37.21 feet
Tamarack	2"	S.49°E.	75.60 feet
Spruce	4"	S.82°W.	87.64 feet
(NEW) Black Spruce	3"	S.31°E.	26.73 feet
Wood Post with Monument Sign		East	1.35 feet

Stock No. 26273

Sheet 3 of 4

4. Quarter Corner to Sections 31 and 6, T.36-37N., R.12E.  
 Corner position found marked by a Forest County Monument stamped to identify corner set by Phillip Hansen, R.L.S. 498.  
 Corner References:

Hemlock	12"	N.29°E.	39.81 feet
Yellow Birch	11"	S.40°E.	16.57 feet
Sugar Maple	12"	N.15°W.	18.02 feet
Steel Sign Post	7'	East	2.00 feet

5. Quarter Corner to Sections 36 and 31, T.37N., R.11-12E.  
 Corner position found marked by 2" diameter iron pipe with brass cap stamped to identify corner set by H. C. Lawrence, a surveyor for Consolidated Paper Company.  
 Corner References:

Cedar	11"	N.35°W.	18.15 feet
Cedar	9"	S.58°E.	20.98 feet
Hemlock	20"	S.20°W.	121.27 feet
Steel Sign Post	7'	North	2.04 feet

6. Meander Corner to Sections 25 and 30, T.37N., R.11-12E., on North Side of Atkins Lake.  
 Corner position was restored by single proportionate measure.  
 Corner References:

Tamarack	5"	S.48°E.	41.34 feet
Tamarack	5"	S.54°W.	78.89 feet
Tamarack	6"	N.1°W.	48.03 feet
Steel Sign Post		South	2.05 feet

7. Meander Corner to Sections 31 and 36, T.37N., R.11-12E., on South Side of Atkins Lake.  
 Corner position was restored by single proportionate measure.  
 Corner References:

Tamarack	4"	S.29°E.	97.25 feet
Black Spruce	4"	S.31°W.	66.34 feet
Black Spruce	3"	N.85°W.	27.60 feet
Steel Sign Post		North	1.55 feet

8. Meander Corner to Sections 25 and 36, T.37N., R.11E., on West Side of Atkins Lake.  
 Corner position found marked by a brass cap on a 2" pipe set by Vernon Maine in 1938, with a rotted, scribed Cedar post and original BT remains.

CORNER ESTABLISHED

1. South One-Sixteenth to Sections 31 and 36, T.37N., R.11-12E.  
 Corner position found marked by a scribed 6" x 6" Cedar post set by H. C. Lawrence in 1958.  
 Corner References:

Sugar Maple	15"	N.31°E.	12.40 feet
Basswood	10"	S.50°E.	36.43 feet
Hemlock	14"	N.77°W.	34.36 feet
Steel Sign post		North	1.90 feet

Stock No. 26273

Sheet 4 of 4

SURVEYOR'S AFFIDAVIT

State of Wisconsin  
Counties of Forest and Oneida ] SS

I, Milo E. Stefan, Cadastral Surveyor, U. S. Forest Service and a registered surveyor in the State of Wisconsin, hereby certify that I have surveyed Sections 30 and 31, Township 36-37 North, Range 11-12 East, Fourth Principal Meridian, State of Wisconsin.

The plat map and the notes herewith are a correct representation of the land surveyed. I have surveyed said sections in accordance with the rules for survey of the public lands and with the statutes of the State of Wisconsin.



Milo E. Stefan  
Cadastral Surveyor, U. S. Forest Service  
R.L.S., State of Wisconsin  
Certificate S-1558

Plat Ready For Filing: Dale D. Stoege

Date of Survey: 1985

CERTIFIED LAND CORNER RESTORATION

Index No. **A-25**

State of Wisconsin

County of Oneida } ss.

I, Phillip T. Hansen, do hereby certify that on the 6th day of December, 1974, I found evidence of the Section corner of 1-36-31-6 Township 36-37 North, Range 11 and 12 East, Fourth Principal Meridian, as described hereon; and that from this evidence I established a new monument and accessories as described hereon to perpetuate the original location of this corner.

Resident witnesses:

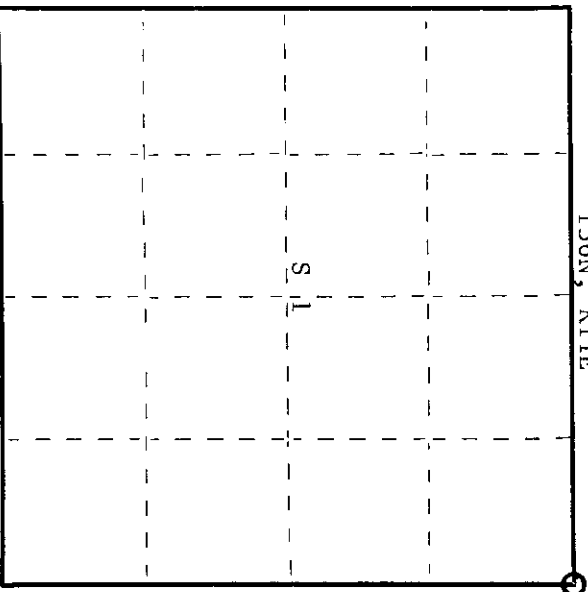
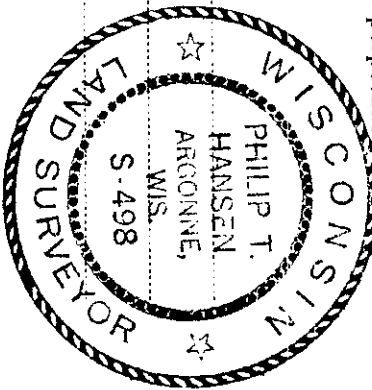

○ = Corner monument restored.

History of original corner establishment:  
Original corner established by William E. Dougherty, Government Deputy Surveyor, in 1859.

Yellow birch 14"	N70W	41 links
Elm 16"	N50E	28 links
Yellow birch 16"	S30E	48 links
Sugar maple 18"	S50W	8 links

Resurvey by V.M. Maine, County Surveyor, replaced recovered original corner with iron pipe with brass cap; good condition.  
Retracement survey by H.C. Lawrence - 1950 - placed a new 4" hemlock post at corner.

Description of corner evidence found:  
Recovered a 2-1/2" iron pipe with screw-on brass cap with mound of rock piled around it. 6" ironwood with Wisconsin Conservation Department location tag and U.S. Forest Service tag attached to it. Brass cap stamped as follows:

Recovered BT's - Elm stump	N50E	28 links badly decomposed	T37, R11
Hemlock 20"	N51E	49 links scribed S31 BT	S36   S31
			S1   S6
			R12

Description of monument and accessories I established to perpetuate the original location of this corner.  
Blazed and scribed new BT - Yellow birch 11" S82W 25 1/2 links scribed S1 BT

Dated at Rhineland, Wis., this 30th day of December, 1974.

Signature Phillip T. Hansen Title Registered Land Surveyor Registration No. S-498  
(County Surveyor, Registered Land Surveyor, or other duly authorized official)

Office of Register of Deeds, County of Oneida.  
Instrument was filed in this office for record on the 1st day of October, 1975 at 3:00 o'clock P. M.

Doris Verage Fuchs  
(Register of Deeds)

By: \_\_\_\_\_ Deputy