

At _____ O'Clock _____ M

U.S. PUBLIC LAND SURVEY MONUMENT RECORD

Note: This form is intended and designed to fulfill all requirements of the Wisconsin Administrative Code, Chapter A-E 7.08 U.S. Public Land Monument Record (3)(a)(b)(c)(d)(e)(f)(g)(h)(i). An additional sheet may be added if necessary to conform with said requirements.

(a) CORNER LOCATION:

East 1/4 corner of Section 11
Township 38 North
Range 4 East
Town of Minocqua
County of Oneida

O. C. COORDINATES

North: 222980.8193
East: 128602.4454
Control Station: O. C. 295
Latitude: 45° 46' 27.13998 N
Longitude: 89° 56' 42.55785" W
Datum: NAD - 83 (91)
Method: Direct RTK - GPS

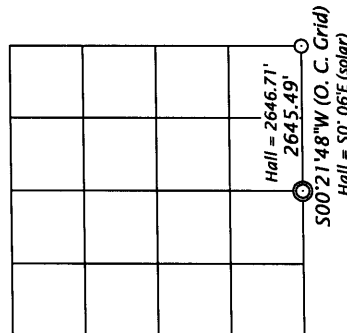

(b) HISTORY OF ORIGINAL CORNER ESTABLISHMENT

SECTION 11

Original Surveyor: Alex. Anderson, Deputy Surveyor
Date of Survey: Commenced April 26, 1865
Completed May 8th, 1865

Original B.T.'s: Spruce 6" S 4°W, 6 links (3.96 feet)
Tamarac 6" N66°E, 20 links (13.20 feet)

(f)(g)(h) DESCRIPTION OF MONUMENT FOUND AT THIS CORNER AND IF IT WAS ACCEPTED, STATE ALL EVIDENCE (MATERIAL, TESTIMONIAL, OCCUPATIONAL, PLATS, RECORDS, OTHER MONUMENTS) USED AS A BASIS FOR ESTABLISHING LOCATION. IF NOT ACCEPTED OF IF NOTHING WAS FOUND, STATE EVIDENCE USED AS BASIS FOR ESTABLISHING LOCATION. IF REESTABLISHED THROUGH LOST CORNER PROPORTIONATE METHODS, INDICATE ALL MONUMENTS, DISTANCES AND DIRECTIONS USED TO ESTABLISH. INDICATE TYPE OF MONUMENT AND SIGN POST FOUND OR SET.

December 2nd, 1937 through June 9, 1938 - Ray H. Hall, Deputy County Surveyor, CC Camp 75-S Survey Book 9, page 20, Diagram on page 60 - @ 40.099 chains south of Orig. Cor. 1-2-11-12 and .464 chains right angle west of random to original 1/4 S. set new post and Var. 0° {Tam. 3" N44°E, 0.453 ch. (29.90 feet) and Tam. 2" S6°W, 0.173 ch. (11.42 feet)}.

April 16, 2009 - James D. Rein, RLS #1234 - Recovered 2 1/2" dia. x 48" long wood post, the rotted top 6" exposed above swamp level. The point of the post, in excellent condition is scribed "HALL". I accept the post as being a perpetuation of the original corner position and replace it with a capped 2.4" o.d. x 60" long aluminum monument extending 16" above ground in mixed tamarack and black spruce swamp. The corner is referenced by both of Hall's living bearing trees as shown below in the plan view. Made new bearing trees and set a white poly stake to reference the corner as shown in the plan. The corner position is harmonious with Hall's measurement to the northeast corner of Section 11.

(c)(d)(e) PLAN VIEW OF CORNER WITH TIES TO AT LEAST 4 WITNESS MONUMENTS. IF IN DISAGREEMENT WITH PREVIOUSLY ESTABLISHED CORNER, SHOW THE DISTANCE BETWEEN THE TWO CORNERS AND ALSO INDICATE THE TIES TO THE DISPUTED CORNER.

Bearings Magnetic
0° Dec.



SCALE 1" = 20'

NOTE: Bearing tree distance measurements were made to aluminum nails set in the root crown on the side of the tree.

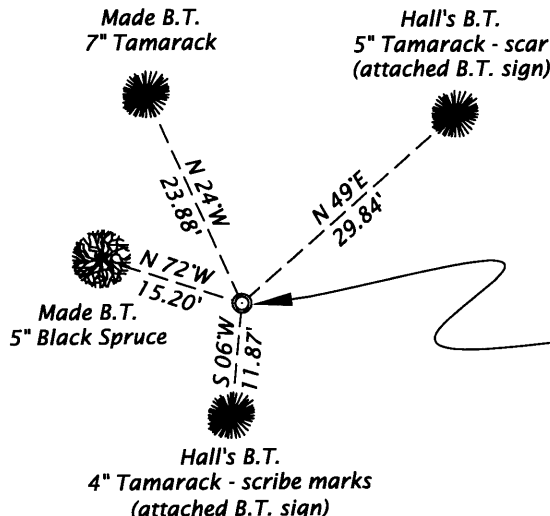

Recovered 2 1/2" dia. x 48" long post, top exposed 6" rotted, excellent point scribed "HALL". I replace the post with a capped 2.4" dia. x 60" long aluminum monument extending 16" above ground in a mixed tamarack and black spruce swamp. Set a white poly stake 0.2' West.

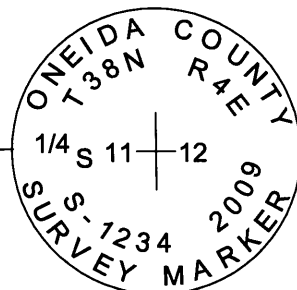

(i) I, JAMES D. REIN, REGISTERED LAND SURVEYOR NO. S-1234 HEREBY CERTIFY THAT THE CORNER LOCATION ON THIS RECORD WAS DETERMINED BY ME OR UNDER MY DIRECTION AND CONTROL AND THAT THIS U.S. PUBLIC LAND SURVEY MONUMENT RECORD IS CORRECT AND COMPLETE TO THE BEST OF MY KNOWLEDGE AND BELIEF.

James D. Rein
SIGNATURE

4/28/09
DATE 3804112000

