

CERTIFIED LAND CORNER RESTORATION

State of Wisconsin }
County of Oneida } ss.

I Terry T. Golding, do hereby certify that on the 5th day of October, 1981, I found evidence of the west one-quarter corner of section 7 Township 38 North, Range 5 East, Fourth Principal Meridian, as described hereon; and that from this evidence I established a new monument and accessories as described hereon to perpetuate the original location of this corner:

Description of original monument and accessories and subsequent restorations:

September 17, 1860 - Alfred Millard, deputy surveyor, set wood post, witnessed by a 15" W. Pine, S51°E, 26links (17.16 feet) and by a 12" Y. Pine, N8°W, 37 links (24.42 feet).

Description of corner evidence found:

2" dia. iron pipe with a 3" dia. brass cap stamped Orig. 1/4 S, up 7", with a 4" x 4" scribed wood post up 3 1/2', 4" x 4" wood post rotted off and a 4" x 4" wood post with a Nepco tag, rotted and down.
Rotted pine stump, S51°E, 17.1' ±, up 3 1/2'
Rotted pine stump, N8°W, 24.4' ±, up 2'

Description of monument and accessories I established to perpetuate the location of this corner:

Made bearing trees (scribed) with a P.K. nail set in lower blaze as follows:
9" Oak, S45°W, 15.46'
25" W. Pine S65°E, 47.58'
8" W. Birch, N70°W, 18.10'



Corner monument restored
original corner - Robert & Linda
Oneida, Wisconsin

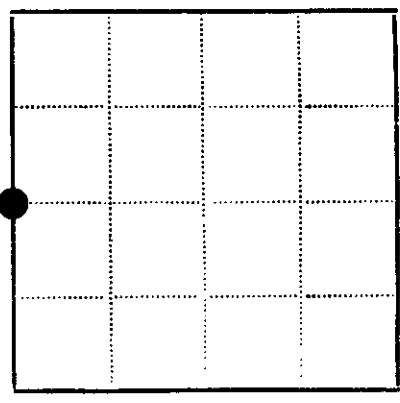

● - Corner monument restored
□ -

Resident witnesses.....

Dated at Minocqua Wisconsin, this 18 day of May 1982

Signature Terry T. Golding Title Reg. Land Surveyor
(County Surveyor, Registered Land Surveyor, or other duly authorized official)

Surveyors Registration No. S-1468

Office of Register of Deeds County of Oneida

I hereby certify that the within instrument was filed in this office for record on the 17th day of September 1982 and was filed in Book No. Page No. of County Records.

Signature Lois Verage Kucha Title Register of Deeds

Township....., Range....., Section....., Index No....., Page No.....

3804122000

U. S. PUBLIC LAND SURVEY MONUMENT RECORD

Note: This form is intended and designed to fulfill all requirements of Wisconsin Administrative Code, Chapter A-E 7.08 U.S. Public Land Survey Monument Record(3)(a)(b)(c)(d)(e)(f)(g)(h)(i). An additional sheet may be added if necessary to conform with said requirements.

(a) Corner location: Township 38 North
Range 4 East

Town of Minocqua

Oneida County, Wisconsin

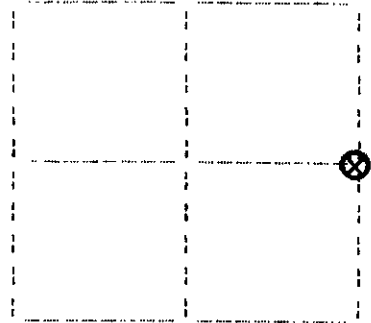

Section 12

(b)(f)(g)(h) Description of monument found at this corner and if it was accepted, state all evidence (material, testimonial, occupational, plats, records, other monuments) used as a basis for accepting. If not accepted or if nothing was found, state evidence used as basis for establishing location. If reestablished through lost corner proportionate methods, indicate all monuments, distances and directions used to establish. Indicate type of monument found or set and sign post.

September, 1860: Alfred Millard notes the following: 40.00 set 1/4 sec. post: w.pine 15 S51°E, 26 lks.; y.pine 12 N8°W, 37 lks.

October 25, 1933: Hall page 155 notes the following: orig. west 1/4. orient transit on random (N0-01E) mag. var. 2°30' E. bearings: orig. S53-20E, .26; new: w.pine 8" S40-10W, .129; do 10" S62-35E, .733.

July 26, 1990: I found and accepted a 3" dia. iron capped iron post stamped as shown below. From which: a pine stp. with axe marks bears N2°W, 25.0 feet; a pine stp. bears S53°E, 17.5 feet; a stp. hole bears S42°W, 8.7 feet; a PK nail found in a w.birch (dead) 7" bears N67°W, 18.05 feet; a PK nail found in an oak 11" bears S42°W, 15.50 feet; a PK nail found in a w.pine 26" bears S58°E, 47.83 feet; a nail set in a w.pine 5" bears N64°E, 17.34 feet; a nail set in a w.pine 5" bears N81°W, 46.72 feet; a plastic sign post was set North, 1 foot.

(c)(d)(e) Plan view of corner with ties to at least four witness monuments. If in disagreement with previously established corner, show the distances between the two corners and also indicate the ties to the disputed corner.

1. PK nail in oak 11"
S42W, 15.50 feet.
2. PK nail in w.pine 26"
S58E, 47.83 feet.
3. nail in w.pine 5"
N64E, 17.34 feet.
4. nail in w.pine 5"
N81W, 46.72 feet.

(not to scale)

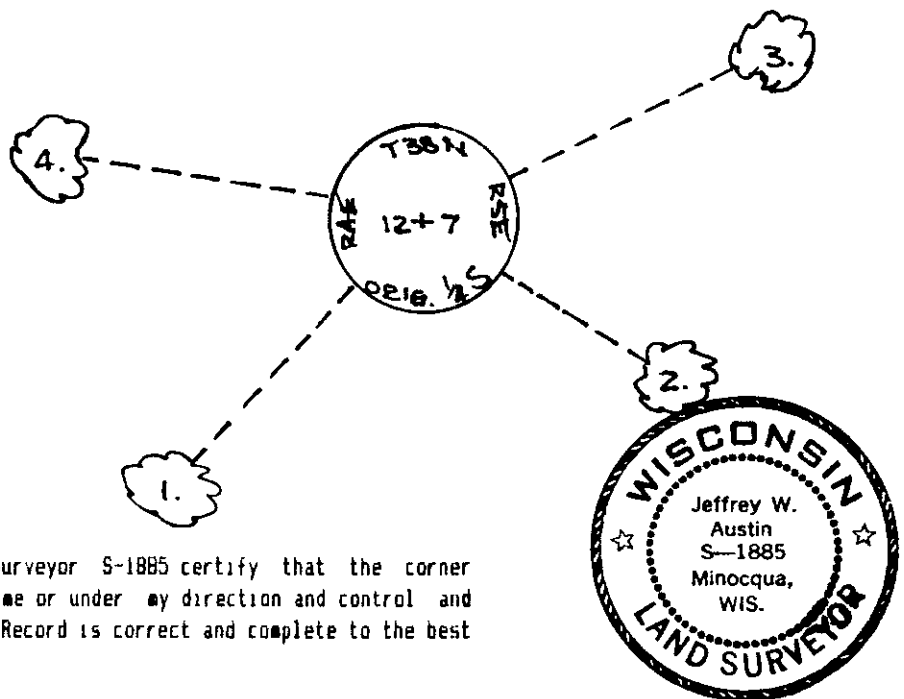

I, Jeffrey W. Austin, Registered Land Surveyor S-1885 certify that the corner location on this record was determined by me or under my direction and control and that this U.S. Public Land Survey Monument Record is correct and complete to the best of my knowledge and belief.

Signature: *Jeffrey W. Austin* Date: August 17, 1990

Index no. G-25

3804122000

G 25