

U. S. PUBLIC LAND SURVEY MONUMENT RECORD

Note: This form is intended and designed to fulfill all requirements of Wisconsin Administrative Code-Chapter A-E 7.08 U. S. Public Land Survey Monument Record (3)(a)(b)(c)(d)(e)(f)(g)(h)(i). An additional sheet may be added if necessary to conform with said requirements.

(a) CORNER LOCATION: State Plane Coordinates
S 1/4 corner of Sec. 15
 Township 38 North
 Range 4 East
 Town Minocqua County of Oneida

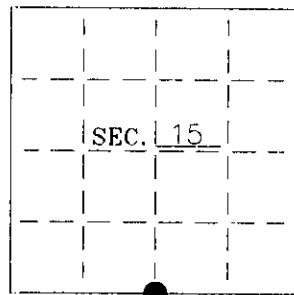

(b) HISTORY OF ORIGINAL CORNER ESTABLISHMENT: Original B.T.'S
 Original Surveyor: Alex Anderson
 Date of Survey: Commenced 1865 Tamarack 8" S40°W, 12 lks(7.92')
 Completed 1865 Tamarack 8" N20°E, 25 lks(16.5')

(b)(f)(g)(h) Description of monument found at this corner and if it was accepted—state all evidence (material—testimonial—occupation—plats—records—other monuments) used as a basis for accepting. If not accepted or if nothing was found state evidence used as basis for establishing location. If reestablished through lost corner proportionate methods indicate all monuments—distances and directions used to establish. Indicate type of monument and sign post found or set.

1965— On a drawing by W.H. Stuth(O-I), dated 8/18/86, he shows a corner by others at the S1/4 corner location.

2001— I found a 4" Cedar Post in tamarack swamp adjacent to a rotted post lying down. I recovered the point of the rotted post, in good condition. I also recovered two possible original bearing trees, now stumps. I replaced the post point with an Oneida County Aluminum Monument and made four new BT's as shown below.

(c)(d)(e) Plan view of corner with ties to at least 4 witness monuments. If in disagreement with previously established corner—show the distances between the two corners and also indicate the ties to the disputed.

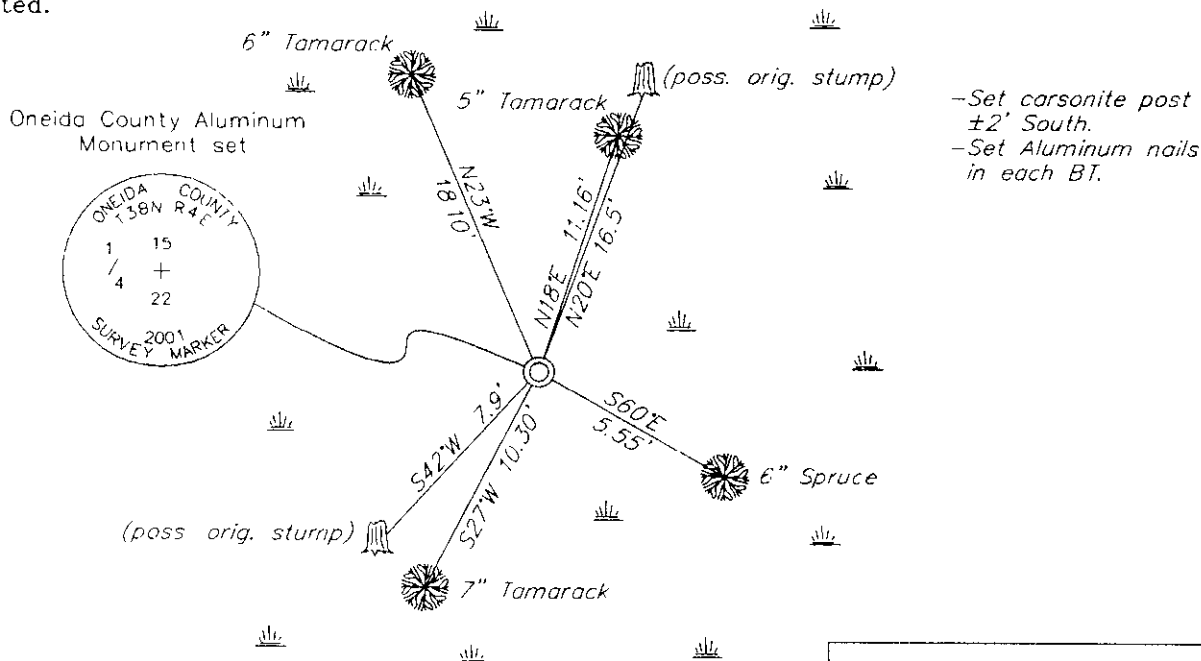

(i) I Charles E. Winkler S-1431
 hereby certify that the corner location on this record was determined by me or under my direction and control and that this U.S. Public Land Survey Monument Record is correct and complete to the best of my knowledge and belief.

Charles E. Winkler 3/5/2002
 Signature Foltz and Associates, Inc. Date

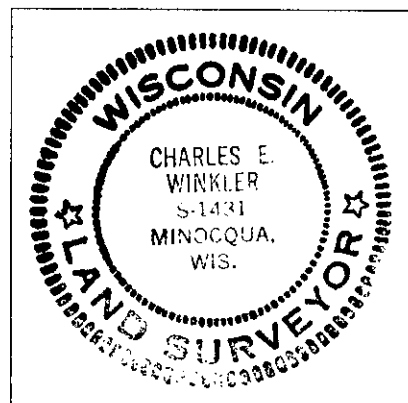

INDEX NO. N 15

38 04 15 00 20