

U.S. PUBLIC LAND SURVEY MONUMENT RECORD

Note: This form is intended and designed to fulfill all requirements of Wisconsin Administrative Code, Chapter A-E 7.08 U.S. Public Land Survey Monument Record (3) (a) (b) (c) (d) (e) (f) (g) (h) (i). An additional sheet may be added if necessary to conform with said requirements.

(a) Corner location: Township 38 North

Range 4 East/West

Town/City/Village MINOCQUA

County ONEIDA

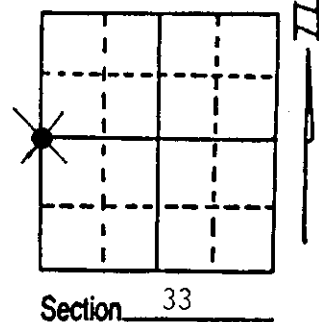

(b) (f) (g) (h) Description of monument found at this corner and if it was accepted, state all evidence (material, testimonial, occupational, plats, records, other monuments) used as a basis for accepting. If not accepted or if nothing was found, state evidence used as basis for establishing location. If reestablished through lost corner proportionate methods, indicate all monuments, distances and directions used to establish. Indicate type of monument found or set and sign post.

Original Government Survey performed by Alexander Anderson, April & May, 1865. Post set. Cedar 10", S70°W, 8 Links; Do (?) 7", S36°E, 18 Links.

In 1961, W.H. Stuth, working for NEPCO, found no evidence of corner.

On August 11, 1994, I calculated a straight line split for this corner. Traversed to calculated area, on old cut line. Someone else must have looked for corner too. Searched 200 foot radius area. Found no evidence of original corner. Set 7 foot long, driveable aluminum monument in wet area. Corner falls on North - South paint line, 36 feet South of tree painted on 4 sides. Original Notes do not mention corner being set in wet area. There are many large dead hardwood trees in this wet area. I think that when the logging road was built, they filled in the natural drainage way, and this area floods in spring. Left corner stick up about 2 feet, set fiberglass warning sign on North side. Painted everything yellow. Set witness corners on high ground.

(c) (d) (e) Plan view of corner with ties to at least 4 witness monuments. If in disagreement with previously established corner, show the distances between the two corners and also indicate the ties to the disputed corner.

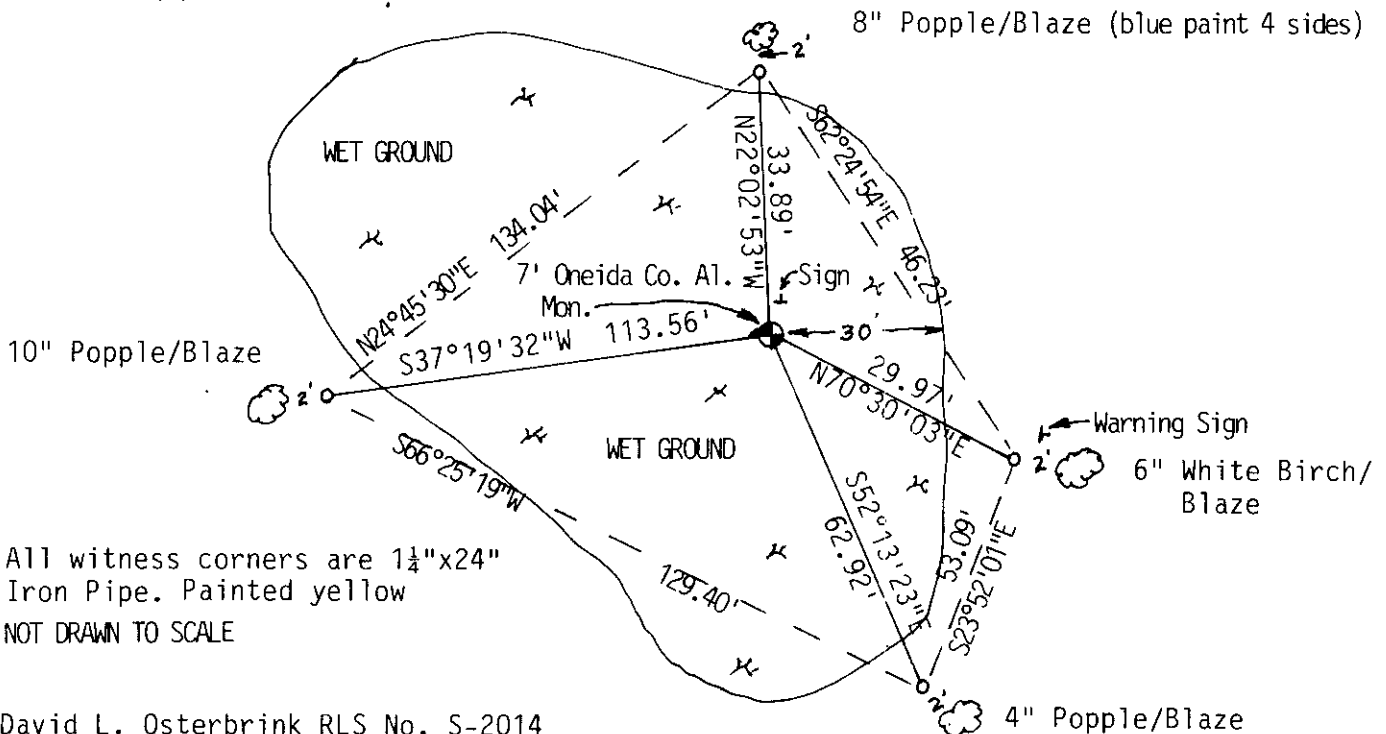

All witness corners are 1 1/4"x24" Iron Pipe. Painted yellow
NOT DRAWN TO SCALE

(i) I, David L. Osterbrink RLS No. S-2014
(type or print name) certify that the corner location on this record was determined by me or under my direction and control and that this U.S. Public Land Survey Monument Record is correct and complete to the best of my knowledge and belief.

David L. Osterbrink
Signature

9-21-94
Date



Index No. X-9

Existing NW Cor. Sec. 33

Straight lined between existing NW & SW Corners, split distance, set Monument.

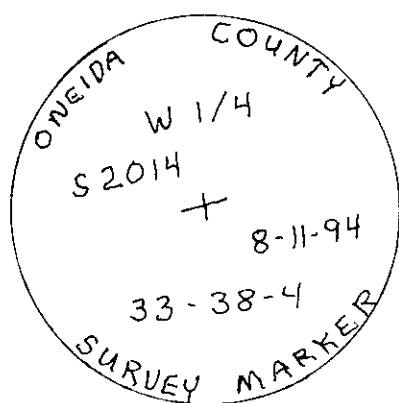

Set 7' Driveable Oneida County Monument

2617.98'

S 1° 09' 36" W

5235.96'

2617.98'

Existing SW Cor. Sec. 33

REGISTER OF DEEDS OFFICE
ONEIDA COUNTY WIS

FILED
OCT 19 1994

At _____ O'Clock _____ M
THOMAS H. LEIGHTON
REGISTER OF DEEDS