

U.S. PUBLIC LAND SURVEY MONUMENT LOCATION RECORD

Recorders Data

CORNER: West 1/4 SECTION: 1 TOWNSHIP 38 NORTH RANGE 5 EAST/WEST

FOR M.C. CORNER INDICATE: NAME OF WATERWAY N/A SECTION LINE N/A

~~(CITY)~~(VILLAGE)(TOWN) OF: Minocqua COUNTY OF: Oneida

Description of monument found or placed and all other evidence used as a basis for monument location; including all monuments and related measurements required if the corner location is reestablished by lost corner proportionate methods. Also indicate name of original surveyor, survey date, corner monument set and established bearing trees, witness or reference monuments with ties from available records.

Found and accepted a 4" dia. iron pipe monument with concrete filled and marked cap 14" above grade at this corner location, approximately 28' North of the centerline of existing gravelled roadway bearing N70°E +/-.

In 1863, Anderson/GLO set a wood post as the corner and marked OBTs, a 20" Py N77°W 58 lks and a 24" Py S19°E 54 lks, all of which are now obliterated.

In 1997, Boettcher of Eagle Landmark Surveying, found and accepted a 4" dia. concrete filled iron pipe at this corner location per his Plat of Survey filed as C-1377 in Oneida County survey records; no BTs noted.

This recovery completed May 21, 1998; there were no witness other than passer-bys.

I set a standard white poly 'T' marker post 7" North of the corner monument.

Note: No suitable trees for BT usage northerly of monument at corner.

Plan view map of monument location with bearing and distance ties to a minimum of four(4) described witness or reference monuments of concrete, natural stone, iron, live bearing trees or equivalent material. If applicable, also show a minimum of two(2) bearing and distance ties to any other monument found and not accepted; including the bearing and distance from the accepted monument. Indicate the basis for bearings of reference ties if not referenced to magnetic north.

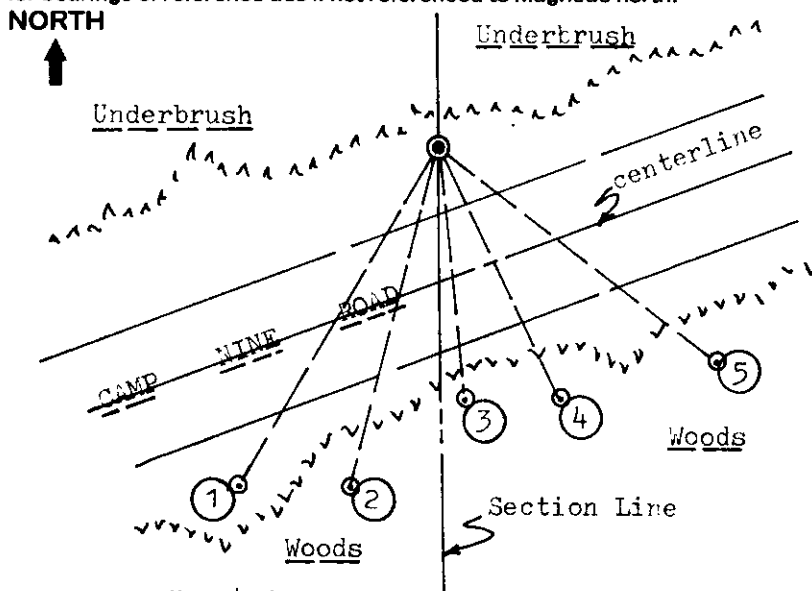

WITNESS MONUMENT TIES:

- ① 1" dia. by 24" long iron pipe set with standard Reference Mark cap plug in top 1" above grade S31°W 81.83'.
- ② New BT 24" Pw S15°W 73.24'.
- ③ Older BT of unknown record S06°E 53.02' with upper and lower face blazes open with sribing; I nailed a standard yellow aluminum BT sign to North face; 14" Spruce.
- ④ New BT 16" Spruce S26°E 57.94'.
- ⑤ New BT 22" Pr S52°E 73.21'.

SCALE: 1" = 40'

Unless otherwise indicated, all bearing tree ties are to a .25" dia. by 2.5" long PK nail with a 1.25" dia. steel washer driven into unblazed right face and a .25" dia. by 2.5" long PK nail with a 2" dia. steel washer stamped 'BT' is also driven into unblazed face of bearing tree at DBH; the basis for measured bearings is magnetic to nearest degree and all tie distances are horizontal measure to nearest 1/100th feet.

LAND SURVEYOR CERTIFICATION:

I, William C. Rohde, hereby certify that I am a duly licensed Professional Land Surveyor in Wisconsin, that this USPLS monument location was determined by me or under my direction and control, and that this U.S. Public Land Survey Monument Location Record is true and correct to the best of my knowledge and belief.

William C. Rohde Date: 5-23-98
Signature

This form is intended to fulfill requirements of Chapter A-E 7.08 (3)(a)(b)(c)(d)(e)(f)(g)(h)(i) U.S. Public Land Survey Monument Location Record, Wisconsin Administrative Code. Use reverse side for geodetic location data and/or continuation purposes.

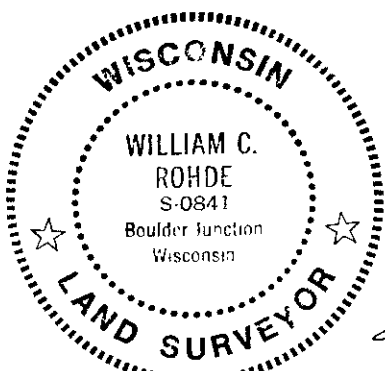

RLS SEAL

SHEET NO. 1 OF 1

	1		

SECTION LOCATION MAP

INDEX NO. C 21
3805022000

INDEX NO. C 21