

U.S. PUBLIC LAND SURVEY MONUMENT RECORD

Note: This form is intended and designed to fulfill all requirements of Wisconsin Administrative Code, Chapter A-E 7.08 U.S. Public Land Survey Monument Record (3)(a-i).

(a) CORNER LOCATION
 1/4 Cor. of Secs. 23 & 24
 Township 38 North
 Range 5 East of the 4th P.M.
 Town of Minocqua
 County of Oneida

WISCRS - Oneida County
 N: 212,416.78 USft
 E: 160,535.70 USft
 Datum: NAD 83(2011)
 GNSS Method: RTN - Direct
 GNSS Control: WISCORS VRS

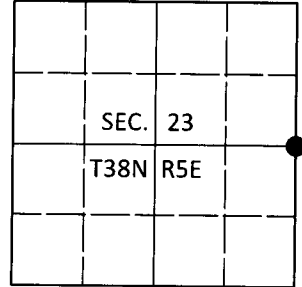

(b) HISTORY OF ORIGINAL CORNER ESTABLISHMENT

Original Surveyor: Alexander Anderson

Original Accessories:

Date of Survey Commenced: Oct. 6, 1863
 Completed: Oct. 13, 1863

Tamarack 6" N55°E, 18 lks.
 Tamarack 10" S46°W, 17 lks.

(b)(f)(g)(h) Description of monument found at this corner and if it was accepted, state all evidence (material, testimonial, occupational, plats, records, other monuments) used as a basis for accepting. If not accepted or if nothing was found, state evidence used as basis for establishing location. If re-established through lost corner proportionate methods, indicate all monuments, distances and directions used to establish. Indicate type of monument and sign post found or set.

Mar. 17, 1934: Notes by Ray Hall in Hall book 1 on pages 175-177 indicate the mile was measured and this corner was determined to be lost but not monumented by Hall.

Aug. 18, 1971: Field notes and work map by Northwoods Surveyors (Northwoods) indicate a 1" diam. iron pipe was set to replace a 3" x 3" wood post that was found. No accessories were found or established by Northwoods. This corner location was used by Northwoods to subdivide Section 24.

Oct. 24, 2018: I found and accepted the monument set by Northwoods, a 1" diam., 30" long galvanized iron pipe. Based on my current and previous measurements, this monument is N69°32'E (Oneida Co. grid), 47.1 ft. from the proportioned location. While I can't substantiate the evidence recovered by Northwoods, I accept their monument to preserve the title lines that resulted from their work in Section 24. In place of the pipe, I set a 2-1/2" diam., 60" long aluminum pipe with a 3-1/4" diam. Oneida Co. aluminum cap projecting 6" above the bog surface. I found or established accessories as shown below. I set a white vinyl sign post bearing North, 0.6 ft.

The coordinate value shown has been verified by at least one of the following methods: 1) comparison to a previously GPS determined published value; 2) the value is the average of two or more GPS observations at a markedly different time; 3) one or more distances were measured back to the GPS observed corner from temporary GPS observed offset locations.

(c)(d)(e) Plan view of corner with ties to at least 4 witness monuments. If in disagreement with previously established corner, show the distances between the two corners and also indicate the ties to the disputed.

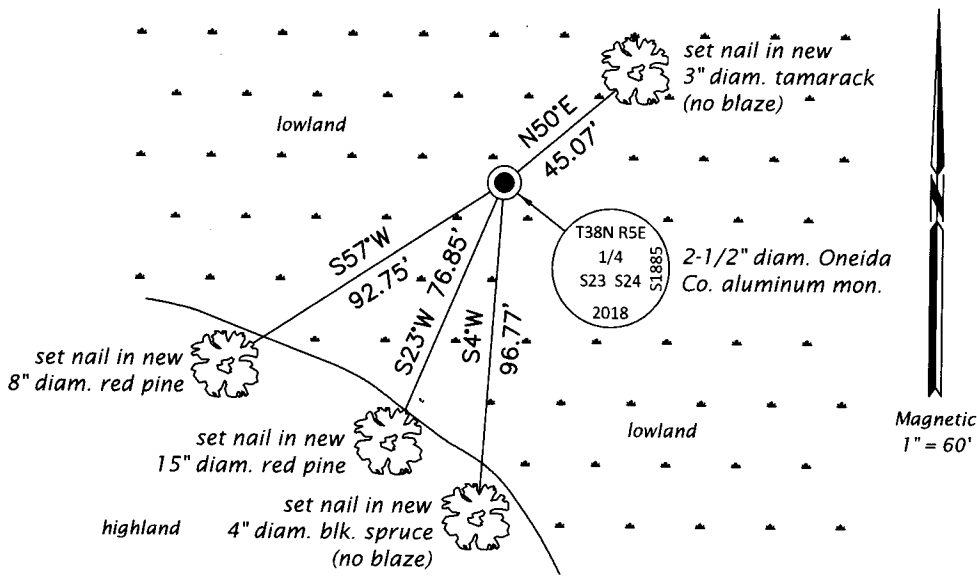

REGISTER OF DEEDS OFFICE
 ONEIDA COUNTY
 FILED

DEC 31 2018

KYLE J. FRANSON
 REGISTER OF DEEDS

(i) I, Jeffrey W. Austin, Professional Land Surveyor No. S-1885, hereby certify that the corner location on this record was determined by me or under my direction and control and that this U.S. Public Land Survey Monument Record is correct and complete to the best of my knowledge and belief.

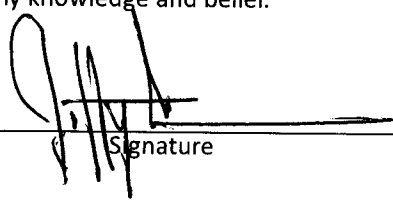
 Signature

20 DEC 2018
 Date