

U.S. PUBLIC LAND SURVEY MONUMENT RECORD

Note: This form is intended and designed to fulfill all requirements of Wisconsin Administrative Code, Chapter A-E 5.02, U.S. Public Land Survey Monument Record (3) (a) (b) (c) (d) (e) (f) (g) (h) (i). An additional sheet may be added if necessary to conform with said requirements.

(a) Corner location: Township 38 North

Range 6 East/West

Town/City/Village HAZELHURST

County ONEIDA

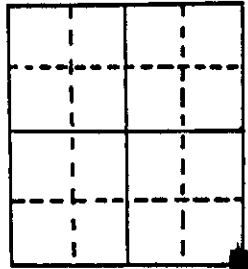

Section 6

(b) (f) (g) (h) Description of monument found at this corner and if it was accepted, state all evidence (material, testimonial, occupational, plats, records, other monuments) used as a basis for accepting. If not accepted or if nothing was found, state evidence used as basis for establishing location. If reestablished through lost corner proportionate methods, indicate all monuments, distances and directions used to establish.

October 1863- Alexander Anderson, Deputy Surveyor - Set post for corner to Sections. Original BTs: W. Pine 18" S74°E, 202 links;
 Birch 5" N34°W, 39 links.

August 1 & 2, 1933- Ray H. Hall, Deputy Surveyor - Search for original SE corner of Section 6. Find only one large W. Pine Stump anywhere near record location. Unable to find any trace of post or of Birch BT.

Dec. 12 1984 - James D. Rein RLS - Found a 5" square concrete monument extending one foot above ground and Northwoods Surveyors Pine Post marked 1970. Existing BTs: 10" Jack Pine (wind blown) Northeast 2 feet, marked "M.B.T." 7" Red Maple N50°-50'W, 28.62 feet; 19" Red Pine N67°-30'E, 48.31 feet.

Made new bearing trees as shown below in plan view.

(c) (d) (e) Plan view of corner with ties to at least 4 witness monuments. If in disagreement with previously established corner, show the distances between the two corners and also indicate the ties to the disputed corner.

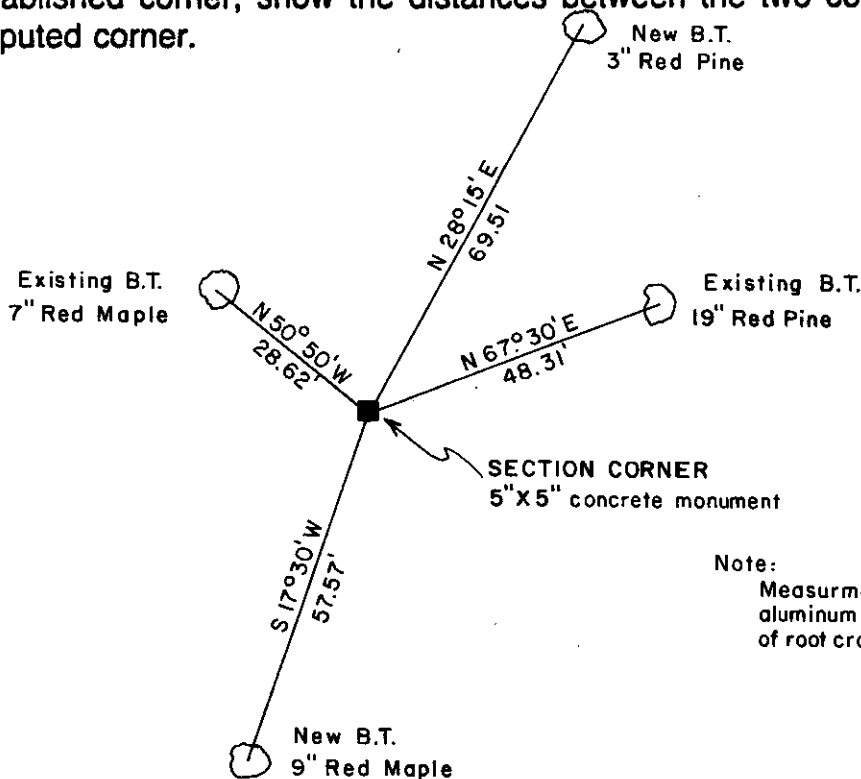

Bearings True



Scale 1" = 30'

Note: Measurements made to an aluminum nail set in center of root crown on side of tree.

(i) I, JAMES D. REIN, Reg. Land Surveyor No. S-1234
 (type or print name) certify that the corner location on this record was determined by me or under my direction and control and that this U.S. Public Land Survey Monument Record is correct and complete to the best of my knowledge and belief.

James D Rein Jan 31st, 1985
 Signature Date

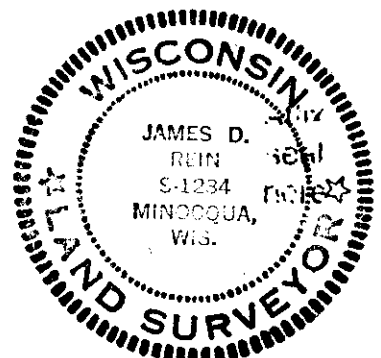

3806060000

Index No. E 2