

U.S. PUBLIC LAND SURVEY MONUMENT RECORD

Note: This form is intended and designed to fulfill all requirements of the Wisconsin Administrative Code, Chapter A-E 7.08 U.S. Public Land Monument Record (3)(a)(b)(c)(d)(e)(f)(g)(h)(i). An additional sheet may be added if necessary to conform with said requirements.

(a) CORNER LOCATION:

Meander Corner between S.10 & S.15
 Township 38 North
 Range 6 East
 Town of Hazelhurst
 County of Oneida

COORDINATES

North: 220178.2155
 East: 181319.5286
 Control Station: O.C. #208
 Latitude: 45°48'16.32024"N
 Longitude: 89°43'24.71396"W
 Datum: NAD 83 (1991) Method: RTK
 Offset

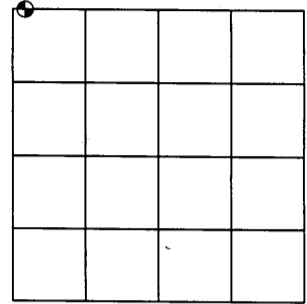

SECTION 15

(b) HISTORY OF ORIGINAL CORNER ESTABLISHMENT

Original Surveyor: Alexander Anderson
 Date of Survey: Commenced - September, 1863
 Completed - October, 1863

Original B.T.'S: White Pine 6" S56°E 11 links
 Fir 8" N52°E 8 links

(f)(g)(h) DESCRIPTION OF MONUMENT FOUND AT THIS CORNER AND IF IT WAS ACCEPTED, STATE ALL EVIDENCE (MATERIAL, TESTIMONIAL, OCCUPATIONAL, PLATS, RECORDS, OTHER MONUMENTS) USED AS A BASIS FOR ESTABLISHING LOCATION. IF NOT ACCEPTED OF IF NOTHING WAS FOUND, STATE EVIDENCE USED AS BASIS FOR ESTABLISHING LOCATION. IF REESTABLISHED THROUGH LOST CORNER PROPORTIONATE METHODS, INDICATE ALL MONUMENTS, DISTANCES AND DIRECTIONS USED TO ESTABLISH. INDICATE TYPE OF MONUMENT AND SIGN POST FOUND OR SET.

December 9th, 1944 - E.F. Kowalke, surveyor, per notes in fieldbook No. 2 page 50, filed at Wilderness Surveying Inc. office indicates "M.C. 3.25 Set Iron pipe and marked W.P. 10" East 10.7 ft"

March 26th, 1968 - L.W. Scott, surveyor, on map number B 5942 filed and recorded at the Onieda County Land Records Office indicates an "I.P. M.C."

April 3rd, 2002 - James D. Rein, RLS No. 1234, search for evidence of corner and find 20" White Pine with a good scar at the base believed to be Kowalke's B.T. I reestablish the M.C. using Kowalke's bearing and distance to the B.T. and set a capped aluminum monument and accessories as shown in plan.

(c)(d)(e) PLAN VIEW OF CORNER WITH TIES TO AT LEAST 4 WITNESS MONUMENTS. IF IN DISAGREEMENT WITH PREVIOUSLY ESTABLISHED CORNER, SHOW THE DISTANCE BETWEEN THE TWO CORNERS AND ALSO INDICATE THE TIES TO THE DISPUTED CORNER.

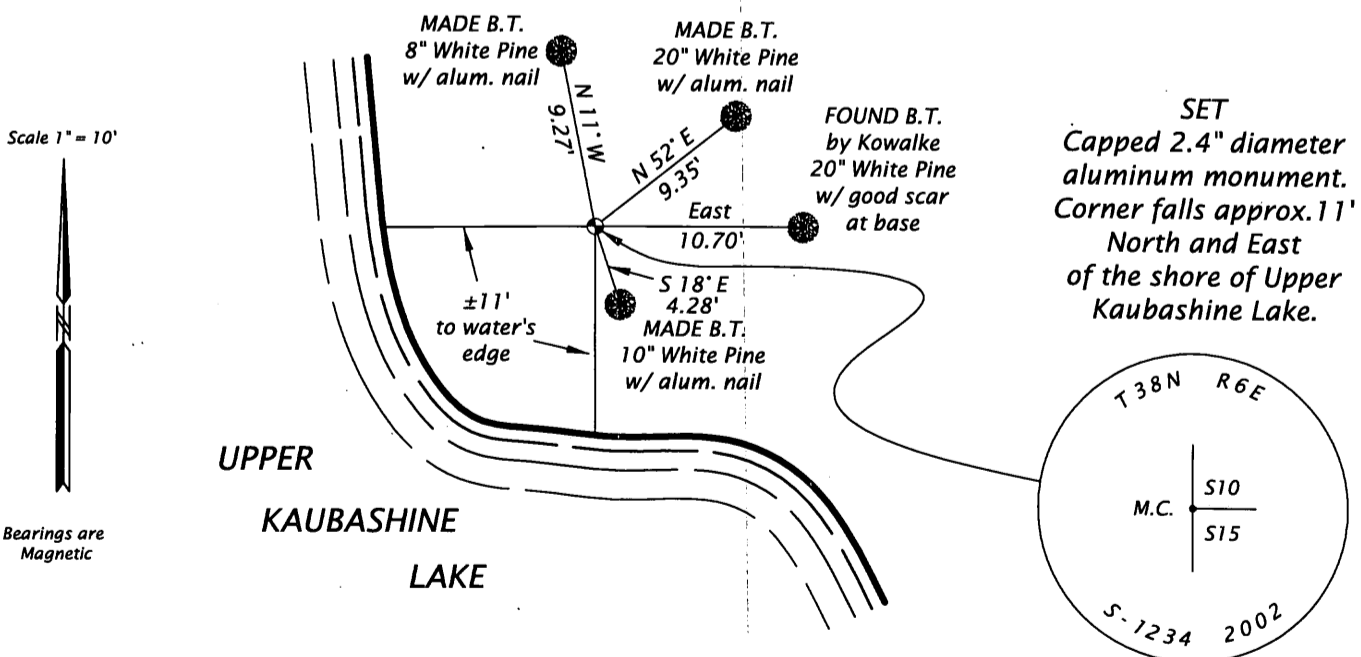

(i) I, JAMES D. REIN, REGISTERED LAND SURVEYOR NO. S-1234 HEREBY CERTIFY THAT THE CORNER LOCATION ON THIS RECORD WAS DETERMINED BY ME OR UNDER MY DIRECTION AND CONTROL AND THAT THIS U.S. PUBLIC LAND SURVEY MONUMENT RECORD IS CORRECT AND COMPLETE TO THE BEST OF MY KNOWLEDGE AND BELIEF.

SIGNATURE

4/03/02
 DATE 3806100038



INDEX NO. S-13/14

REGISTER OF DEEDS OFFICE
ONEIDA COUNTY, WIS.

FILED
JUN 4 2008

At _____ O'Clock _____ M
THOMAS H. LEIGHTON
REGISTER OF DEEDS