

U.S. PUBLIC LAND SURVEY MONUMENT RECORD

Note: This form is intended and designed to fulfill all requirements of Wisconsin Administrative Code, Chapter A-E 7.08 U.S. Public Land Survey Monument Record (3)(a)(b)(c)(d)(e)(f)(g)(h)(i). An additional sheet may be added if necessary to conform with said requirements.

(a) CORNER LOCATION: State Plane Coordinates
 E 1/4 corner of Sec. 17 X _____
 Township 38 North Y _____
 Range 6 East Datum Base _____
 Town/City Hazelhurst County of Oneida

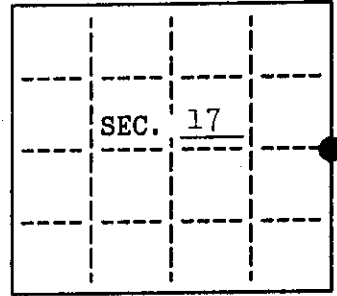

(b) HISTORY OF ORIGINAL CORNER ESTABLISHMENT
 Original Surveyor: Alexander Anderson Original B.T.'S
 Date of Survey: Commenced Sept. 1863 W.Pine 24 N37°W, 39
 Completed Oct. 1863 No other near.

(b)(f)(g)(h) Description of monument found at this corner and if it was accepted, state all evidence (material, testimonial, occupational, plats, records, other monuments) used as a basis for accepting. If not accepted or if nothing was found, state evidence used as basis for establishing location. If reestablished through lost corner proportionate methods, indicate all monuments, distances and directions used to establish. Indicate type of monument and sign post found or set.

See reverse...

REGISTER OF DEEDS OFFICE
 ONEIDA COUNTY, WIS.

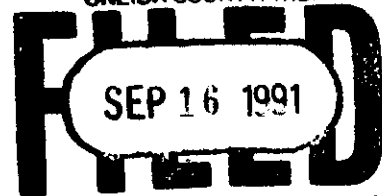

At _____ O'Clock _____ M
THOMAS H. LEIGHTON
 REGISTER OF DEEDS

(c)(d)(e) Plan view of corner with ties to at least 4 witness monuments. If in disagreement with previously established corner, show the distances between the two corners and also indicate the ties to the disputed.

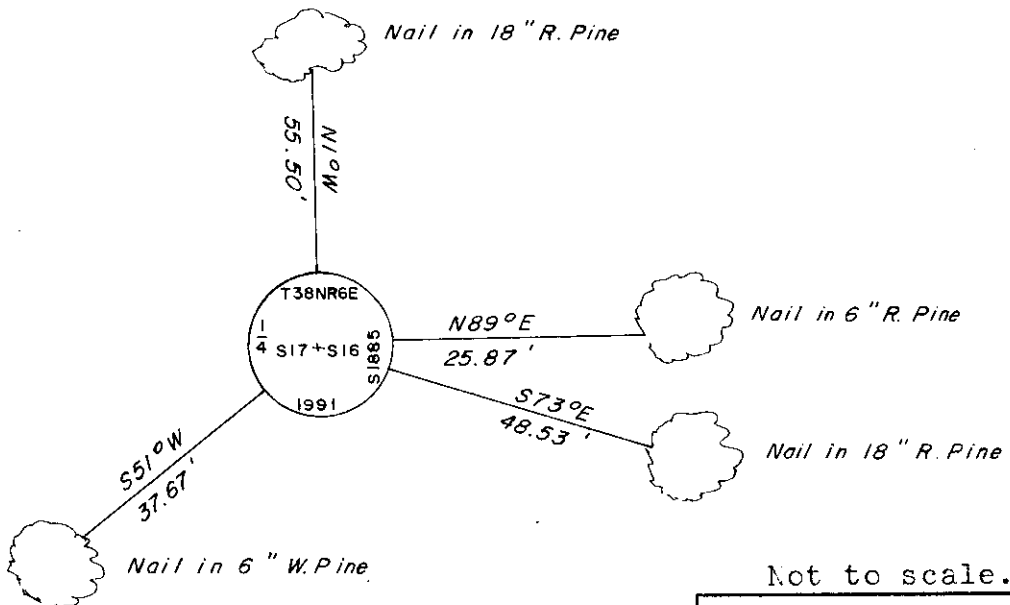

Not to scale.

(i) I, Jeffrey W. Austin, Registered Land Surveyor hereby certify that the corner location on this record was determined by me or under my direction and control and that this U.S. Public Land Survey Monument Record is correct and complete to the best of my knowledge and belief.

Signature: *Jeffrey W. Austin*

Date: 9-12-1991

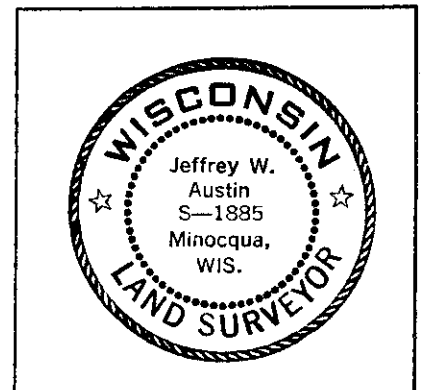

INDEX NO. L-9

3806172000

May, 1949: Notes by Wincentzen, iron pipe, Pine stump 24 S69°W, 9 lks.; N.Pine 10 N1°W, 55.0'; N.Pine 9 S75°45'E, 48.8'.

July 1968: Section subdivision by John Fisher, iron pipe, 14" Norway N4°W, 55.1'; 15" Norway S72°E, 48.7'.

September 10, 1991: I found and accepted a 1-1/4" dia. 31" long iron pipe. I replaced this pipe with a 2-1/2" dia. 30" long aluminum pipe with 3-1/4" dia. Oneida Co. aluminum cap 4" above ground and marked as shown on the reverse side of this record. I found the following witnesses: (Wincentzen) set nail in R.Pine 18" S73°E, 48.53 feet; (Wincentzen) Pine stump S84°W, 8.1 feet; (Wincentzen) set nail in R.Pine 18" N1°W, 55.50 feet. I established the following witnesses: set nail in R.Pine 6" N89°E, 25.87 feet; set nail in W.Pine 6" S51°W, 37.67 feet; set plastic sign post Northeast, 2 feet. A DEEP-1 magnet was also set below the new monument.