

**U.S. PUBLIC LAND SURVEY MONUMENT RECORD**

Note: This form is intended and designed to fulfill all requirements of Wisconsin Administrative Code, Chapter A-E 7.08 U.S. Public Land Survey Monument Record (3)(a)(b)(c)(d)(e)(f)(g)(h)(i). An additional sheet may be added if necessary to conform with said requirements.

(a) CORNER LOCATION: State Plane Coordinates  
 W 1/4 corner of Sec. 17 X \_\_\_\_\_  
 Township 38 North Y \_\_\_\_\_  
 Range 6 East Datum Base \_\_\_\_\_  
 Town/City Hazelhurst County of Oneida

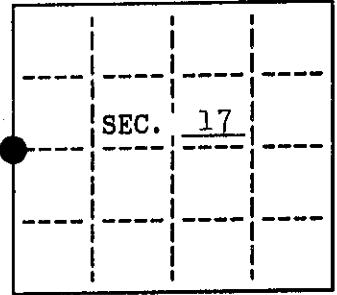

(b) HISTORY OF ORIGINAL CORNER ESTABLISHMENT  
 Original Surveyor: Alexander Anderson Original B.T.'S  
 Date of Survey: Commenced Sept. 1863 Y.Pine 10 S12°E, 36  
 Completed Oct. 1863 Y.Pine 10 S35°W, 48

(b)(f)(g)(h) Description of monument found at this corner and if it was accepted, state all evidence (material, testimonial, occupational, plats, records, other monuments) used as a basis for accepting. If not accepted or if nothing was found, state evidence used as basis for establishing location. If reestablished through lost corner proportionate methods, indicate all monuments, distances and directions used to establish. Indicate type of monument and sign post found or set.

See reverse...

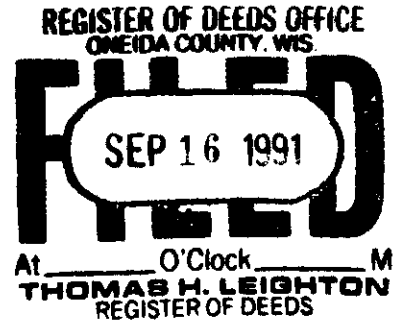

(c)(d)(e) Plan view of corner with ties to at least 4 witness monuments. If in disagreement with previously established corner, show the distances between the two corners and also indicate the ties to the disputed.

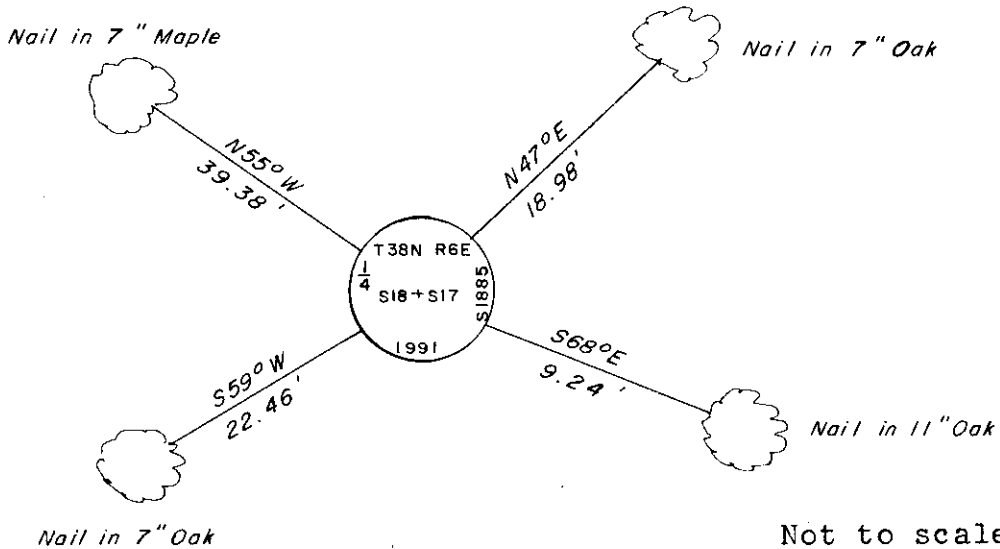

New bearing trees not blazed.

(i) I, Jeffrey W. Austin, Registered Land Surveyor hereby certify that the corner location on this record was determined by me or under my direction and control and that this U.S. Public Land Survey Monument Record is correct and complete to the best of my knowledge and belief.

Signature [Handwritten Signature] Date 9-12-1991

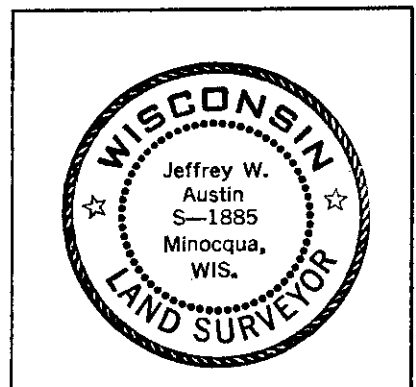

INDEX NO. 1-S

May, 1949: Notes by Wincentzen, concrete monument, Oak 5 N39°W, 3.9'; Oak 6 S57°E, 8.4'.

July, 1968: Section subdivision by John Fisher, concrete monument, 9" Oak S56°W, 8.0'; 9" Oak N4°W, 3.5'.

September 10, 1991: I found and accepted a 5" sq. 40" long concrete monument. I replaced this monument with a 2-1/2" dia. 30" long aluminum pipe with 3-1/4" dia. Oneida Co. aluminum cap set 10" below driveway grade and marked as shown on the reverse side of this record. I found the following witnesses: (Wincentzen) Oak stump S55°E, 8.2 feet; (Anderson) scribed Pine stump S33°W, 32.4 feet. I established the following witnesses: set nail in Oak 7" N47°E, 18.98 feet; set nail in Oak 11" S68°E, 9.24 feet; set nail in Oak 7" S59°W, 22.46 feet; set nail in Maple 7" N55°W, 39.38 feet; set plastic sign post East, 7 feet.