

# U.S. PUBLIC LAND SURVEY MONUMENT RECORD

Note: This form is intended and designed to fulfill all requirements of Wisconsin Administrative Code, Chapter A-E 7.08 U.S. Public Land Survey Monument Record (3) (a) (b) (c) (d) (e) (f) (g) (h) (i). An additional sheet may be added if necessary to conform with said requirements.

(a) Corner location: Township 38 North

Range 7 East/West

Town/City/Village LAKE TOMAHAWK

County ONEIDA

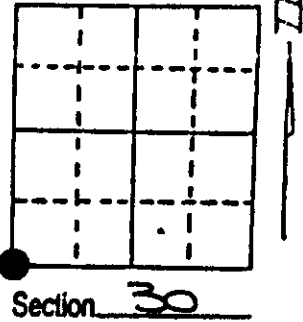

(b) (f) (g) (h) Description of monument found at this corner and if it was accepted, state all evidence (material, testimonial, occupational, plats, records, other monuments) used as a basis for accepting. If not accepted or if nothing was found, state evidence used as basis for establishing location. If reestablished through lost corner proportionate methods, indicate all monuments, distances and directions used to establish. Indicate type of monument found or set and sign post.

September, 1860: Alfred Millard set a wood post: W.Pine 7" N24W, 25 lks. W.Pine 14" S23E, 32 lks., W.pine 7" N67E, 35 lks., Y.Pine 12" S58W, 34 lks.

January, 1959: Lloyd Scott shows this corner on his map as a Iron Bar in road.

November 19, 1976: James Rein shows this corner as a RR spike in centerline of blacktop road found in place. (map c-146)

August 1, 1989: Jeffrey W. Austin found a RR spike under the existing pavement of Lakewood Road. Spike was replaced with a 1" dia., 30" long iron pipe: set nail in Oak 24" N35E, 63.53' (not blazed), set nail in Double Oak 12" S78E, 35.92', set nail in Maple 9" N48W, 48.07', set nail in Aspen 8" S36W, 89.38', set plastic sign post N82W, 18.5'.

(c) (d) (e) Plan view of corner with ties to at least 4 witness monuments. If in disagreement with previously established corner, show the distances between the two corners and also indicate the ties to the disputed corner.

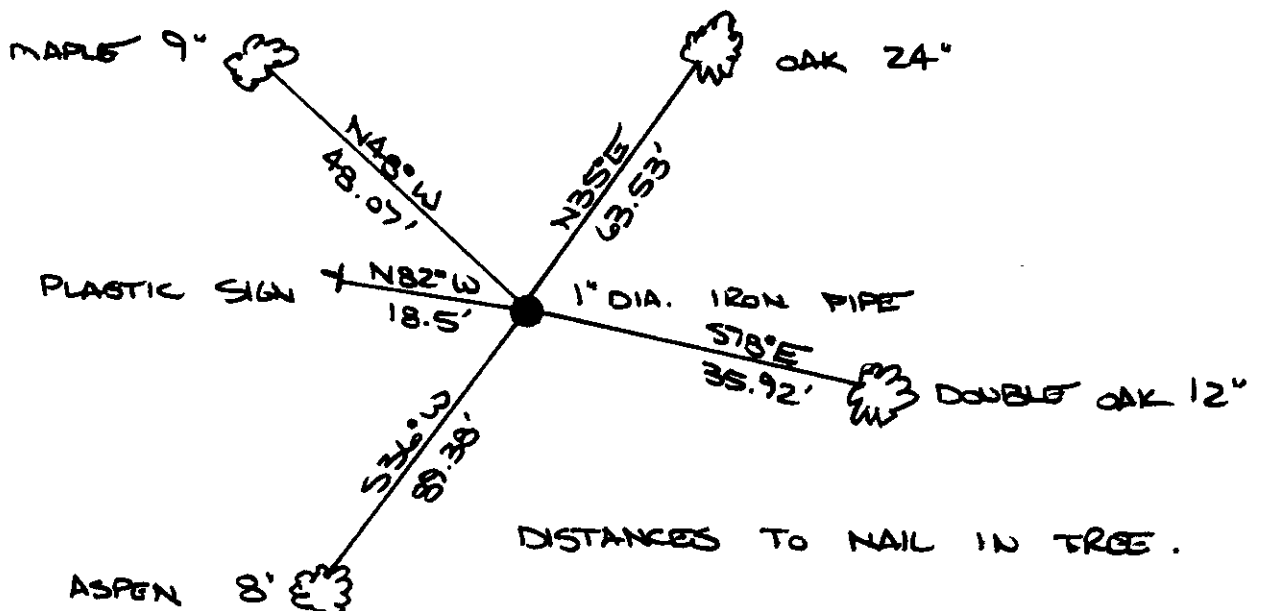

(i) I, JEFFREY W. AUSTIN S-1885  
 (type or print name) certify that the corner location on this record was determined by me or under my direction and control and that this U.S. Public Land Survey Monument Record is correct and complete to the best of my knowledge and belief.

[Signature] AUGUST 7, 1989  
 Signature Date



Index No. V-1

3806250000