

**U.S. PUBLIC LAND SURVEY MONUMENT RECORD**

Note: This form is intended and designed to fulfill all requirements of Wisconsin Administrative Code, Chapter A-E 7.08 U.S. Public Land Survey Monument Record (31a) and related provisions. An additional sheet may be added if necessary to conform with said requirements.

(a) Corner location: Township 37 North

Range 6 East

Town of Cassian

Oneida County, Wisconsin

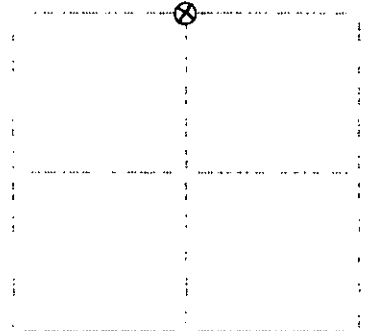

**Section 3**

(b) (1) (a) Description of monument found at this corner and if it was accepted, state all evidence (material, testimonial, occupational, plats, records, other monuments) used as a basis for accepting. If not accepted or if nothing was found, state evidence used as basis for establishing location. If reestablished through lost corner proportionate methods, indicate all monuments, distances and directions used to establish. Indicate type of monument found or set and sign post.

September, 1860: Alfred Millard, US deputy surveyor notes the following: 40.00 set 1/4 section post: w.pine 16 S49E, 14 lks.; w.pine 12 N49W, 39 lks.

December 1, 1936: Maine page 151 notes the following: Went to 1/4 str. between secs. 3&34 (twp. line bet. twps. 37&38) found spk. of brig. BT marks plain w.p. 16 S34E, 14 (govt. says S49E, 14) believe they intended S29E, as I found the old stake here. w.p. 12 N49W, 39 spk. 16 here marks burned off.

November 25, 1990: I found and accepted a 2-1/2 dia. iron post with brass cap 30" above ground marked as shown below. I found the following witnesses: scribed w.pine spk. (millard) S21E, 9.3 feet; old rotted stump (millard) N72W, 25.3 feet; set nail in w.pine 16 S35E, 17.38 feet. I established the following witnesses: set nail in w.pine 16 S76E, 15.15 feet; set nail in w.pine 20 S4E, 41.50 feet; set nail in w.pine 14 S3W, 64.27 feet; set plastic sign post north 1 foot.

(c) (1) (a) Plan view of corner with ties to at least four witness monuments. If in disagreement with previously established corner, show the distances between the two corners and also indicate the ties to the disputed corner.

1. nail in n.pine 16" S35E, 17.38 feet.
2. nail in w.pine 16" S76E, 15.15 feet.
3. nail in w.pine 20" S4E, 41.50 feet.
4. nail in n.pine 14" S3W, 64.27 feet.

(not to scale)

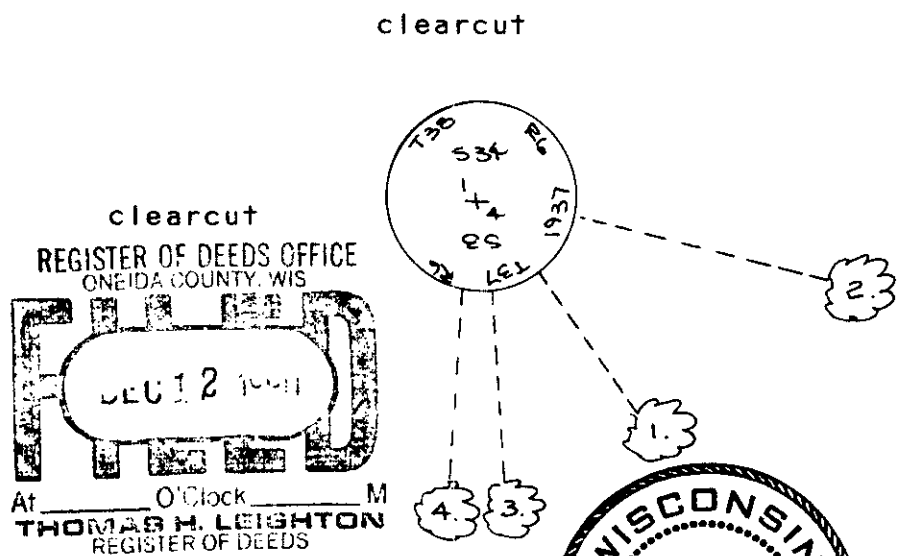

clearcut  
REGISTER OF DEEDS OFFICE  
ONEIDA COUNTY, WIS  
  
At \_\_\_\_\_ O'Clock \_\_\_\_\_ M  
THOMAS M. LEIGHTON  
REGISTER OF DEEDS

**WISCONSIN**  
Jeffrey W. Austin  
S-1885  
Minocqua,  
WIS.  
**LAND SURVEYOR**

I, Jeffrey W. Austin, Registered Land Surveyor S-1885 certify that the corner location on this record was determined by me or under my direction and control and that this U.S. Public Land Survey Monument Record is correct and complete to the best of my knowledge and belief.

November 30, 1990  
Leased

Index no. A-15

3806340020