

U.S. PUBLIC LAND SURVEY MONUMENT RECORD

Note: This form is intended and designed to fulfill all requirements of Wisconsin Administrative Code, Chapter A-E 5.02, U.S. Public Land Survey Monument Record (3) (a) (b) (c) (d) (e) (f) (g) (h) (i). An additional sheet may be added if necessary to conform with said requirements.

(a) Corner location: Township 38 North

Range 7 East

Town/ ~~LAKE TOMAHAWK~~ LAKE TOMAHAWK

County ONEIDA

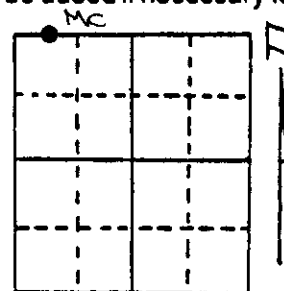

Section 12

(b) (f) (g) (h) Description of monument found at this corner and if it was accepted, state all evidence (material, testimonial, occupational, plats, records, other monuments) used as a basis for accepting. If not accepted or if nothing was found, state evidence used as basis for establishing location. If reestablished through lost corner proportionate methods, indicate all monuments, distances and directions used to establish.

ORIGINAL SURVEY: ALEXANDER ANDERSON, AUGUST, 1863
 SET WOOD POST: 4" PINE 12 S5°W, 15.4ks.
 " " " N38°W, 93ks.

FOUND: 3/4" DIA. IRON PIPE: PINE STUMP S5°E, 9.7' (ORIGINAL)?
 24" W. PINE N45°W, 25.63'

SET: 3" DIA. ALUMINUM TABLET STAMPED TO IDENTIFY CORNER OVER
 EXISTING PIPE: NAIL IN BTs: 24" W. PINE N45°W, 25.63'
 5" MAPLE S74°W, 15.84'
 4" ASPEN S7°W, 4.85'
 12" W. PINE S16°E, 16.92'

(c) (d) (e) Plan view of corner with ties to at least 4 witness monuments. If in disagreement with previously established corner, show the distances between the two corners and also indicate the ties to the disputed corner.

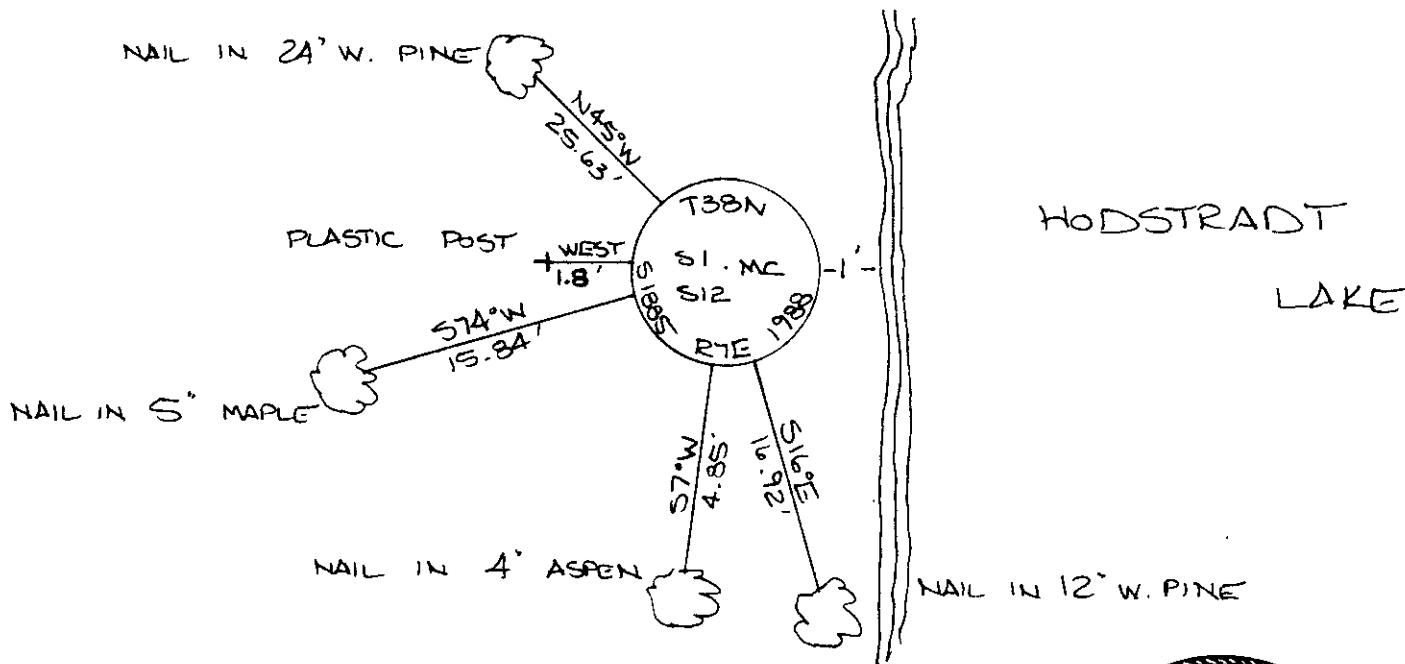

(i) I, JEFFREY W. AUSTIN, S-1885
 (type or print name) certify that the corner location on this record was determined by me or under my direction and control and that this U.S. Public Land Survey Monument Record is correct and complete to the best of my knowledge and belief.



Jeffrey W. Austin Signature July 13, 1988 Date

3807010034

Index No. E-2122