

# U.S. PUBLIC LAND SURVEY MONUMENT RECORD

Note: This form is intended and designed to fulfill all requirements of Wisconsin Administrative Code, Chapter A-E 7.08 U.S. Public Land Survey Monument Record (3) (a) (b) (c) (d) (e) (f) (g) (h) (i). An additional sheet may be added if necessary to conform with said requirements.

(a) Corner location: Township 38 North

Range 7 East ~~8~~

Town/City/Village Lake Tomahawk

County Oneida

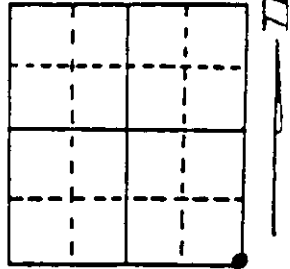

Section 2

(b) (f) (g) (h) Description of monument found at this corner and if it was accepted, state all evidence (material, testimonial, occupational, plats, records, other monuments) used as a basis for accepting. If not accepted or if nothing was found, state evidence used as basis for establishing location. If reestablished through lost corner proportionate methods, indicate all monuments, distances and directions used to establish. Indicate type of monument found or set and sign post.

1863-A. Anderson set post 6" Ironwood N 5 degrees East 12 links  
 5" Black Oak N 87 degrees West 19 links  
 1865-Vaughan set brass cap BTs are: 20" White Pine North 13 degrees East .430 ch., 18" White Pine South 16 degrees East .720 ch., 16" White Pine North 33 degrees West .464 Ch., 22" White Pine North 15 degrees East .433 ch.  
 1976-James Rein found 1 & 3/4" iron pipe with W.C.D. brass cap, BTs are: 10 1/2" dead Oak South 47 degrees West 260', 18" White Pine North 31 degrees West 30.8', 22" White Pine North 17 degrees West 28.6'  
 1992-William E. Bandow found brass cap and witnessed as shown below:

(c) (d) (e) Plan view of corner with ties to at least 4 witness monuments. If in disagreement with previously established corner, show the distances between the two corners and also indicate the ties to the disputed corner.

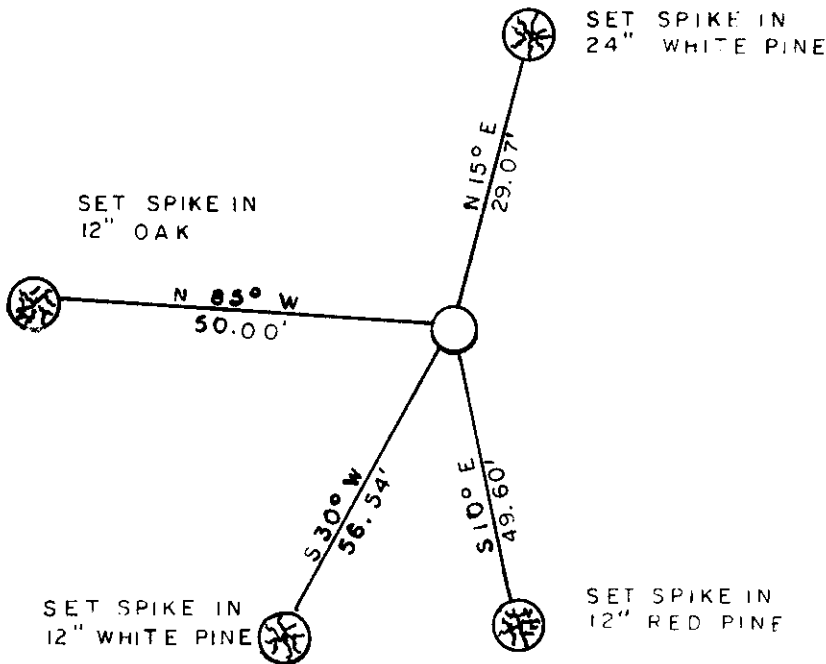

NOTE:  
 BEARINGS TAKEN  
 WITH HAND HELD  
 MAGNETIC COMPASS

NO SCALE



(i) I, William E. Bandow  
 (type or print name) certify that the corner location on this record was determined by me or under my direction and control and that this U.S. Public Land Survey Monument Record is correct and complete to the best of my knowledge and belief.

William E. Bandow 3-11-93  
 Signature Date

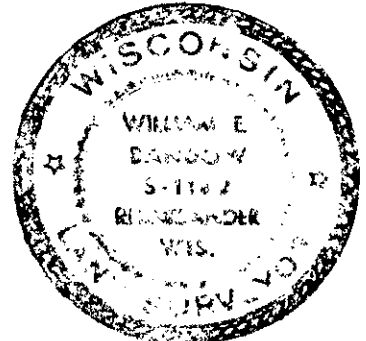

3807020000  
 Stamp

Index No. E-21