

**U.S. PUBLIC LAND SURVEY MONUMENT RECORD**

Note: This form is intended and designed to fulfill all requirements of Wisconsin Administrative Code, Chapter A-E 7.08 U.S. Public Land Survey Monument Record (3)(a-i).

(a) CORNER LOCATION  
 Cor. of Secs. 2, 3, 10 & 11  
 Township 38 North  
 Range 7 East of the 4th P.M.  
 Town of Lake Tomahawk  
 County of Oneida

WISCORS - Oneida County  
 N: 225,607.46 USft  
 E: 218,291.91 USft  
 Datum: NAD 83(2011)  
 GNSS Method: Static - Direct  
 GNSS Control: WISCORS VRS

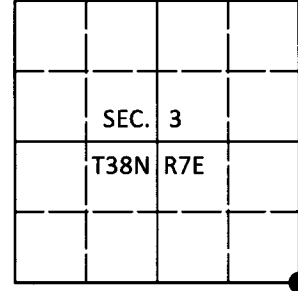

(b) HISTORY OF ORIGINAL CORNER ESTABLISHMENT

Original Surveyor: Alexander Anderson

Original Accessories:

Date of Survey      Commenced: Aug. 15, 1863  
                                  Completed: Aug. 27, 1863

Y. Pine 14" N4°W, 20 lks.  
 Y. Pine 14" N37°E, 27 lks.

(b)(f)(g)(h) Description of monument found at this corner and if it was accepted, state all evidence (material, testimonial, occupational, plats, records, other monuments) used as a basis for accepting. If not accepted or if nothing was found, state evidence used as basis for establishing location. If re-established through lost corner proportionate methods, indicate all monuments, distances and directions used to establish. Indicate type of monument and sign post found or set.

*March 4, 1947: Notes by A.J. Lytle in old fieldbook 21 on page 70 identifies corner witnessed by GLO bearing tree N44°E, 27 lks.*

*May, 1965: OCS Map No. L-803 by Wisconsin DNR identifies corner as 2" iron pipe with brass cap by Lytle with bearing trees.*

*November 2, 1976: OCS Map No. C-317 by James D. Rein identifies corner as 2" iron pipe with brass cap witnessed by a pine stump N42°E, 18 ft.*

*July 24, 2018: I found and accepted the record monument, a 2-1/2" diam. iron pipe with a 2-1/2" diam. Lytle/Oneida Co. brass cap projecting 12" above a collar of stone. All of the record bearing trees are gone. I found or established accessories as shown below. I set a white vinyl sign post bearing Northwest, 1 ft.*

*The coordinate value shown has been verified by at least one of the following methods: 1) comparison to a previously GPS determined published value; 2) the value is the average of two or more GPS observations at a markedly different time; 3) one or more distances were measured back to the GPS observed corner from temporary GPS observed offset locations.*

(c)(d)(e) Plan view of corner with ties to at least 4 witness monuments. If in disagreement with previously established corner, show the distances between the two corners and also indicate the ties to the disputed.

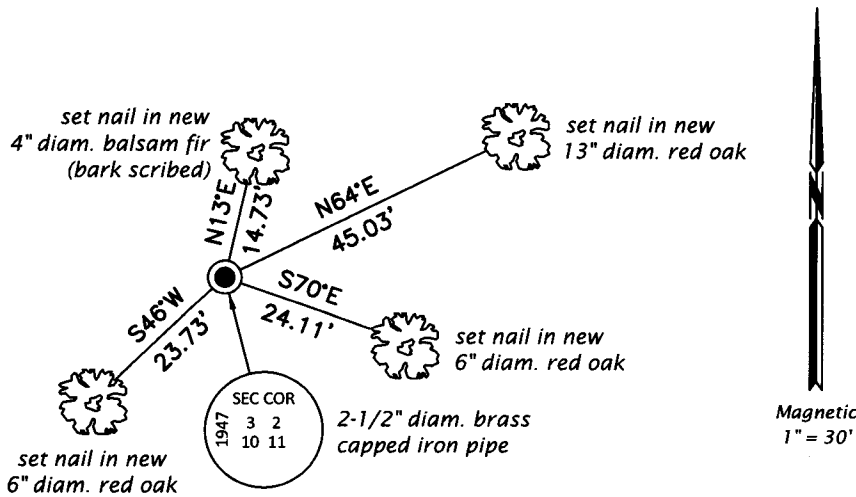

REGISTER OF DEEDS OFFICE  
 ONEIDA COUNTY  
 FILED

**AUG 16 2018**

KYLE J. FRANSON  
 REGISTER OF DEEDS

(i) I, Jeffrey W. Austin, Professional Land Surveyor No. S-1885, hereby certify that the corner location on this record was determined by me or under my direction and control and that this U.S. Public Land Survey Monument Record is correct and complete to the best of my knowledge and belief.

*[Handwritten Signature]*  
 \_\_\_\_\_  
 Signature

*AUG. 8, 2018*  
 \_\_\_\_\_  
 Date