

U.S. PUBLIC LAND SURVEY MONUMENT RECORD

Note: This form is intended and designed to fulfill all requirements of Wisconsin Administrative Code, Chapter A-E 7.08 U.S. Public Land Survey Monument Record (3) (a) (b) (c) (d) (e) (f) (g) (h) (i). An additional sheet may be added if necessary to conform with said requirements.

(a) Corner location: Township 38 North Corner: Lake Tomahawk Wit SMC - West Line

Section 9 Range 7 East Original Surveyor: A. Anderson/GLO

Town/City/Village Lake Tomahawk

Original B.T.'s: 14" Pw N65°E 7 lks
6" H N73°W 18 lks

County Oneida

Original Survey Date: August 1863

● Location

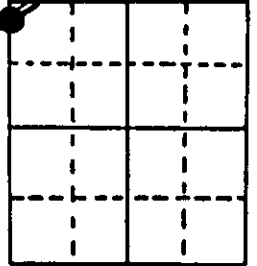

(b) (f) (g) (h) Description of monument found at this corner and if it was accepted, state all evidence (material, testimonial, occupational, plats, records, other monuments) used as a basis for accepting. If not accepted or if nothing was found, state evidence used as basis for establishing location. If reestablished through lost corner proportionate methods, indicate all monuments, distances and directions used to establish. Indicate type of monument found or set and sign post.

Found and accepted a standard 2" dia. iron pipe monument with stamped DNR brass cap 12" above grade at corner location. This monument is a witness monument set on the west line of Section 9 by Viissers/WisDNR 24.74' South of a found 2" dia. standard iron pipe monument with stamped GLO cap set by a 1927 GLO Resurvey, which is at waters edge of Lake Tomahawk and subject to bank erosion, lake ice action. Meander corner is North 3.30 feet from the GLO WitMC monument and falls in lake. In 1927, Harrington/GLO located original GLO survey MC location from found GLO OBTs, and set the standard GLO iron pipe WitMC monument 5 links South on section line and marked new BTs: 15" H S07°E 12 lks is now a 24" H face blaze is shut but plain and 8" H S70°W 23 lks is now a 10" H upper face blaze shut but plain. Later on unknown date WCD survey notes indicate that GLO WitMC monument and BTs found OK and a new BT marked 16" Pn S77°E 0.268 ch which I found OK with upper & lower face blazes partly shut but very plain. In September 1996, Viissers/DNR set this new WitMC monument and marked new BTs as noted herein. I set a standard white fiberglass 'T' corner marker post 1 foot West of new WitMC monument, which is now 28.04 feet South of original GLO MC in lake. This recovery completed October 18, 1996; no witnesses. No reliable OBT evidence found.

Note: All new Hemlock BTs below are face blazed and scribed with "BT"/upper only.

(c) (d) (e) Plan view of corner with ties to at least 4 witness monuments. If in disagreement with previously established corner, show the distances between the two corners and also indicate the ties to the disputed corner.

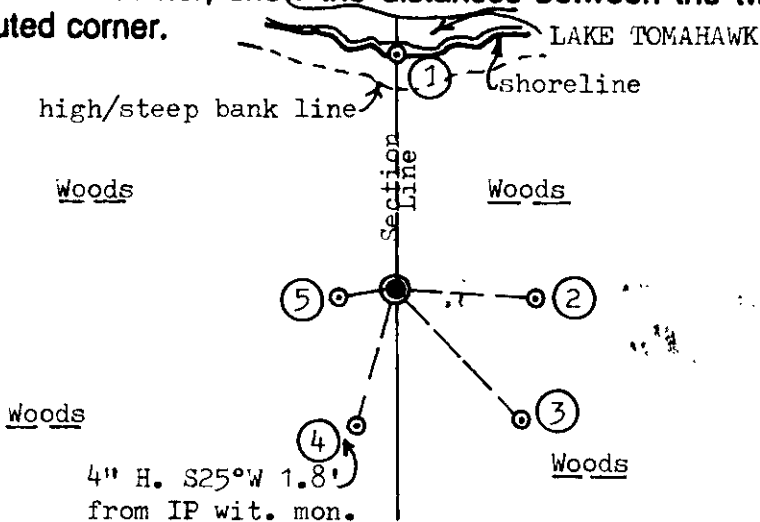

Witness Monument Ties:

- ① Standard 2" iron pipe found with stamped GLO cap (1927) North 24.74'.
- ② 9" H. New BT S86°E 14.63'; PK nail/washer in left face.
- ③ 7" H. New BT S44°E 19.15'; PK nail/washer in left face.
- ④ 1" x 24" iron pipe set with Ref. Mk cap S16.5°W 14.96'.
- ⑤ 6" H. New BT S84°W 5.59'.

Unless otherwise indicated, all BT witness monument ties are to a 1/4" dia. by 2.5" long PK nail with 1.25" dia. steel washer set in unblazed right face bark; and a PK nail with 2" dia. steel washer stamped BT also set in unblazed front face bark of each BT at DBH. All previous corner recovery notes from Wisconsin DNR and/or Oneida County survey records.



Scale: 1" = 20'

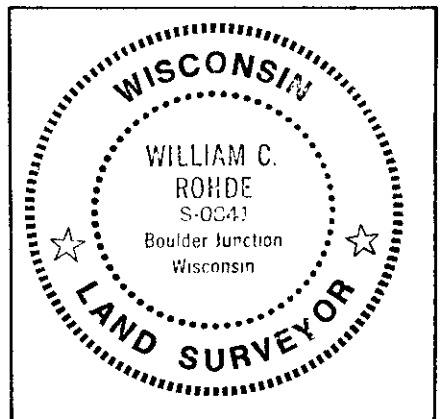

(i) I, William C. Rohde, RLS 841
(type or print name) certify that the corner location on this record was determined by me or under my direction and control and that this U.S. Public Land Survey Monument Record is correct and complete to the best of my knowledge and belief.

William C. Rohde
Signature

March 27, 1997
Date

