

U.S. PUBLIC LAND SURVEY MONUMENT RECORD

Note: This form is intended and designed to fulfill all requirements of Wisconsin Administrative Code, Chapter A-E 5.02, U.S. Public Land Survey Monument Record (3) (a) (b) (c) (d) (e) (f) (g) (h) (i). An additional sheet may be added if necessary to conform with said requirements.

(a) Corner location: Township 38 North
 Range 7 East ~~West~~

Town/City/Village Lake Tomahawk
 County Oneida

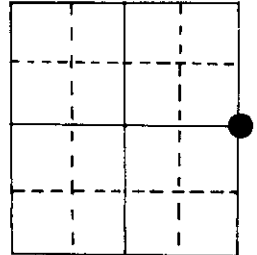

Section 13

(b) (f) (g) (h) Description of monument found at this corner and if it was accepted, state all evidence (material, testimonial, occupational, plats, records, other monuments) used as a basis for accepting. If not accepted or if nothing was found, state evidence used as basis for establishing location. If reestablished through lost corner proportionate methods, indicate all monuments, distances and directions used to establish.

Original by A. Millard, 1869, OBT's PW 7" S70°E 12 lks., PW 10" S10°W 12 lks.

Vaughn, 1908, set a cedar post with rocks around at the proportioned distance between the MC found on the south bank of river and SE 13.
 Set at 6.53 ch. from MC (had total 21 lks. overrun)

L.P. Pelishek, Engineer, set iron pipe in 9/1/1924, most likely found Vaughn's.
 Distance is 2651.0' from SE 13. Made BT's oak 5" N18°W 558, PN 4" N79°E 85.8'
 oak 8" S47°E 108'

Seymour, 1982, found i.p. in grass area. No BT's found, made new BT's 7 ref.

(c) (d) (e) Plan view of corner with ties to at least 4 witness monuments. If in disagreement with previously established corner, show the distances between the two corners and also indicate the ties to the disputed corner.

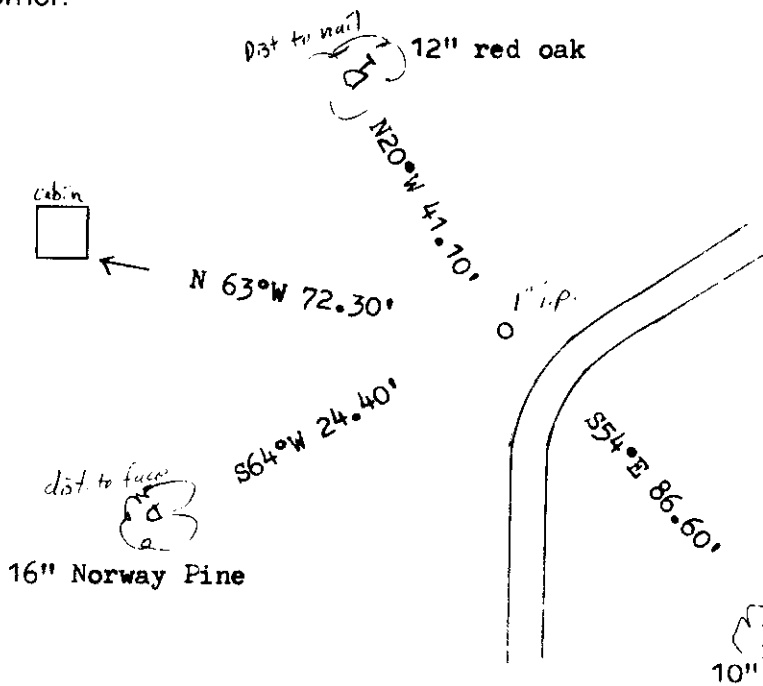

REGISTER'S OFFICE }
 Oneida County, Wis. }

Received for Record the 29 day of
February A.D. 1988 at
8:00 o'clock a M. and recorded in
 Vol. _____ on page _____

Register

16" Norway Pine

10" jack pine

(i) I, Marvin E. Seymour
 (type or print name) certify that the corner location on this record was determined by me or under my direction and control and that this U.S. Public Land Survey Monument Record is correct and complete to the best of my knowledge and belief.

Marvin E. Seymour Feb. 19, 1988
 Signature Date



3807132000 L-25