

U.S. PUBLIC LAND SURVEY MONUMENT RECORD

Note: This form is intended and designed to fulfill all requirements of Wisconsin Administrative Code, Chapter A-E 5.02, U.S. Public Land Survey Monument Record (3) (a) (b) (c) (d) (e) (f) (g) (h) (i). An additional sheet may be added if necessary to conform with said requirements.

(a) Corner location: Township 38 North
 Range 7 East ~~West~~
 Town/~~City/Village~~ Lake Tomahawk
 County Oneida

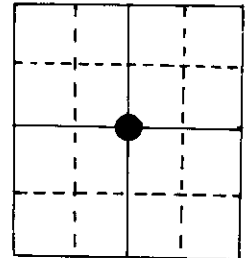
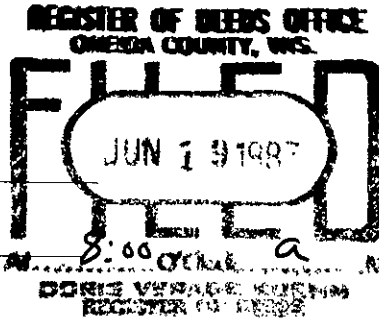

Section 22

(b) (f) (g) (h) Description of monument found at this corner and if it was accepted, state all evidence (material, testimonial, occupational, plats, records, other monuments) used as a basis for accepting. If not accepted or if nothing was found, state evidence used as basis for establishing location. If reestablished through lost corner proportionate methods, indicate all monuments, distances and directions used to establish.

F.A. Winsentsen, 1949, used the erroneous location. Then it was a wood post. Since then somebody replaced it with a iron rod. There are BT's now to it, but I do not know who made them. Vernon Maine surveyed in this area, so he could have set this cor. His work was not always good.

Seymour, 1987, set a correct C/A by the intersection of straight lines between opposite 1/4 corners. It falls north of Bluebird Rd. As of June 1987 the monument is not in as the road is under construction. Later this summer, when the road is completed, a D.N.R. brass cap pipe will be put in. The point is now established with bearing trees, so the monument can be put in using them.

(c) (d) (e) Plan view of corner with ties to at least 4 witness monuments. If in disagreement with previously established corner, show the distances between the two corners and also indicate the ties to the disputed corner.

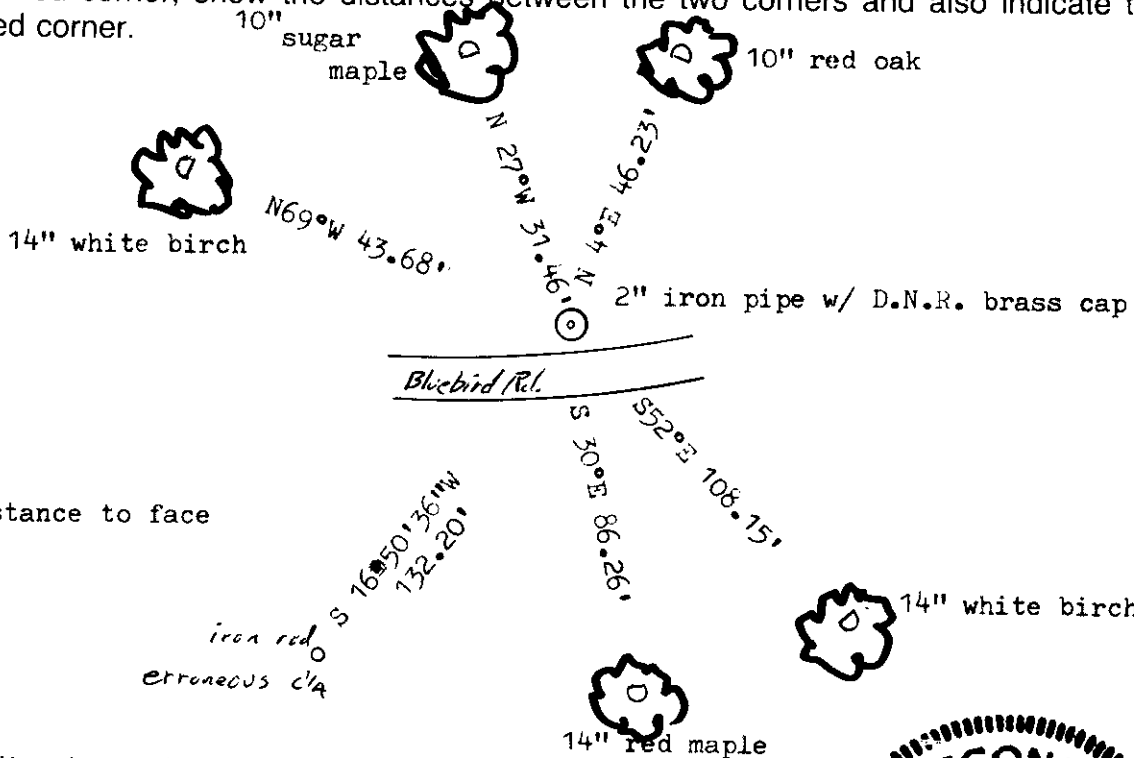

(i) I, Marvin E. Seymour
 (type or print name) certify that the corner location on this record was determined by me or under my direction and control and that this U.S. Public Land Survey Monument Record is correct and complete to the best of my knowledge and belief.

Marvin E. Seymour Signature June 12, 1987 Date



3807222020

P-15