

U.S. PUBLIC LAND SURVEY MONUMENT RECORD

Note: This form is intended and designed to fulfill all requirements of Wisconsin Administrative Code, Chapter A-E 7.08 U.S. Public Land Survey Monument Record (3) (a) (b) (c) (d) (e) (f) (g) (h) (i). An additional sheet may be added if necessary to conform with said requirements.

(a) Corner location: Township 38 North
 Range 7 East/West
 Town/City/Village LAKE TOMAHAWK
 County ONEIDA

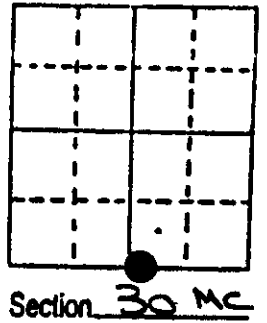

(b) (f) (g) (h) Description of monument found at this corner and if it was accepted, state all evidence (material, testimonial, occupational, plats, records, other monuments) used as a basis for accepting. If not accepted or if nothing was found, state evidence used as basis for establishing location. If reestablished through lost corner proportionate methods, indicate all monuments, distances and directions used to establish. Indicate type of monument found or set and sign post.

August, 1863: Alexander Anderson set a wood post: Tamarack 10" N71½E, 24 lks., W.Pine 24" S78E, 39 lks.
 January, 1959: Lloyd Scott shows this corner as a Concrete Monument: W.pine 14" S32E, 10', Spruce 6" N69E, 21'.
 November 19, 1976: James Rein shows this corner as a 5"x5" Concrete Monument and unscribed spruce post found in place: W.Pine 20" S22E, 10.2', Spruce 8" N73E, 20.5'.
 August 1, 1989: Jeffrey W. Austin found and accepted a 5" square Concrete Monument: set nail in W.Pine 18" S55E, 47.58', set nail in W.Pine 14" N85E, 35.85', set nail in W.Pine 22" S25E, 10.76', set nail in Spruce 5" S5E, 17.02', found old dead Spruce 6" N68E, 20.9'.

(c) (d) (e) Plan view of corner with ties to at least 4 witness monuments. If in disagreement with previously established corner, show the distances between the two corners and also indicate the ties to the disputed corner.

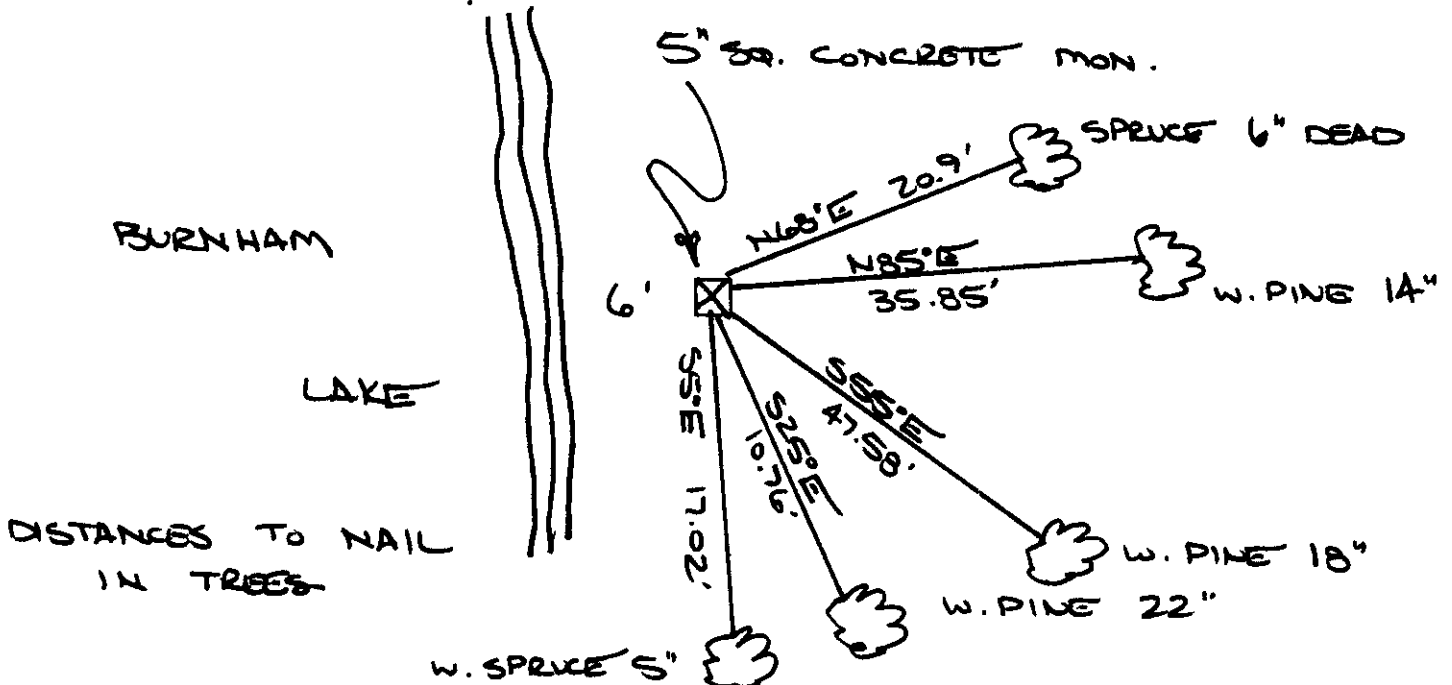

(i) I, JEFFREY W. AUSTIN S-1885
 (type or print name) certify that the corner location on this record was determined by me or under my direction and control and that this U.S. Public Land Survey Monument Record is correct and complete to the best of my knowledge and belief.

[Signature] AUGUST 7, 1989
 Signature Date



Index No. V-3-4

3807300019