

CERTIFIED LAND CORNER RESTORATION

Index No. **Y-23**

State of Wisconsin

County of **Oneida**

ss.

I **Phillip T. Hansen**, do hereby certify that on the **13th** day of **January**, 19**77**, I found evidence of the **SC 1/16** corner of **Section 36** Township **38**, North, Range **7 East**, Fourth Principal Meridian, as described hereon; and that from this evidence I established a new monument and accessories as described hereon to perpetuate the original location of this corner.

Resident witnesses:

**Jim Clafflin**

**Herb Wagoner**

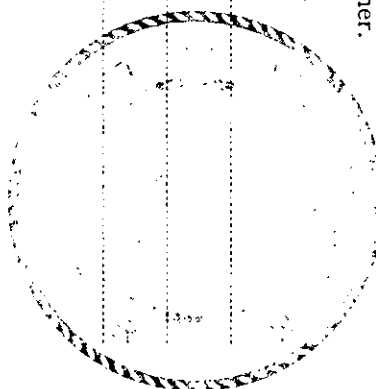

**T38N R7E**

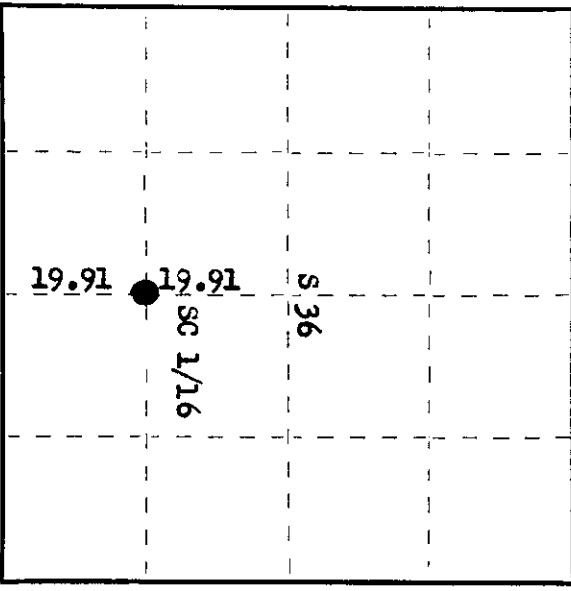

○ = Corner monument restored.

History of original corner establishment:

Corner established by Goddard and crew, Ripco Surveyors, in 1959. Ran a random line North, bearing 357° 23' mag. to close out 1.52 chains East of N 1/4 corner. Set SC 1/16 at 19.91 chains 38 links west. Marked NBT - Maple 4" S 52° W 7 1/2 links and Maple 4" N 43° E 19 links.

Description of corner evidence found:

Recovered 1" iron pipe with 2" brass cap in good condition and firmly in ground. Recovered OBFTs - Maple 4" (6") S 52° W 7.5 links (8.0 links) scribed SC 1/16 BT. Maple 4" (6") N 43° W (N 47° W) 19.0 links (18.6 links) SC 1/16 BT. Measurements taken to center of BTs.

Description of monument and accessories I established to perpetuate the original location of this corner. **As monument was recovered in good condition, it was left in place. Monument projects 20" above ground. Cap stamped: No additional accessories established.**

**T38N R7E**  
**S 1/36**  
**CS 1/16**  
**RIPCO**

Dated at **Rhineland**, Wis., this **18th** day of **January**, 19**77**.

Signature **Phillip T. Hansen** Title **Registered Land Surveyor** Registration No. **3498**  
(County Surveyor, Registered Land Surveyor, or other duly authorized official)

Office of Register of Deeds, County of **Oneida**. I hereby certify that the within instrument was filed in this office for record on the **24th** day of **February**, 19**77** at **1:00** o'clock **P.** M.

Signature **Doree Verage Kuehn**  
(Register of Deeds)

By: \_\_\_\_\_ Deputy

3807361020