

U.S. PUBLIC LAND SURVEY MONUMENT RECORD

Note: This form is intended and designed to fulfill all requirements of Wisconsin Administrative Code, Chapter A-E 7.08 U.S. Public Land Survey Monument Record (3) (a) (b) (c) (d) (e) (f) (g) (h) (i). An additional sheet may be added if necessary to conform with said requirements.

(a) Corner location: Township 38 North
 Range 8 East/West

Town/City/Village Newbold

County Oneida

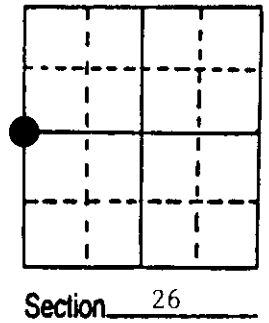

(b) (f) (g) (h) Description of monument found at this corner and if it was accepted, state all evidence (material, testimonial, occupational, plats, records, other monuments) used as a basis for accepting. If not accepted or if nothing was found, state evidence used as basis for establishing location. If reestablished through lost corner proportionate methods, indicate all monuments, distances and directions used to establish. Indicate type of monument found or set and sign post.

1863 - Alexander Anderson established this corner and set a wood post and two BTs:
 8" Fir, N45°E, 16 Links 7" Birch, N53°W, 5 Links

1912 - Vaughan used corner to restore Section Corner one-half mile south.

1970's - Kirby used corner to subdivide Section 26.

1978 - Immich used corner to set North Sixteenth to Section 26/27.

3/28/1991 - Milo E. Stefan found 1" x 24" iron pipe marking this corner. I accept this pipe as the perpetuated corner position and place an aluminum monument at the position of the iron pipe, make new BTs and set a plastic sign post.

(c) (d) (e) Plan view of corner with ties to at least 4 witness monuments. If in disagreement with previously established corner, show the distances between the two corners and also indicate the ties to the disputed corner.

- 1) 2" x 36" aluminum monument
- 2) 14" White Pine, N57°E, 53.91'
- 3) 8" Red Pine, S78°E, 45.37'
- 4) 13" Red Oak, S44°W, 40.42'
- 5) 8" White Birch, S9°E, 11.30'
- 6) Plastic Sign Post, Southwest, .5'

Distances to nail in side of BTs.
 Stump blazes scribed "BT".

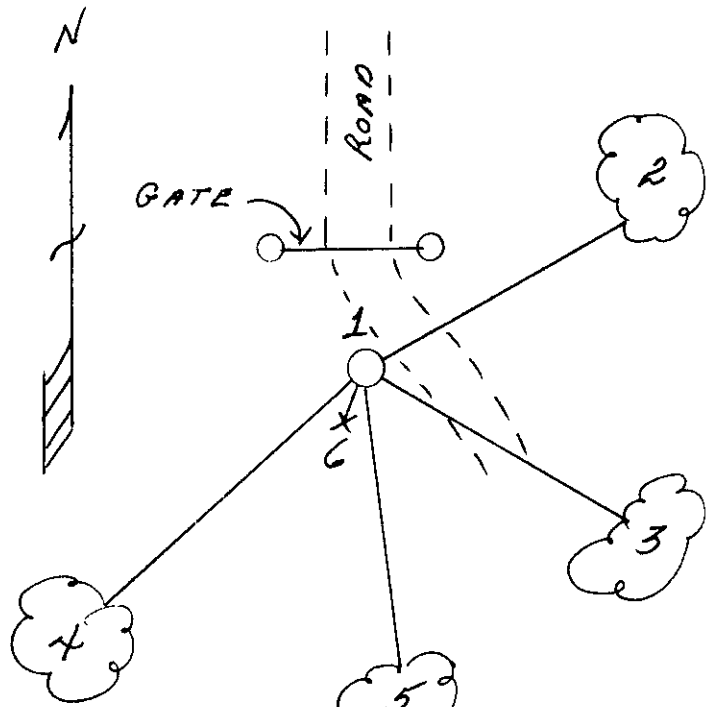

REGISTER OF DEEDS OFFICE
 ONEIDA COUNTY, WIS.
FILED
 APR 8 1991
 At 0 O'Clock M
THOMAS H. LEIGHTON
 REGISTER OF DEEDS

(i) I, Milo E. Stefan
 (type or print name) certify that the corner location on this record was determined by me or under my direction and control and that this U.S. Public Land Survey Monument Record is correct and complete to the best of my knowledge and belief.

Milo E. Stefan April 3, 1991
 Signature Date



Stamp 380827200

Index No. I-17