

CERTIFIED LAND CORNER RESTORATION

Index No. A-25

State of Wisconsin }
County of Oneida } ss.

I Phillip T. Hansen, do hereby certify that on the 5th day of April, 1977, I found evidence of the Section corner of Sec. 36, 31, 6, 1 Township 38, North, Range 8 & 9 East, Fourth Principal Meridian, as described hereon; and that from this evidence I established a new monument and accessories as described hereon to perpetuate the original location of this corner.

Resident witnesses:

Jim Clafflin

Herb Wagoner

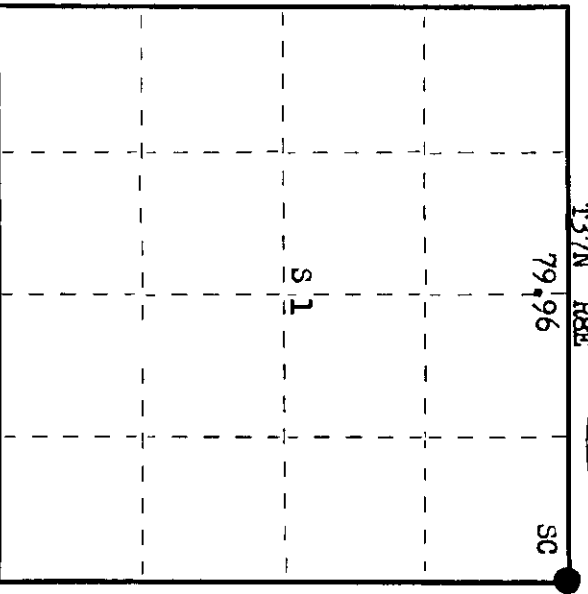
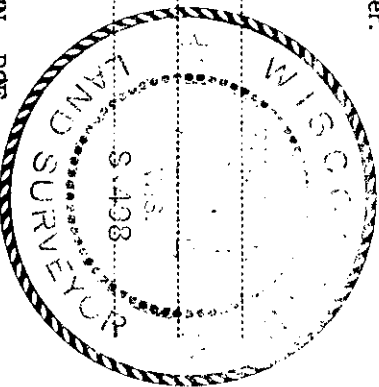

O = Corner monument restored.

History of original corner establishment:

Original Corner established by Hiram C. Fellows, Deputy Surveyor, in 1859, from which Yellow Pine 15" bears N 26° W, 358 links; Yellow Pine 15" bears N 71° W, 452 links; Yellow Pine 8" bears S 23° E, 211 links; Yellow Pine 16" bears S 7° W, 873 links.

Corner recovered by N. Loftus, Ripco Surveyor, in 1960. He started from this corner and ran random line west to NW corner, but no mention is made of any BTs marked or new corner set.

Description of corner evidence found:

Recovered 1-3/4" iron pipe with 3" brass cap, in excellent condition, projecting 26" above ground. Cap stamped:

Recovered OBTs - Tamarack 3" N42°W, 40.7 links, scribed 36 BT. T38N R8E T38N R9E
Tamarack 3" N32°W, 40.3 links, not scribed. S36 | S31
Tamarack 3" S42°E, 26.7 links, not scribed. S1 | S6
T37N R8E T37N R9E
RIPCO

Description of monument and accessories I established to perpetuate the original location of this corner.

As monument was recovered in good condition, it was left as found.
NBT marked - Black Spruce 4" N19°E, 28.0 links, scribed SC BT.

Dated at Rhineland, Wis., this 5th day of May, 1977.

Signature Phillip T. Hansen Title Registered Land Surveyor Registration No. S-498
(County Surveyor, Registered Land Surveyor, or other duly authorized official)

Office of Register of Deeds, County of Oneida. I hereby certify that the within instrument was filed in this office for record on the 6th day of May, 1977 at 1:00 o'clock P. M.

Louise LePage (Register of Deeds) Franklin

By Franklin Deputy

380 5360000