

# U.S. PUBLIC LAND SURVEY MONUMENT RECORD

Note: This form is intended and designed to fulfill all requirements of Wisconsin Administrative Code, Chapter A-E 7.08 U.S. Public Land Survey Monument Record (3) (a) (b) (c) (d) (e) (f) (g) (h) (i). An additional sheet may be added if necessary to conform with said requirements.

(a) Corner location: Township 38 North

Range 9 East/West

Town/City/Village SUGAR CAMP

County ONEIDA

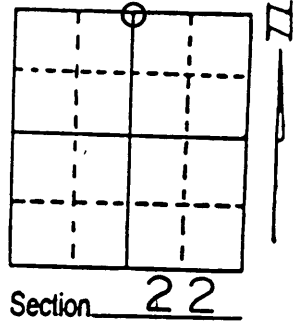

(b) (f) (g) (h) Description of monument found at this corner and if it was accepted, state all evidence (material, testimonial, occupational, plats, records, other monuments) used as a basis for accepting. If not accepted or if nothing was found, state evidence used as basis for establishing location. If reestablished through lost corner proportionate methods, indicate all monuments, distances and directions used to establish. Indicate type of monument found or set and sign post.  
 Sept. 1863 William E. Daugherty corrected West 40.00 and set quarter section post. Birch 8, N 17 E, 22: Spruce 8, S 56 W, 18:

Jan. 1892 B.F. Dorr ran N-S 1/4 line of sec. 22, no ties shown. His distance of 77.78 chs.

March 1975 Norman Loftus was shown the corner location by long time owner Ernest Kunda, A 2 inch iron pipe in the remnants of an E-W fence line just East of a small field. Origin unknown.

1987 I ran the South line of Sec. 15 and tied to the 2 inch galvanized pipe. We believe this to be B.F Dorr's location of 1892  
 I placed stamped Brass insert into pipe and made four BTs.

(c) (d) (e) Plan view of corner with ties to at least 4 witness monuments. If in disagreement with previously established corner, show the distances between the two corners and also indicate the ties to the disputed corner.

Distances measured to spike in tree.  
 Bearings taken by Hand Compass.  
 No scale.

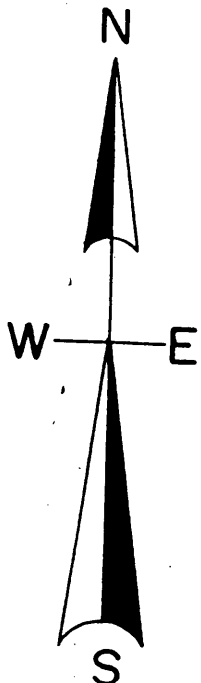
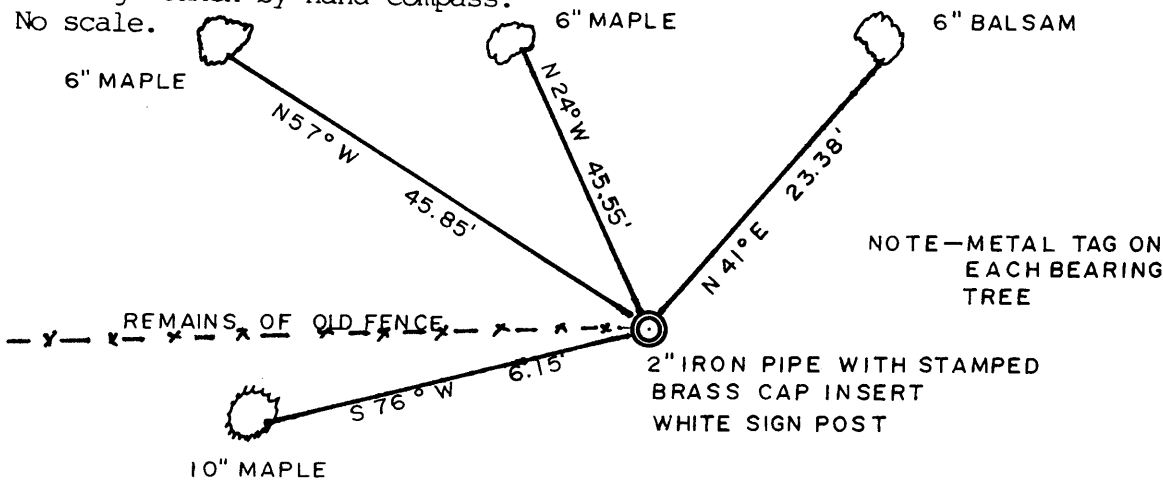

(i) I, Todd J. Loftus  
 (type or print name) certify that the corner location on this record was determined by me or under my direction and control and that this U.S. Public Land Survey Monument Record is correct and complete to the best of my knowledge and belief.

Todd J. Loftus Signature Feb 18, 2004 Date

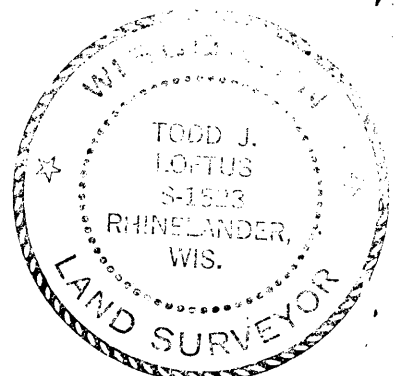

3809150020  
 Stamp

Index No. N-15