

CERTIFIED LAND CORNER RESTORATION

Index No. Q-23

State of Wisconsin

County of Oneida } ss.

I Phillip T. Hansen, do hereby certify that on the 14th day of July, 1977, I found evidence of the SC 1/16 corner of Section 24 Township 38, North, Range 9 East, Fourth Principal Meridian,

as described hereon; and that from this evidence I established a new monument and accessories as described hereon to perpetuate the original location of this corner.

Resident witnesses:

Jim Clafflin

Herb Wagoner

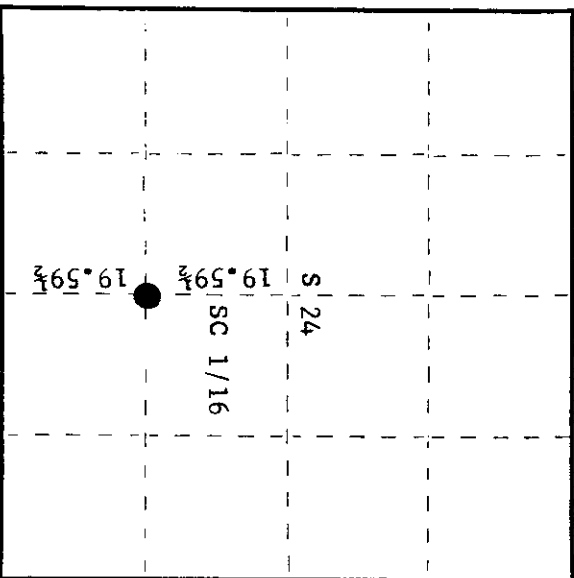
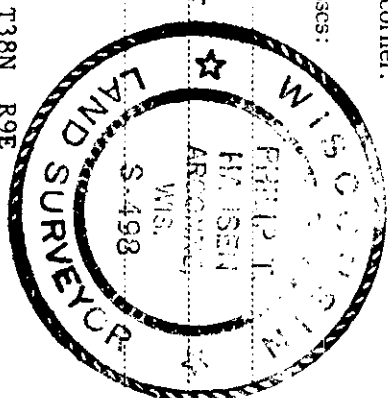

○ = Corner monument restored.

History of original corner establishment:

Corner established by N. Loftus, Ripco surveyor, in 1956. Set SC 1/16 at 19.59-1/2 chains south 30° 15' E of previously established C 1/4. Marked NBT's - Cedar 6" N23°W 45 links Cedar 6" N85°W 19 links

Description of corner evidence found:

Recovered 1" Iron pipe with 2" square brass cap in excellent condition projecting 24".

Stamped:

Recovered OBT's - Cedar 6" N23°W 45.0 links, down and dead. Cedar 6" N85°W 77.0 links, dead, scribed 1/16 BT.

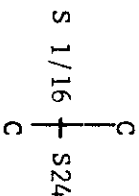

Description of monument and accessories I established to perpetuate the original location of this corner.

Left monument in place as recovered.

Marked NBT's - W. Pine 16" S87°W 61.0 links, scribed 1/16 BT. W. Spruce 6" N21°E 83.8 links, scribed 1/16 BT.

Dated at Rhineland, Wis., this 11th day of February, 19 80

Signature Phillip T. Hansen, Title Registered Land Surveyor, Registration No. S-498  
(County Surveyor, Registered Land Surveyor, or other duly authorized official)

Office of Register of Deeds, County of Oneida, I hereby certify that the within instrument was filed in his office for record on the 10th day of March, 19 80 at 9:10 o'clock A.M.

Daniel J. Torrey  
(Register of Deeds)

By \_\_\_\_\_ Deputy

380924/020

CERTIFIED LAND CORNER RESTORATION

Index No. Q-23

State of Wisconsin }  
 County of Oneida } ss.

I, Phillip T. Hansen, do hereby certify that on the 14th day of July, 1977, I found evidence of the SC 1/16 corner of Section 24 Township 38, North, Range 9 East, Fourth Principal Meridian,

I established a new monument and accessories as described hereon to perpetuate the original location of this corner.

Resident witnesses,  
Jim Claffin  
Herb Wagoner

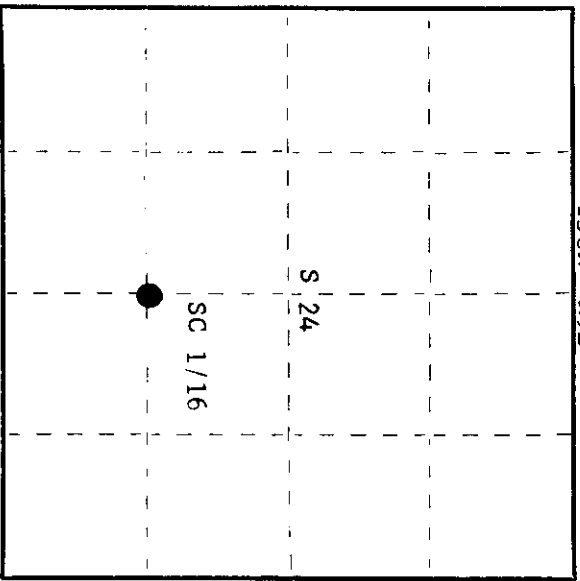
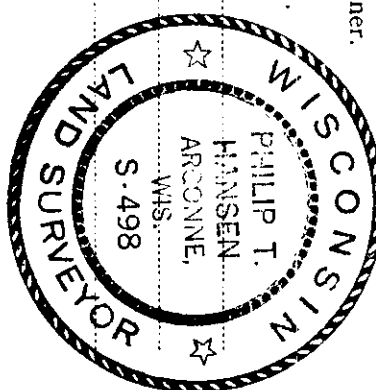

○ = Corner monument restored.

History of original corner establishment:

Corner established by N. Loftus, Ripco surveyor. Ran random line south from N 1/4 corner 78.42 chains to close out 1.37-1/2 chains west of S 1/4. Ran east-west 1/4 line to establish C 1/4 corner at 39.23 chains south from N 1/4 corner. Set SC 1/16 corner at 58.82-1/2 chains on true bearing S 3° 15' E. Marked BR's - cedar 6" N23°W 45 links Cedar 6" N85°W 79 links

Description of corner evidence found:

Recovered 1" iron pipe with 2" square brass cap in excellent condition. Cap stamped: Monument projects 24" above ground.  
 Recovered OBR's - Cedar 6" N23°W 45.0 links, now down and dead. Cedar 6" N85°W 77.0 links, now dead, scribed 1/16 BT.

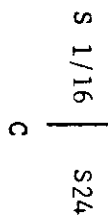

Description of monument and accessories I established to perpetuate the original location of this corner.

Left monument in place as recovered.  
 Marked NBR's - White Pine 15" S87°W 61.0 links, scribed 1/16 BT.  
 White Spruce 6" N21°E 83.8 links, scribed 1/16 BT.

Dated at Rhineland, Wis., this 22nd day of January, 1980.

Signature: Phillip T. Hansen Title: Registered Land Surveyor Registration No. S-498  
 (County Surveyor, Registered Land Surveyor, or other duly authorized official)  
 Office of Register of Deeds, County of Oneida  
 at 2:15 o'clock P. M. 1/14 day of January, 1980.  
 I hereby certify that the within instrument was filed in this office for record on the 1/14 day of January, 1980.

Doris Berge Fuchser  
 (Register of Deeds)

By: \_\_\_\_\_ Deputy