

CERTIFIED LAND CORNER RESTORATION

Index No. **S-25**

History of original corner establishment:  
Corner recovered and restored by Goddard and crew, Ripco Surveyors, in 1960. Ran random line south bearing  $191^{\circ} 37' S3^{\circ} 01' W$ , 19.77 chains to close out 80 links of N 1/16. Set new post.

State of Wisconsin

County of Oneida

} ss.

I, Phillip T. Hansen, do hereby certify that on the 13th day of July, 1977, I found evidence of the N 1/16 corner of Section 25 & 30 Township 38 North, Range 9 East, Fourth Principal Meridian, as described hereon; and that from this evidence I established a new monument and accessories as described hereon to perpetuate the original location of this corner.

Resident witnesses:  
Jim Claffin  
Herb Wagoner

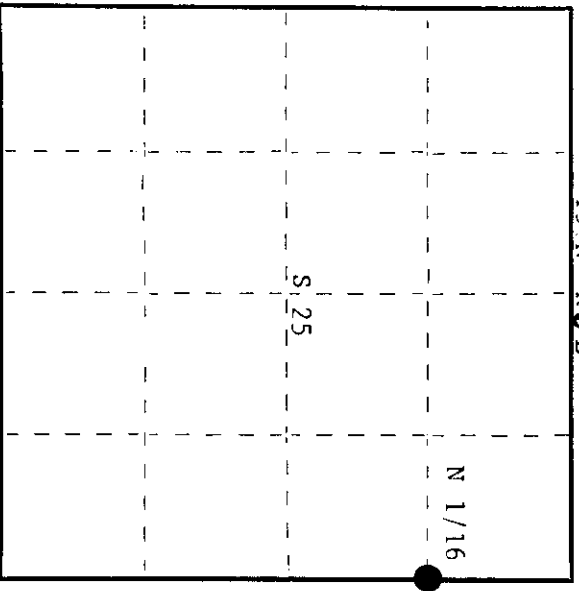
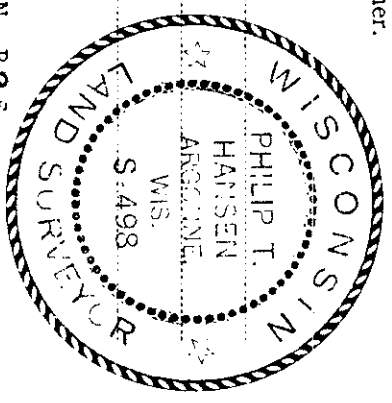

○ = Corner monument restored.

Description of corner evidence found:

Recovered 1" iron pipe with 2" brass cap, also a 1" iron pipe along side. Monument recovered in good condition. Cap stamped:  
Recovered OBT - Jack Pine 8"  $S22^{\circ} N, 51.4$  links  
Tamarack 10"  $N28^{\circ} W, 62.0$  links

This is a witness corner.  
Recovered an iron pipe in shoulder of Brown firelane.  
Bearing and distances to true corner.  
RIP  
N 1/16  
S25 + S30  
T38N R9 T38N R10  
Cor. 12.0 lks  
North

Description of monument and accessories I established to perpetuate the original location of this corner.  
Bearings and distance from W.C. to BTs - Jack Pine 8"  $S27^{\circ} W, 51.4$  links  
Tamarack 10"  $N29^{\circ} W, 73.0$  links

Dated at Rhineland, Wis., this 18th day of July, 1977.

Signature: Phillip T. Hansen Title: Registered Land Surveyor Registration No. S-498  
(County Surveyor, Registered Land Surveyor, or other duly authorized official)

Office of Register of Deeds, County of Oneida  
Instrument was filed in this office for record on the 5th day of August, 1977  
at 9:00 o'clock A. M.

Doree Neugebauer  
(Register of Deeds)

By: \_\_\_\_\_ Deputy