

State of Wisconsin

County of Oneida } ss.

I Philip T. Hansen, do hereby certify that on the 6th day of January, 1978, I found evidence of the S 1/16 corner of Section 25 & 26 Township 38, North, Range 9 East, Fourth Principal Meridian, as described hereon; and that from this evidence I established a new monument and accessories as described hereon to perpetuate the original location of this corner.

Resident witnesses:

Jim Claflin  
Herb Wagoner

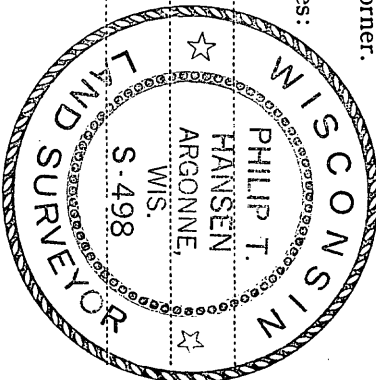

T38N R9E

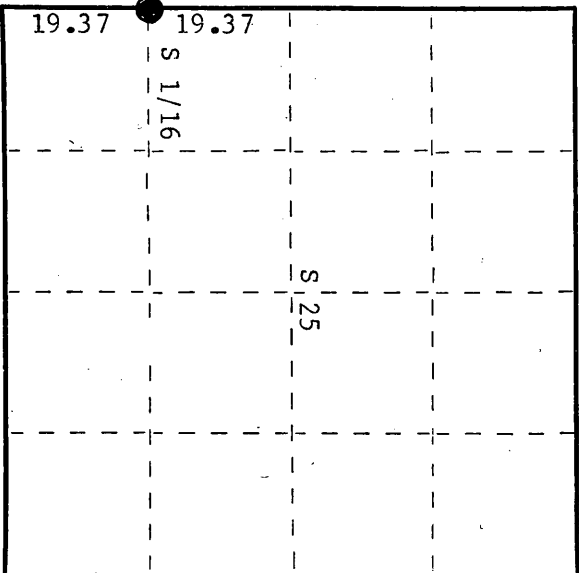

○ = Corner monument restored.

CERTIFIED LAND CORNER RESTORATION

Index No. U-21

History of original corner establishment:  
S 1/16 Corner recovered by N. Loftus, Ripco Surveyor, in 1957.  
Ran random line south bearing 176° 30' magnitude from west 1/4 corner between Sections 25 & 26, 19.37 chains to close out 33 links east of S 1/16 corner. Continued south on same bearing to close out 66 links east of Section Corners 25, 26, 35 & 36. S 1/16 corner marked with wood post. Set 1" iron pipe with 2" square brass cap.

Description of corner evidence found:

Recovered 1" iron pipe with 2" square brass cap in good condition and firmly in ground.  
Recovered point of old wood stake beside iron pipe. Cap stamped:  
Recovered OBT - White Pine 12" S62°E, 32.8 links,  
scribing partially visible.

S 1/16  
S26 + S25  
RIPCO

Description of monument and accessories I established to perpetuate the original location of this corner.  
Monument left in place as recovered.  
Monument projects 22" above ground.  
Marked NBT - White Pine 14" N17°W, 80.5 links, scribed 1/16 BT.

Dated at Rhineland, Wis., this 9th day of January, 1978.

Signature Philip T. Hansen Title Registered Land Surveyor Registration No. S-498  
(County Surveyor, Registered Land Surveyor, or other duly authorized official)

Office of Register of Deeds, County of Oneida  
Instrument was filed in this office for record on the 9th day of January, 1978  
at 2:00 o'clock P. M. I hereby certify that the within

Doris Savage Kuehn  
(Register of Deeds)

By \_\_\_\_\_ Deputy