

CERTIFIED LAND CORNER RESTORATION

Index No. V-14

State of Wisconsin } ss.  
County of Oneida

I Phillip T. Hansen, do hereby certify that on the 25th day of September, 1978, I found evidence of the W 1/16 corner of Section 27 & 34 Township 38, North, Range 9 East, Fourth Principal Meridian, as described hereon; and that from this evidence I established a new monument and accessories as described hereon to perpetuate the original location of this corner.

Resident witnesses:  
Jim Claflin  
Herb Wagoner  
John Masbaum

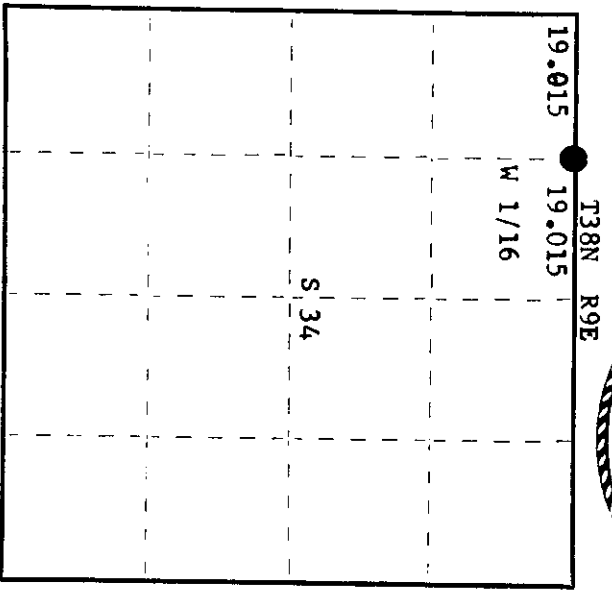
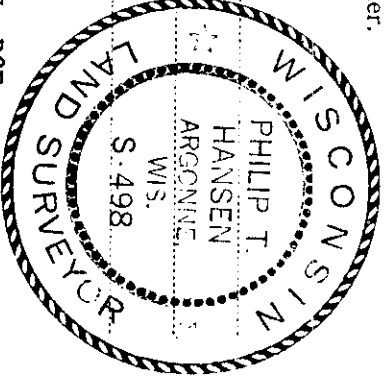

○ = Corner monument restored.

History of original corner establishment:

Corner established by N. Loftus, Ripco surveyor, in 1960. Ran random line west, S 86° 42' W from N 1/4 corner, 38.03 chains. Set section corner 27, 28, 33 and 34. Set W 1/16 corner at 19.015 chains intermediate. Set iron pin in road.

Marked NBT's -  
Black Spruce 3" south 32 links  
Black Spruce N12°E, 50 1/2 links

Description of corner evidence found:  
Recovered Ripco's 1/2" iron pin in south wheel track of Lilly Bass Road.  
Also recovered 3/4" iron pipe with 2" square brass cap due south 30 links for witness monument. Monument projects 1 ft. above ground - cap stamped:

Cor. 30 lks  
North  
S 1/27  
W 1/16 S 1/34  
RIPCO

Description of monument and accessories I established to perpetuate the original location of this corner. As corner and witness monument were recovered in good condition they were left in place as recovered.

Marked NBT's - tamarack 7" N80°E, 128.3 links  
black spruce 5" N7°E, 77.3 links, scribed 1/16 BT.

Dated at Rhinelander, Wis. this 4th day of October, 1978

Signature Phillip T. Hansen Title Registered Land Surveyor Registration No. S-498  
(County Surveyor, Registered Land Surveyor, or other duly authorized official)

Office of Registrar of Deeds, County of Oneida I hereby certify that the within instrument was filed in this office for record on the 18th day of October, 1978 at 1:50 o'clock P. M.

Doris Leverage Fisher  
(Registrar of Deeds)

By: \_\_\_\_\_ Deputy

3809270080