

U.S. PUBLIC LAND SURVEY MONUMENT RECORD

Note: This form is intended and designed to fulfill all requirements of Wisconsin Administrative Code, Chapter A-E 5.02, U.S. Public Land Survey Monument Record (3)(a)(b)(c)(d)(e)(f)(g)(h)(i). An additional sheet may be added if necessary to conform with said requirements.

(a) Corner location: Township 38 North

Range 9 East

Town/City/Village SUGAR CAMP

County ONIEDA

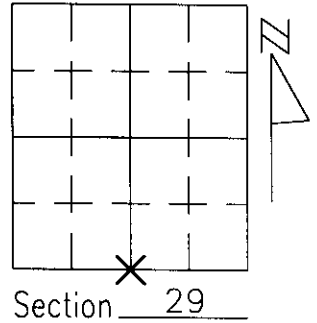

(b)(f)(g)(h) Description of monument found at this corner and if it was accepted, state all evidence (material, testimonial, occupational, plats, records, other monuments) used as a basis for accepting. If not accepted or if nothing was found, state evidence used as basis for establishing location. If reestablished through lost corner proportionate methods, indicate all monuments, distances and directions used to establish.

ORIGINAL P.L.S. SURVEY: WOOD POST WAS SET WITH A 10" WHITE PINE N85°E, 175 LKS. & 6" TAMARACK S34°W, 76 LKS. FOR BEARING TREES. NO EVIDENCE OF ORIGINAL SURVEY MONUMENTATION WAS FOUND.

I FOUND A 2" IRON PIPE WITH A SQUARE PLATE WELDED TO THE TOP SET BY RIPCO AS NOTED IN FIELD BOOKS ON FILE AT THE ONIEDA COUNTY SURVEYOR'S OFFICE. THIS PIPE FITS OCCUPATION AND USE OF THE SURROUNDING LANDS AND WAS ACCEPTED AS THE BEST EVIDENCE OF THE ORIGINAL LOCATION OF THE CORNER.

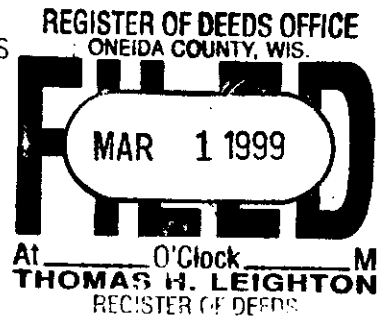

(c)(d)(e) Plan view of corner with ties to at least 4 witness monuments. If in disagreement with previously established corner, show the distances between the two corners and also indicate the ties to the disputed corner.

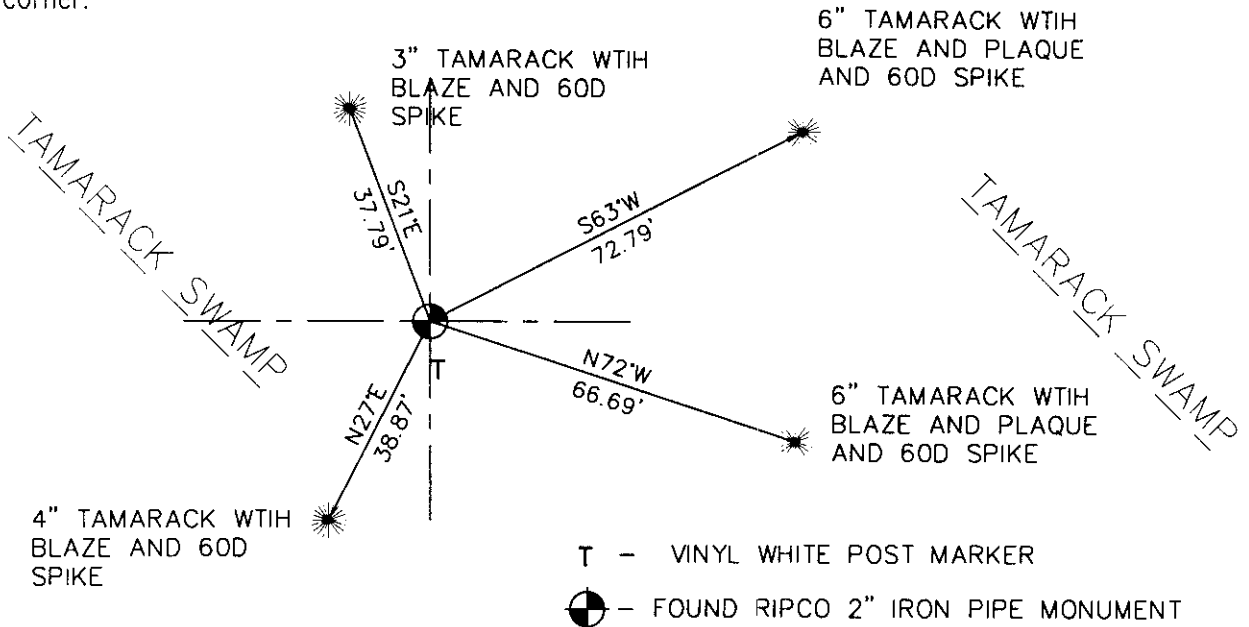

(i) I, Thomas A. Radenz, Wisconsin Registered Land Surveyor, certify that the corner location on this record was determined by me or under my direction and control and that this U.S. Public Land Survey Monument Record is correct and complete to the best of my knowledge and belief.

Signature Thomas A. Radenz

Date 2.18.99

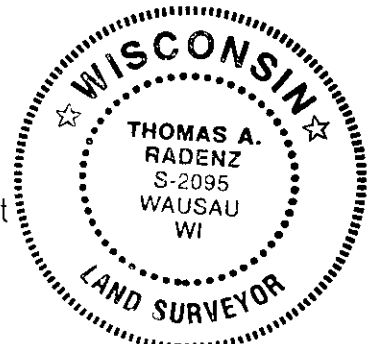

Index No. V 7
3809290020